

Caption: Measured drawing and elevations of Barn 1 at No. 20-22 Buckingham Street, Pitt Town
Copyright Owner: Graham Edds & Associates
Date: May 2023

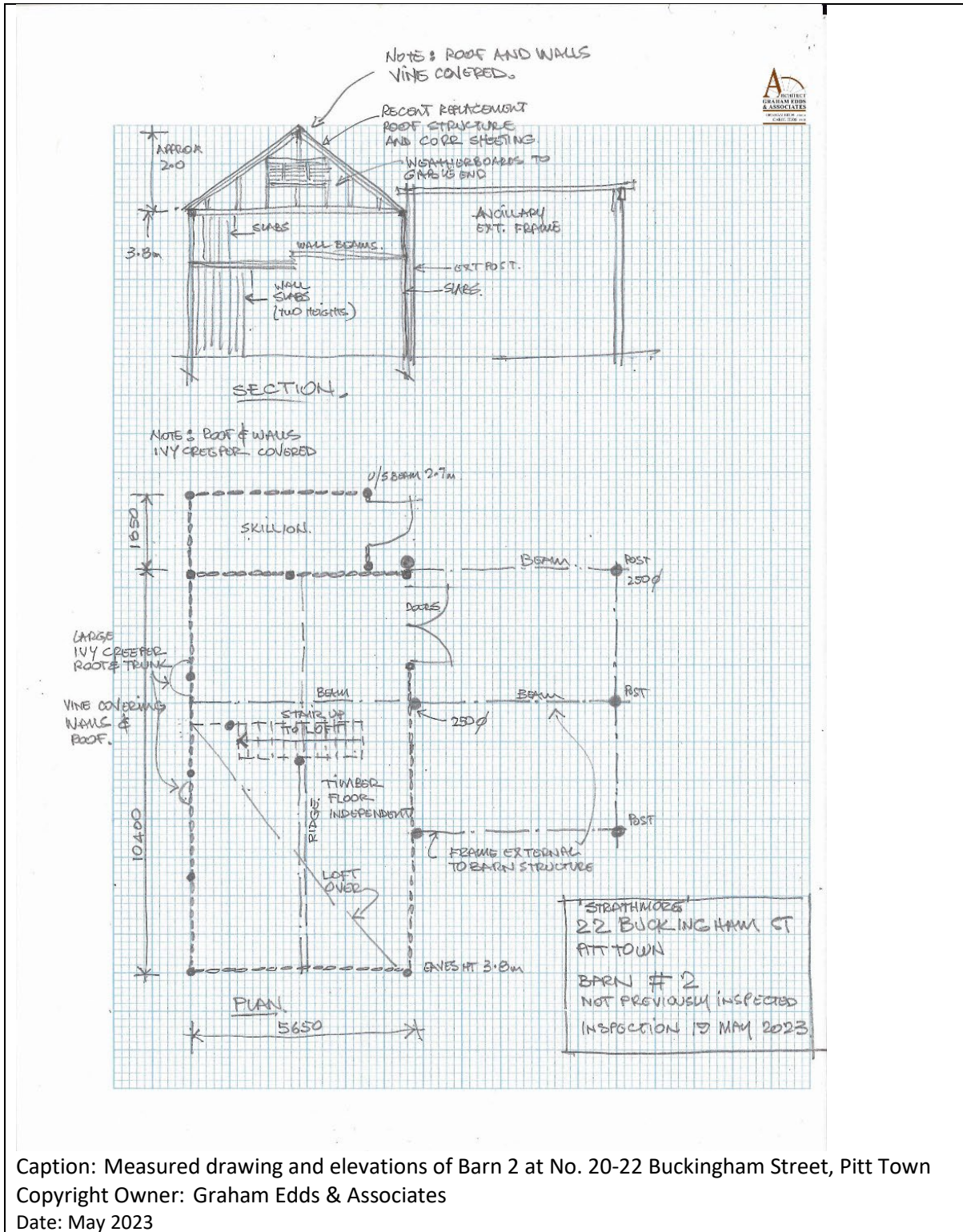

Caption: Measured drawing and elevations of Barn 2 at No. 20-22 Buckingham Street, Pitt Town
 Copyright Owner: Graham Edds & Associates
 Date: May 2023

ITEM DETAILS	
NAME	Single Storey Town Barn with Skillion and Mezzanine
ADDRESS	26A Buckingham Street, Pitt Town
LOCAL GOVT AREA	Hawkesbury
PARISH	Pitt Town
LOT/DP	Lot 1 DP 1180284
SHI No.	1743106
EXISTING HERITAGE ITEM?	Yes- Item I292 (Heritage Item No. 1740016- listed as 26 Buckingham Street, Pitt Town)
RECOMMENDED MANAGEMENT	
MANAGEMENT SUMMARY	Recommend for State heritage listing
	Retain local heritage listing
ITEM CLASSIFICATION	
ITEM TYPE	Built
ITEM GROUP	Farming and Grazing
ITEM CATEGORY	Barn
DESCRIPTION	
CIRCA	Y
PERIOD	Late 19 th century
MODIFICATION/DATES	
CURRENT USE	Vacant
FORMER USE	Barn
LOCATION ON SITE:	Close to street frontage on otherwise vacant site on north-western fringe of Pitt Town.
DESCRIPTION	
MAIN BARN STRUCTURE	Large single-storey barn 12 x 6.5m on plan with round posts up to eaves level (4.8m high) mortised and tenoned to square longitudinal beams, with round cross beams. Condition: Moderate Date: late 19 th century
NO. OF BAYS	Four
ROOF STRUCTURE	Round rafters at close centres with sawn battens for iron and diagonal wind bracing. Condition: Moderate Date: late 19 th century
LOFT	Loft in skillion only supported on round beams let into sides of posts with dovetail joints. Condition: Date:
SKILLION 1	Side skillion along eastern side of barn with loft. Wall between skillion and main barn and internal partition clad in vertical slabs with intermediate framing at upper level which probably supported horizontal spaced slats. Condition: Moderate Date: late 19 th century.
ROOF CLADDING:	Corrugated iron short sheets. Condition: Moderate Date: Mid-20 th century?

WALL CLADDING	Vertical slabs up to half height then spaced timber horizontal slats fixed to light intermediate framing. This remains intact on north elevation. Wall cladding to skillion is two levels of vertical slabs. Condition: Poor Date: Late 19 th century
OPENINGS	West side of main barn has 3 open bays with gudgeon hinges as evidence of doors. Single doors to stable and chaff room on east side of skillion.
FLOORING (GROUND)	Southern half of barn had timber ground floor. Remains are stacked in barn.
FLOORING (LOFT)	Loose timber boarding.
FLOORING (SKILLION)	Not known
INTERNAL STRUCTURE	Remains of dwarf posts, beams and joists ground floor structure.
OTHER (Fixings?)	Cross beams jointed to longitudinal beams with iron straps and bolts
CURRENT USE	Disused
CHANGES FROM 2010?	Deterioration
HISTORY	
<p>No. 26A Buckingham Street, Pitt Town is located on part of a 60 acre grant (Portion 52 Parish Pitt Town) made to John Benn, ex-convict, in 1803. Benn owned various property throughout the Hawkesbury as well as in Sydney. John Benn's real name was John Venman and following his death in c1815, a series of claims were made against his lands by his wife and relatives in England. Christopher Watkin May made a claim to the Court of Claims commissioners for 2 roods 28 perches bounded by Chatham and Buckingham Streets Pitt Town, which had been promised to his father, Lawrence May. The claim was accepted and the land was granted to Christopher Watkin May on 14 July 1862. Christopher Watkin May, Pitt Town Bottoms, farmer conveyed the land to Charles Emanuel Higgins, Pitt Town, farmer for £120 on 1 February 1879.</p> <p>No building was shown in this position on any of the Crown surveys of Pitt Town of 1828, 1848 and 1872, indicating that the barn was constructed in the late 19th century, post 1872. Aerial photographs of the 1970s show the property as semi-rural.</p>	
REFERENCES	<p><i>New South Wales Government Gazette</i>, 8 Oct 1861 p 2128 Old System Deed, No 252 Bk 189 "Law Intelligence", The Sydney Heritage, Monday 24th June 1833, p. 2</p>
STATEMENT OF SIGNIFICANCE	
<p>The town barn at No. 26A Buckingham Street, Pitt Town is of historical significance as a rare, surviving late 19th century timber framed barn of relatively high integrity. Located on a vacant allotment on the northern outskirts of Pitt Town, the barn is highly visible in the streetscape and makes a strong contribution to the historical character of Buckingham Street and Pitt Town. Located on part of a 60 acre grant made to ex-convict John Benn in 1803, the town barn is evidence of the long term agricultural of the land from the early 19th century through to the mid to late 20th century.</p> <p>As a town barn, the building would have been used in association with farm lands located outside of the town of Pitt Town, emphasising the continued importance of agriculture in the district well into the 20th century. In its overall form and configuration, it is a representative example of an historic timber framed barn type found throughout the Hawkesbury City local government area.</p> <p>The single storey barn is of technical significance for retaining evidence of its late 19th century construction date including round posts mortised and tenoned to square longitudinal beams, with round cross beams, round rafters with battens for iron and diagonal wind bracing, dovetail joints</p>	

<p>to post in loft, two levels of slabs to skillion, horizontal slats to upper level of main barn and gudgeon hinges (doors removed). Although currently not in use, the barn continues to have the potential to provide further information into late 19th century farming methods, the relationship between the town barn and other agricultural lands, as well as the continuity of use of historic agricultural buildings into the 20th century.</p>	
ASSESSED SIGNIFICANCE TYPE	State
CRITERIA A) HISTORICAL	<p>The barn at No. 26A Buckingham Street, Pitt Town is of historical significance as a surviving late 19th century town barn that provides evidence of the long-term agricultural use of the land from the late 18th century through to the 20th century.</p> <p>As a town barn, the building would have been used in association with farm lands located outside of the town of Windsor, emphasising the continued importance of agriculture in the district well into the 20th century.</p> <p><i>Meets the criterion on a State level</i></p>
CRITERIA B) HISTORICAL ASSOCIATION	<p>The town barn at No. 26A Buckingham Street, Pitt Town has some historical associations with ex convict John Benn, who received a 60 acre grant of land in 1803, on which the barn is now located; and with Charles Emanuel Higgins, who appears to have built the barn in the 1880s (or later).</p> <p><i>Meets the criterion on a Local level</i></p>
CRITERIA C) AESTHETIC/TECHNICAL	<p>Located in an undeveloped allotment, the large barn is highly visible in Buckingham Street and makes a strong contribution to the historical character of Buckingham Street and Pitt Town.</p> <p>The single storey barn is of technical significance for retaining evidence of its late 19th century construction date including round posts mortised and tenoned to square longitudinal beams, with round cross beams, round rafters with battens for iron and diagonal wind bracing, dovetail joints to post in loft, two levels of slabs to skillion, horizontal slats to upper level of main barn and gudgeon hinges (doors removed).</p> <p><i>Meets the criterion on a State level</i></p>
CRITERIA D) SOCIAL/CULTURAL	<p>The historic barns of the Hawkesbury district are appreciated by the local community and others, being symbolic of the history of the agricultural development of the region, as evidenced by the numerous exhibitions, artworks, historical tours, heritage studies and heritage listings associated with these building types.</p> <p><i>Meets the criterion on a Local level</i></p>
CRITERIA E) RESEARCH POTENTIAL	<p>The barn No. 26A Buckingham Street, Pitt Town has the potential to provide further information into late 19th century farming methods and the relationship between the town barn and other agricultural lands, as well as the continuity of use of historic agricultural buildings into the 21st century.</p> <p><i>Meets the criterion on a Local level</i></p>
CRITERIA F) RARITY	<p>As a surviving late 19th century town barn of relatively high integrity, the barn at 26A Buckingham Street, Pitt Town is considered to be rare within the context of the Hawkesbury City local government area.</p> <p><i>Meets the criterion on a State level</i></p>

<p>CRITERIA G) REPRESENTATIVE</p>	<p>The barn at No. 26A Buckingham Street, Pitt Town is representative of the long history of agricultural development within the Hawkesbury area, which commenced in the late 18th century and continues today. The basic form of the barn with gabled roof, loft, skillion and timber slab wall cladding is representative of the typical form of barn found throughout the district. <i>Meets the criterion on a Local level</i></p>
<p>INTEGRITY/INTACTNESS</p>	<p>Moderate to High</p>

IMAGES



Caption: Barn at No. 26A Buckingham Street, Pitt Town
 Photographer: S. Johnson
 Copyright Owner: Lucas Stapleton Johnson & Partners
 Date: May 2023



Caption: Barn at No. 26A Buckingham Street, Pitt Town (interior view)
 Photographer: S. Johnson
 Copyright Owner: Lucas Stapleton Johnson & Partners
 Date: May 2023

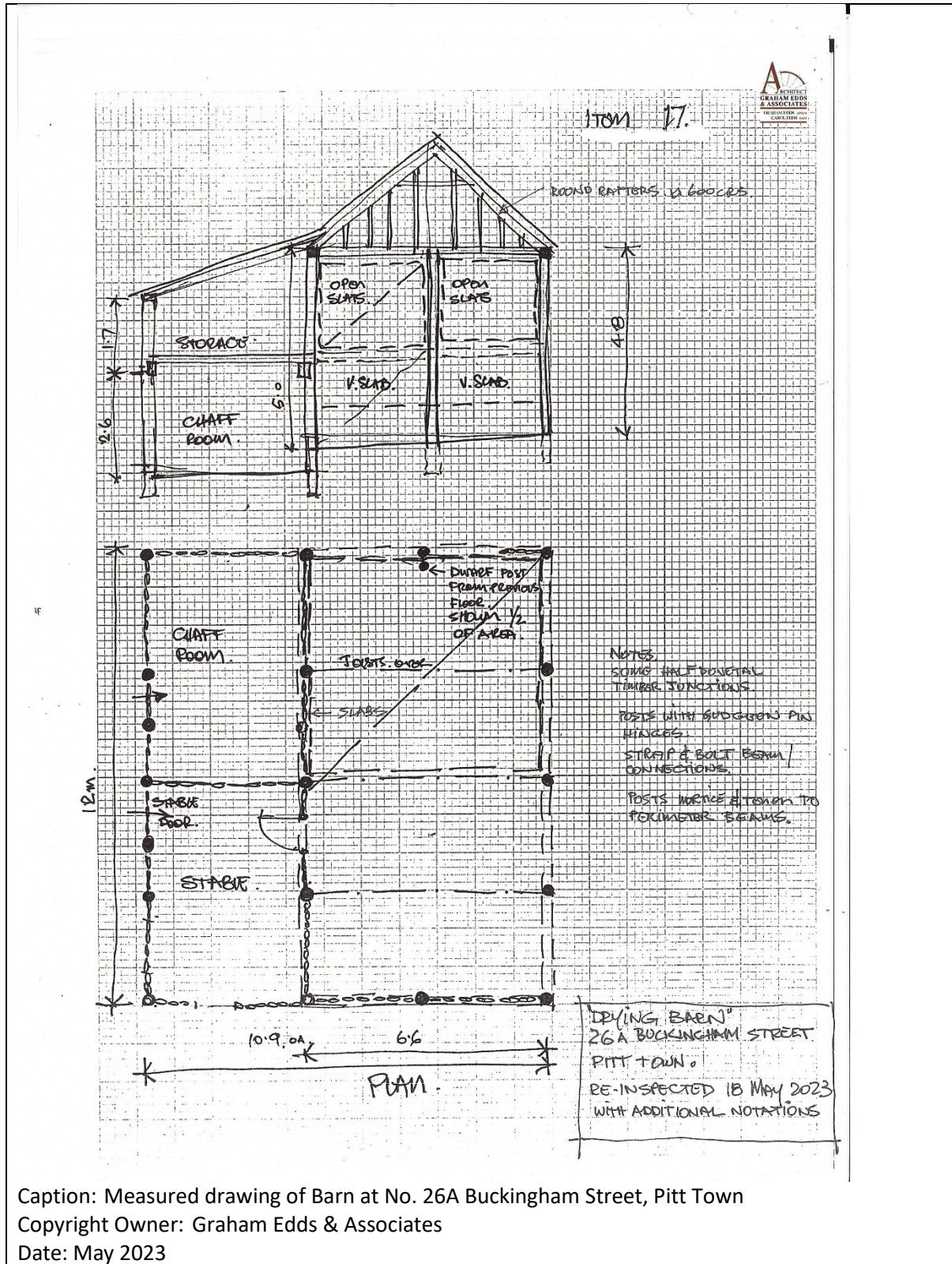

Caption: Measured drawing of Barn at No. 26A Buckingham Street, Pitt Town

Copyright Owner: Graham Eddis & Associates

Date: May 2023

ITEM DETAILS	
NAME	Single Storey Town Barn with Loft and Skillion
ADDRESS	4-8 Chatham Street, Pitt Town
LOCAL GOVT AREA	Hawkesbury
PARISH	Pitt Town
LOT/DP	Lot 1 DP 785736
SHI No.	1743104
EXISTING HERITAGE ITEM?	Yes- Item I293 (Heritage Item No. 1740017)
RECOMMENDED MANAGEMENT	
MANAGEMENT SUMMARY	Not recommended for State heritage listing. Retain as local heritage item.
ITEM CLASSIFICATION	
ITEM TYPE	Built
ITEM GROUP	Farming and Grazing
ITEM CATEGORY	Barn
DESCRIPTION	
CIRCA	Y
PERIOD	Mid 19 th century
MODIFICATION/DATES	Restored and adapted in 1990s
CURRENT USE	Garage and carport with residence/guest room (?) above
FORMER USE	Barn
LOCATION ON SITE:	Close to street at south-west corner of town allotment.
MAIN BARN STRUCTURE	Barn was not inspected internally just from the street. Condition: Good Date: Mid-19 th century with recent conservation/ renovation
NO. OF BAYS	Three
ROOF STRUCTURE	Not inspected internally. Reconstructed at approximately 35°. Condition: Good
LOFT	Not inspected Condition: Good Date: Recent
SKILLION 1	Open skillion along eastern side supported on round posts. Condition: Good Date: Mid-19 th century with recent conservation/ renovation
ROOF CLADDING:	Corrugated steel single sheets. Condition: Good Date: Recent
WALL CLADDING	Vertical timber slabs to loft floor level, weatherboards above. Condition: Good Date: Mid-19 th century with recent conservation/ renovation
OPENINGS	Double garage door at northern end, recent double doors & security grille at loft level.
FLOORING (GROUND)	Not known
FLOORING (LOFT)	Not known
FLOORING (SKILLION)	Not known
INTERNAL STRUCTURE	Not known

HISTORY	
<p>This land was shown in the name of C. Tilley on E J H Knapp's plan of 1828, with the rough outline of a building upon it. The site was further shown in the 1843 survey by J. J. Galloway with a dwelling close to the road on the northern part of the lot.</p> <p>Charles Tilley, butcher of Windsor, died on 2 January 1857, and his property passed to his son also known as Charles Tilley.</p> <p>On 10 May 1875, Charles Tilley, butcher of Windsor, sold this allotment that he had inherited from his father to Richard Owens for £14.</p> <p>The survey by surveyor E Arnheim of 1872 showed the land owned and occupied by 'R Owen' with the footprint of the existing barn close to the street alignment.</p> <p>On 21 September 1923, Albert James Owens, schoolteacher originally of Pitt Town, but then of Cranebrook, sold this allotment to James Davis for £300.</p> <p>Based on the documentary evidence, it appears that the town barn at 4-8 Chatham Street, Pitt Town was constructed pre 1872 and is associated with Charles Tilley Snr or Jnr.</p>	
REFERENCES	<p>P.628B Crown plan</p> <p>P.1.522 Crown Plan</p> <p>P.3.857 Crown plan</p> <p>Old System Deed, No 573 Bk 152</p> <p>Old System Deed, No 68 Bk 1320</p>
STATEMENT OF SIGNIFICANCE	
<p>The town barn at No. 4-8 Chatham Street, Pitt Town Catherine Street, Windsor is of historical significance as a surviving mid 19th century timber framed town barn, associated with an historic residence and shop that was owned by Charles Tilley and his son Charles Tilley, both butchers from the 1820s to the 1870s. Although restored and adapted, the town barn is considered to be rare within the Hawkesbury LGA.</p> <p>Located on the street, and together with the adjacent residence and shop, the town barn makes a strong contribution to the historical character of Pitt Town. In its overall form and configuration, it is a representative example of an historic timber framed barn type found throughout the Hawkesbury City local government area.</p> <p>The barn continues to have the potential to provide further information into mid 19th century farming methods, the relationship between the town barn and other agricultural lands, as well as the continuity of use of historic agricultural buildings into the 21st century.</p>	
ASSESSED SIGNIFICANCE TYPE	Local
CRITERIA A) HISTORICAL	The barn at No. 4-8 Chatham Street, Pitt Town is of historical significance as a surviving mid 19 th century town barn associated with an historic residence and shop, which enhances its significance. <i>Meets the criterion on a Local level.</i>
CRITERIA B) HISTORICAL ASSOCIATION	The town barn has historical associations with Charles Tilley, butcher and his son, also Charles Tilley, a butcher, who owned the property from the late 1820s through to the 1870s and it is assumed operated their butcher's shop from the property. <i>Meets the criterion on a Local level.</i>
CRITERIA C) AESTHETIC/TECHNICAL	Although restored and adapted, the town barn is located on the street frontage and together with the adjacent historic residence and shop, makes a strong contribution to the historical character of the town of Pitt Town. <i>Meets the criterion on a Local level.</i>

<p>CRITERIA D) SOCIAL/CULTURAL</p>	<p>The historic barns of the Hawkesbury district are appreciated by the local community and others, being symbolic of the history of the agricultural development of the region, as evidenced by the numerous exhibitions, artworks, historical tours, heritage studies and heritage listings associated with these building types. <i>Meets the criterion on a Local level.</i></p>
<p>CRITERIA E) RESEARCH POTENTIAL</p>	<p>The barn at No. 4-8 Chatham Street, Pitt Town, has the potential to provide further information into mid 19th century farming methods and the relationship between the town barn and other agricultural lands, as well as the continuity of use of historic agricultural buildings into the 21st century. <i>Meets the criterion on a Local level.</i></p>
<p>CRITERIA F) RARITY</p>	<p>Although restored and adapted, the barn at No. 4-8 Chatham Street, Pitt Town, is considered to be rare as a surviving town barn, within the context of the Hawkesbury City local government area. <i>Meets the criterion on a Local level.</i></p>
<p>CRITERIA G) REPRESENTATIVE</p>	<p>The town barn at No. 4-8 Chatham Street, Pitt Town is representative of the long history of agricultural development within the Hawkesbury area, which commenced in the late 18th century and continues today. The basic form of the barn with gabled roof, loft, skillion and slab wall cladding is representative of the typical form of barn found throughout the district. <i>Meets the criterion on a Local level.</i></p>
<p>INTEGRITY/INTACTNESS</p>	<p>Moderate (assumed)</p>

IMAGES



Caption: The town barn at No. 4-8 Chatham Street, Pitt Town
Photographer: S. Johnson
Copyright Owner: Lucas Stapleton Johnson & Partners
Date: May 2023



Caption: The town barn at No. 4-8 Chatham Street, Pitt Town
Photographer: S. Johnson
Copyright Owner: Lucas Stapleton Johnson & Partners
Date: May 2023

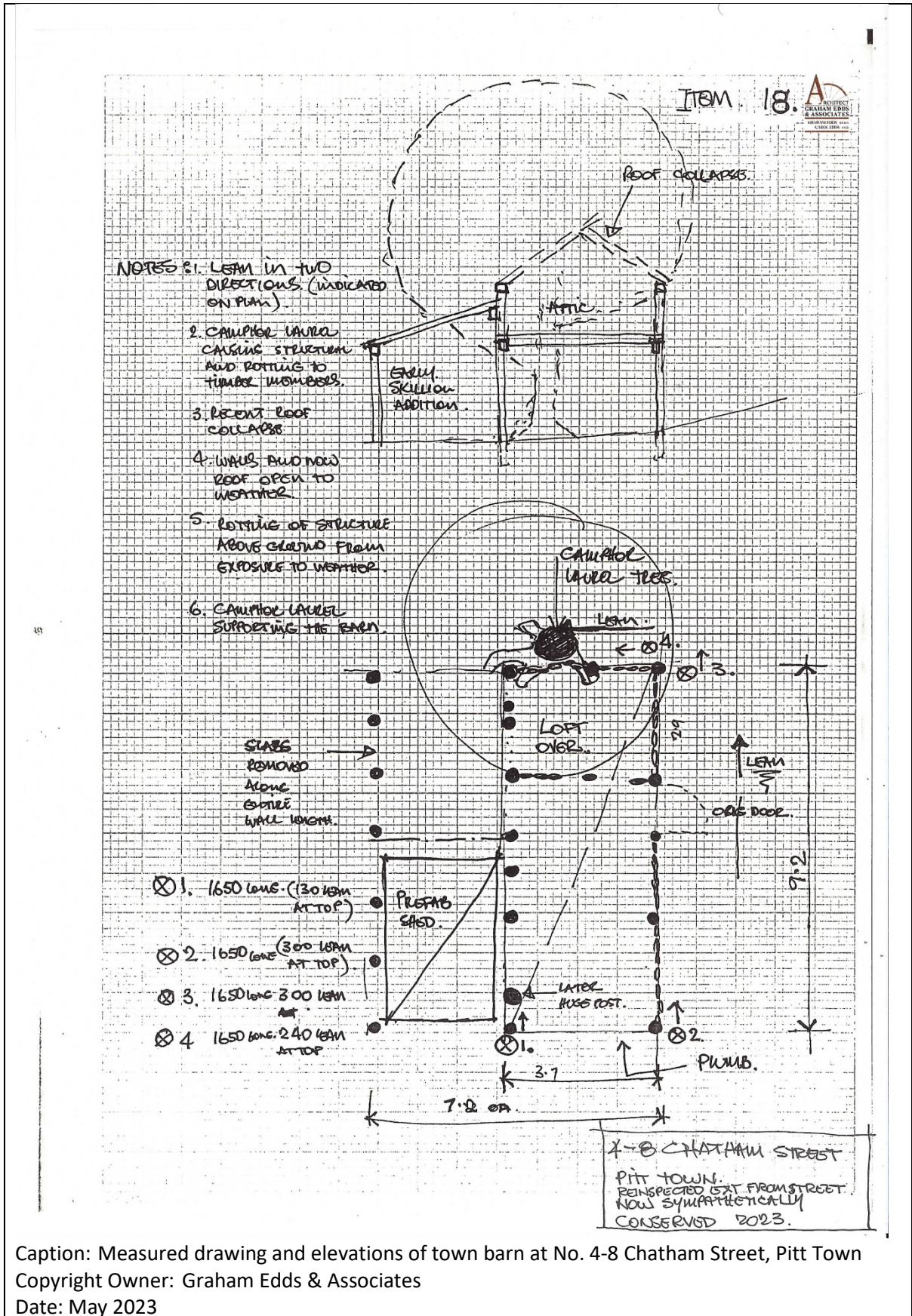

Caption: Measured drawing and elevations of town barn at No. 4-8 Chatham Street, Pitt Town
 Copyright Owner: Graham Edds & Associates
 Date: May 2023

ITEM DETAILS	
NAME	Single Storey Slab Workshop Building
OTHER/FORMER NAMES	Huxley's Blacksmith Shop (former)
ADDRESS	292 Pitt Town Road, Pitt Town
LOCAL GOVT AREA	Hawkesbury
PARISH	Pitt Town
LOT/DP	Lot 11 DP 10192
SHI No.	1743107
EXISTING HERITAGE ITEM?	Yes- Item I304 (Heritage Item No. 1740026)
RECOMMENDED MANAGEMENT	
MANAGEMENT SUMMARY	Not recommended for State heritage listing Retain as local heritage item
ITEM CLASSIFICATION	
ITEM TYPE	Built
ITEM GROUP	Farming and Grazing
ITEM CATEGORY	Blacksmithy
DESCRIPTION	
CIRCA	Y
PERIOD	Late 19 th century
CURRENT USE	Vacant
FORMER USE	Blacksmith shop
LOCATION ON SITE:	Alongside the main road to Pitt Town and approximately 1.3km to the south of the town centre.
DESCRIPTION FORMER BLACKSMITHS SHOP	
MAIN STRUCTURE	Mixture of round and square posts support longitudinal square beams (eastern beam reinforced with round beam under). Many posts are missing, fallen or dislodged. Condition: Poor – western and southern sides are structurally unstable. Date: late 19 th century
NO. OF BAYS	Six
ROOF STRUCTURE	Roof pitch is approximately 30°. Sawn rafters (smoke blackened) at close centres with widely spaced battens for iron. Condition: Poor Date: late 19 th century
LOFT	N/A
SKILLION 1	Eastern skillion is still intact with some remaining slabs and a vertical storage rack formed between two closely spaced posts halfway along the building. Condition: Poor Date: late 19 th century
SKILLION 2	Western skillion is dilapidated almost to the point of collapse but retains some evidence of early detailing in post and beam joints Condition: Poor Date: post and beam
ROOF CLADDING:	Corrugated iron Condition: Poor Date: Unknown

WALL CLADDING	Approximately 25% remnant vertical timber slabs remain in situ. The rest of the wall cladding is vertical corrugated iron. Condition: Poor Date: late 19 th century
OPENINGS	Doors on all sides
FLOORING (GROUND)	Concrete slab
FLOORING (LOFT)	N/A
FLOORING (SKILLION)	Concrete slab
INTERNAL STRUCTURE	Remains of bench and internal water trough for quenching iron.
OTHER (Fixings?)	Raised brick hearth still exists in south-east corner and some blacksmith tackle, a storage rack, iron tools, a vice, chains, etc.
CURRENT USE	Disused and unsafe.
CHANGES FROM 2010?	Deterioration.
HISTORY	
<p>History drawn from Inventory Sheet (Item No. I304, Heritage Item No. 1740026)</p> <p>No. 292 Pitt Town Road, Pitt Town is located on part of a 125 acre grant (Portion 74, Parish Pitt Town) made to John Palmer, Commissary of NSW in 1804 and a 280 acre grant (Portion 56, Parish Pitt Town) made to Thomas Biggers, ex-convict and overseer for Palmer, in 1804.</p> <p>This land had been acquired by John McDonald by 1825, and after his death in 1874, it passed to his devisees who held it for many years. The whole of the McDonald Estate was subdivided and put up for auction on 24 March 1920. A "House or blacksmith's shop" was shown on lot 11 on the auction plan.</p> <p>Lot 11 was transferred to William John Huxley, blacksmith on 15 June 1922 and he held it until it passed to his devisees in 1968 after his death.</p> <p>Although purchased by William, the property had been tenanted by his parents Samuel and Sarah Huxley from the 1880s and where Samuel Huxley operated his blacksmithy. His brother Thomas Huxley was a coach and buggy builder with shops in Richmond and Windsor. William continued in the family business.</p> <p>The building was sketched in the late 20th century and appears in the publication <i>Pitt Town and thereabouts, 1950-1974</i> by Gifford Eardley.</p>	
REFERENCES	<p>RPA 7988; C T 1090 f 221; C T 3355 f 52; Sands, Directory, 1901, p 823; DP 57988; Subdivision Plans ML, R8/42.1</p> <p>Obituary: Sarah Huxley, <i>Windsor and Richmond Gazette</i>, Friday 16th July 1920, p 4</p> <p>Advertising, <i>Windsor and Richmond Gazette</i>, Saturday 4 June 1890, p. 2</p> <p>Article: Death of Mr. Samuel Huxley, <i>Nepean Times</i>, Saturday 23rd September 1922, p. 1</p>
STATEMENT OF SIGNIFICANCE	
<p>The former blacksmith workshop and house at No. 292 Pitt Town, Pitt Town is of historical significance as a rare, surviving late 19th century blacksmithy that provides evidence of the long term agricultural use of the land first granted in 1804. The timber framed, slab building is associated with Samuel Huxley who established the blacksmith business in the 1880s and his son William Huxley who continued on into the 20th century.</p> <p>Located close to Pitt Town Road, the former blacksmiths and house, although now dilapidated, was once a notable building appearing in the publication <i>Pitt Town and thereabouts, 1950-1974</i> by Gifford Eardley and it continues to make a strong contribution to the historical character of the</p>	

<p>agricultural landscape on the outskirts of Pitt Town. As a surviving late 19th century slab blacksmith workshop and former house, the building is of technical significance and may contain objects and fittings of note associated with the historical use of the place as a blacksmithy.</p>	
ASSESSED SIGNIFICANCE TYPE	Local
CRITERIA A) HISTORICAL	<p>The former blacksmiths workshop and house at No. 292 Pitt Town Road, Pitt Town Bottoms is of historical significance as a surviving late 19th century blacksmithy and as evidence of the long-term agricultural use of the land, associated with two large early grants made to John Palmer, Commissary of NSW in 1804 and Thomas Biggers, ex-convict and overseer for Palmer, in 1804.</p> <p><i>Meets the criterion on a Local level.</i></p>
CRITERIA B) HISTORICAL ASSOCIATION	<p>The building has historical associations with the Samuel Huxley, who established the blacksmiths (together with a house) on the property in the 1880s and his son William Huxley who continued on with the business and held the property until the late 20th century.</p> <p><i>Meets the criterion on a Local level.</i></p>
CRITERIA C) AESTHETIC/TECHNICAL	<p>Located close to Pitt Town Road, the former blacksmith building, although now dilapidated, was once a notable building appearing in the publication Pitt Town and thereabouts, 1950-1974 by Gifford Eardley and it continues to make a strong contribution to the historical character of the agricultural landscape on the outskirts of Pitt Town.</p> <p>As a surviving late 19th century slab blacksmith workshop and former house, the building is of technical significance and may contain objects and fittings of note associated with the historical use of the place as a blacksmithy.</p> <p><i>Meets the criterion on a Local level.</i></p>
CRITERIA D) SOCIAL/CULTURAL	<p>The historic slab buildings of the Hawkesbury district are appreciated by the local community and others, being symbolic of the history of the agricultural development of the region, as evidenced by the numerous exhibitions, artworks, historical tours, heritage studies and heritage listings associated with these building types.</p> <p><i>Meets the criterion on a Local level.</i></p>
CRITERIA E) RESEARCH POTENTIAL	<p>As a surviving late 19th century slab blacksmith workshop and former house, the building has the potential to provide further information into late 19th century blacksmithing techniques.</p> <p><i>Meets the criterion on a Local level.</i></p>
CRITERIA F) RARITY	<p>The building at No. 292 Pitt Town Road, Pitt Town is rare within the context of the Hawkesbury City local government area, as a surviving late 19th century timber slab blacksmith workshop and house.</p> <p><i>Meets the criterion on a Local level.</i></p>
CRITERIA G) REPRESENTATIVE	<p>The timber framed and slab clad former workshop building at No. 272 Pitt Town Road, Pitt Town is representative of the long history of agricultural development within the floodplains of the Hawkesbury River, which commenced in the late 18th century and continues today.</p> <p><i>Meets the criterion on a Local level.</i></p>
INTEGRITY/INTACTNESS	Moderate to Little

IMAGES



Caption: Former blacksmith workshop and house at No. 292 Pitt Town Road, Pitt Town (exterior)
Photographer: S. Johnson
Copyright Owner: Lucas Stapleton Johnson & Partners
Date: May 2023



Caption: Former blacksmith workshop and house at No. 292 Pitt Town Road, Pitt Town (exterior)
Photographer: S. Johnson
Copyright Owner: Lucas Stapleton Johnson & Partners
Date: May 2023



Caption: Brick hearth inside former blacksmith workshop at No. 292 Pitt Town Road, Pitt Town
Photographer: S. Johnson
Copyright Owner: Lucas Stapleton Johnson & Partners
Date: May 2023

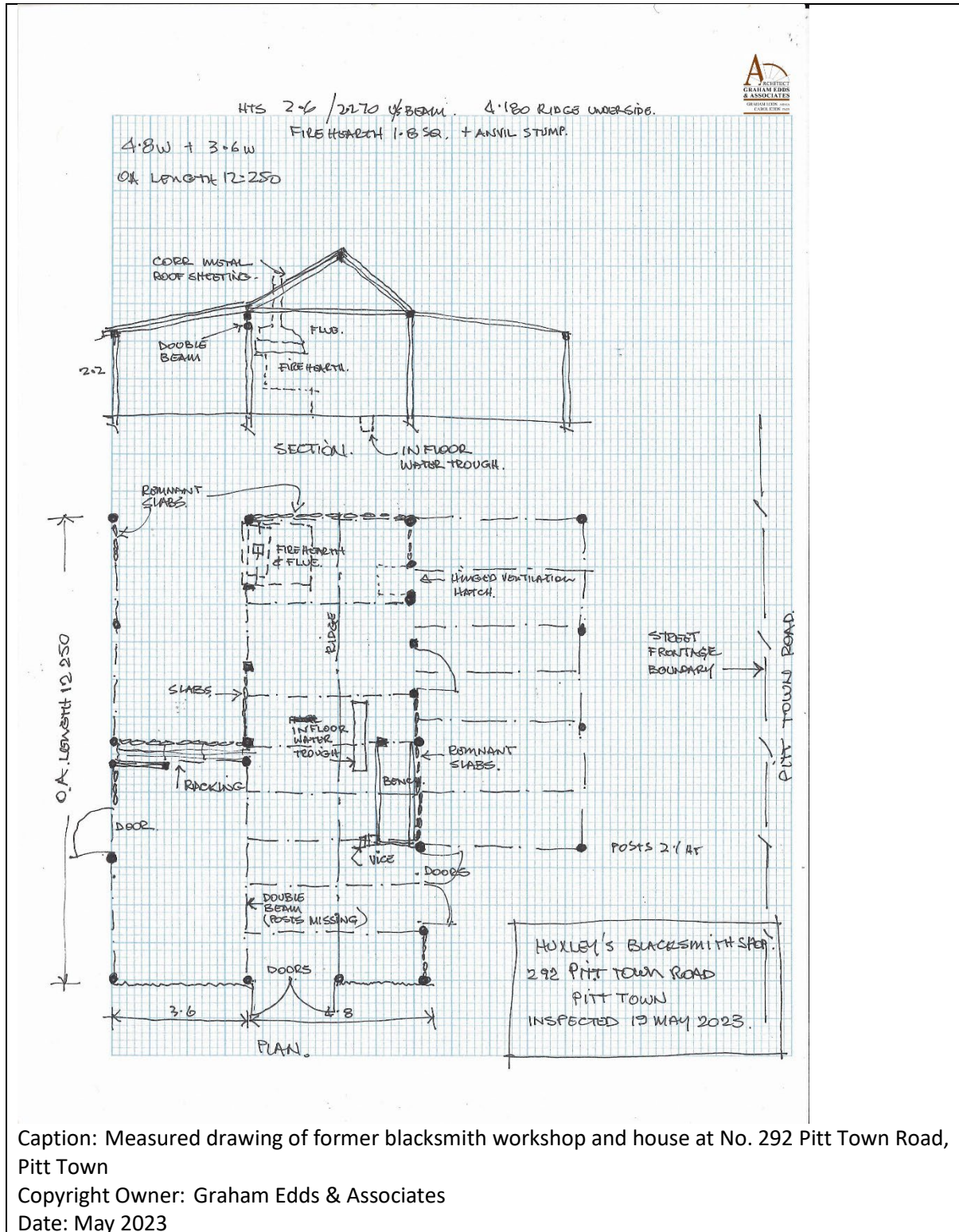

Caption: Measured drawing of former blacksmith workshop and house at No. 292 Pitt Town Road, Pitt Town

Copyright Owner: Graham Eddis & Associates

Date: May 2023

ITEM DETAILS	
NAME	Single Storey Slab Barn with Loft- Demolished
OTHER/FORMER NAMES	-
ADDRESS	163 Pitt Town Bottoms Road, Pitt Town Bottoms
LOCAL GOVT AREA	Hawkesbury
PARISH	Pitt Town
LOT/DP	Lot 1 DP 1014860
SHI No.	1743090
EXISTING HERITAGE ITEM?	N
RECOMMENDED MANAGEMENT	
MANAGEMENT SUMMARY	Not recommended for State or local listing
ITEM CLASSIFICATION	
ITEM TYPE	Built
ITEM GROUP	Farming and Grazing
ITEM CATEGORY	Barn
DESCRIPTION	
CIRCA	Y
PERIOD	Late 18 th to mid 19 th century
MODIFICATION/DATES	1991-2009 The owners advised that during a wind storm approximately 15 years ago the roof blew off. He has placed sheet metal over the former loft floor to provide some weather protection and the barn is still in use [2009 inventory sheet]
CURRENT USE	N/A- Demolished
FORMER USE	Barn
INTEGRITY/INTACTNESS	Demolished
<p>2023: Barn has been demolished</p> <p>[2010 inventory sheet]</p> <p>The physical description below is an extract from the 'Pitt Town Slab Barn Study', 1991, by Graham Edds and Associates. This 2009 study has recorded changes/deterioration within the modification date field.</p> <p>Description 1991:</p> <p>Single storey slab barn with loft having external door. Enclosed on three sides with later skillion additions using original slabs to loft floor level. Horizontal splayed boarding above slabs and at gable ends. Central area of barn 9.5m x 5.2m. The main roof is gabled clad with corrugated iron. Located on land below the 1 in 100 year floor level.</p> <p>Structure:</p> <p>Post and beam with posts set into ground extending into loft space with second top plate providing framework for roof structure. Timber rounds used exclusively. For post structure, loft joists and roof frame. Posts set in ground with spacing generally 1.5m</p>	
HISTORY	
<p>James Ruse (first emancipist to be granted land, known as Experiment Farm Cottage, Harris Park) was granted 30 acres on the east side of the River Hawkesbury in the district of Mulgrave Place to be known as Ruse Farm on 3 November 1794. On 19 March 1798, James Ruse conveyed Ruse Farm to John Stogdell for £300.</p> <p>Judge Advocate David Collins claimed in his history of the early years of the colony that Ruse sold his farm for £40. The legal deed, which Collins himself registered as the Judge Advocate, showed that this was incorrect. Jan Barkley-Jack has argued that Collins libelled Ruse and his neighbour Charles Williams as examples of the unreliability of ex-convict settlers.</p> <p>The history of Ruse's grant is complicated by gaps in the registered legal title but the following has been compiled from reliable sources.</p>	

By 1814, John Palmer was the owner of Ruse Farm. On 9 August 1814, John Palmer, of Parramatta, esquire conveyed various parcels of land for £14,489/12/0 to William Fairley, Allan Gilmore, John Hutchinson and David Clarke, all of Calcutta Fort, Province of Bengal, East India, merchants and partners in Fairley Gilmore & Co and John Gilmore and William Wilson, partners in the firms of John Gilmore and Co. Ruse's 30 acre farm was one of the properties. On 13 October 1814, those partners conveyed several parcels of land to John Benn, of Pitt Town, settler including Ruse's 30 acres. Benn leased part of the farm to Thomas Gilberthorpe, settler of Pitt Town including Ruse's farm on 4 September 1815 from 1 January 1816 for 14 years at £200 per annum. The lease included 'the House, Houses, Out buildings & Buildings, Barns Erections, Fences, Fixtures, Rights common rights and appurtenances of every kind'.

An auction of land was advertised for 13 September 1817 to be held by the Provost Marshall, in the case of Roberts versus the administrator of Benn. It included 30 acres, Ruse Farm. A later advertisement appeared on 21 August 1819 offering farms for sale by Mr Bevan for Richard Jones as agent for the heir of the late John Benn including 30 acres granted to James Ruse.

By 1829, John Venman held Ruse's grant as the brother and heir of William Venman, also known as John Benn. On 6 June 1829, he conveyed Ruse's Farm to a trustee for the benefit of John Perkins and his wife, Mary, for £600. Years later, on 13 July 1861, John Perkins swore a statutory declaration that he had received the rents of three farms, including James Ruse's since 1830.

John Perkins, originally of Sydney, but then of Stepney Green in County Middlesex, England esquire conveyed 30 acres known as Ruse Farm plus 30 acres known as Williams Farm to John Hannabus, Pitt Town, farmer on 16 April 1861 for £3,000. John Hannabus died on 28 August 1888. On 28 October 1921, a deed of partition of the lands of John Hannabus amongst his heirs included a map showing the division of the land. It also showed existing the buildings on the property.

REFERENCES

Grants Vol 1 No 104
 Old Register Volume 1 page 30 no 143
 Jan Barkley-Jack, *Hawkesbury Settlement Revealed*, p 81
 John Benn, Lease, Mitchell Library Doc Ab 51
Sydney Gazette, 6 Sept 1817, p 2; 21 Aug 1819, p 3; 21 Aug 1819, p 3
 Old System Deed, No 261 Bk 77
 Old System Deed, No 560 No 1244

ITEM DETAILS	
NAME	Complex of Two Slab Barns with Skillions
ADDRESS	231 Pitt Town Bottoms Road, Pitt Town Bottoms
LOCAL GOVT AREA	Hawkesbury
PARISH	Pitt Town
LOT/DP	Lot 21 DP 730868
SHI No.	1743091
EXISTING HERITAGE ITEM?	Y- I461 (Heritage Item no. 1740027)
RECOMMENDED MANAGEMENT	
MANAGEMENT SUMMARY	Not recommended for State heritage listing. Retain as local heritage item.
ITEM CLASSIFICATION	
ITEM TYPE	Built
ITEM GROUP	Farming and Grazing
ITEM CATEGORY	Barn
DESCRIPTION	
CIRCA	Y
PERIOD	Barn A: Mid-19 th century but recently extensively renovated Barn B: Late-19 th early 20 th century
CURRENT USE	Barn A: Entertainment area Barn B: vacant
FORMER USE	Barns
LOCATION ON SITE:	The two barns are arranged in an L-shape to the south of the house and close to the eastern bank of the Hawkesbury River.
DESCRIPTION BARN A	
MAIN BARN STRUCTURE	Two-storey barn orientated north-south with tall side skillion to west and end skillion to south. It has been extensively repaired and regularized following three floods in two years. Round posts 5.5m high with rectangular sawn longitudinal beams let into outside of posts and loft supported on round pole joists. Condition: Good Date: Mid-19 th century but recently extensively renovated.
NO. OF BAYS	Five
ROOF STRUCTURE	Roof pitch approx. 40°. Loft not accessed. Condition: ? Date: ?
LOFT	Loft enclosed with studs and boarded stud wall to west and corrugated iron on other 3 sides. Not accessible for internal inspection. Condition: Good Date: Mid-19 th century but recently extensively renovated.
SKILLION 1	Tall skillion to eaves height of main barn. Sawn beams rest on round posts. Condition: Good Date: Mid-19 th century but recently extensively renovated.
SKILLION 2	End skillion with lower floor level. Sawn rafters supported on beam bolted to main posts. Condition: Good Date: Mid-19 th century but recently extensively renovated.

ROOF CLADDING:	Corrugated steel Condition: Good Date: Recently replaced.
WALL CLADDING	Vertical timber slabs up to loft floor level, corrugated iron above and in gables. Condition: Good Date: Mid-19 th century but recently extensively renovated
OPENINGS	Skillion open on long side, barn has opening in central bay. Loft door at north end.
FLOORING (GROUND)	Concrete slab of recent construction with attempts to seal gaps around posts to prevent rot.
FLOORING (LOFT)	Plain edged boarding
FLOORING (SKILLION)	Concrete in skillion 1, earth in skillion 2
INTERNAL STRUCTURE	None
CHANGES FROM 2010?	Secondary posts removed, slabs added to walls. External stair removed. Internal spiral stair partially built.
DESCRIPTION BARN B	
MAIN BARN STRUCTURE	Two-storey barn orientated east-west with side skillion to south. It is in an unstable structural condition following three floods in two years and was unsafe to enter. Three rows of round posts with the central row of shorter posts supporting the upper floor. Condition: Poor Date: Late 19 th early 20 th century
NO. OF BAYS	Four
ROOF STRUCTURE	Roof pitch approx. 30° sawn rafters and battens suitable for iron, wind bracing. Condition: Poor Date: Late 19 th early 20 th century
LOFT	Not accessible for internal inspection. Condition: Poor Date: Late 19 th early 20 th century
SKILLION 1	Skillion extends to eaves height of main barn. Sawn beams rest on round posts. Condition: Poor Date: Late 19 th early 20 th century
ROOF CLADDING:	Corrugated steel Condition: Poor – storm damage Date: Early 20 th century?
WALL CLADDING	Corrugated iron Condition: Poor Date: Late 19 th early 20 th century
OPENINGS	One opening on north side
FLOORING (GROUND)	Concrete slab to northern half of main barn, remainder is earthen.
FLOORING (LOFT)	Irregular unfixed timbers including round poles
FLOORING (SKILLION)	Earthen
INTERNAL STRUCTURE	Short posts supporting mid-span of upper floor.
CURRENT USE	Disused.
CHANGES FROM 2010?	Storm and flood damage.

HISTORY	
<p>William Snailham, ex-convict, was granted 30 acres (Portion 30, Parish Pitt Town) in the District of Mulgrave Place bounded on the west by the River Hawkesbury on 3 November 1794. He quickly disposed of the land. In 1800, William Snailham's 30 acres was held by Anthony Fenn Kemp. It is unclear when Kemp disposed of this grant. Kemp was heavily involved in trade, but most of his efforts were directed towards Tasmania. By 1812, the grant was in the hands of Henry Kable, who leased it along with Douglas' farm and Acres' farm (the two allotments to the north of Snailham's farm) for 10 years to his son, on 1 September 1812. On 14 August 1809, Kable had previously registered the transfer of numerous Hawkesbury farms to himself. Snailham's Farm was not listed under that name, but it may have been transferred by another person.</p> <p>Henry Kable senior sold Snailham Farm of 30 acres to John Teale for £300 on 21 & 22 April 1826. John Teale of Windsor advertised the sale of Snailham's Farm of 30 acres, with a 'good dwelling-house and barn' on the land on 20 August 1831 along with 15 acres part of Acres' Farm.</p> <p>On 2 January 1832, by a deed of feoffment, John Teale sold 15 acres, the northern part of Snailham Farm, to James Rochester as well as 15 acres part of Acres' farm for £220. It was bounded by land to the south, occupied by James Wilbow, being the other half of Snailham Farm.</p> <p>By 1841, the southern half had been transferred to Henry Hudson of Windsor. Hudson had already purchased the northern half of the property in 1839, thus reuniting the original 30 acres of Snailham Farm.</p> <p>Henry Hudson died in July 1848. On 23 August 1870, his son Robert Hudson, of Sydney, yeoman conveyed all 30 acres of Snailham Farm and two separate parcels of 15 acres parts of Acres' Farm to John Johnston, Portland Head, Hawkesbury River, farmer for £1,550. On 29 February 1896, John Johnston of Pitt Town, farmer gifted those parcels of land to his son Andrew George Johnston, Pitt Town, farmer.</p> <p>Based on the physical evidence of the two existing barns, it appears that both barns were probably constructed during the period the property was owned by the Hudson family.</p>	
REFERENCES	<p>Grants Vol 1 p 112 (1) C J Baxter, <i>Musters and Lists New South Wales: and Norfolk Island 1800-1802</i>, ABGR, Sydney, 1988, Entry AB072 M C Kemp, 'A F Kemp (1773? – 1868)', <i>Australian Dictionary of Biography</i>, Vol 2, pp 39-40 Old Register, Bk 4 page 3a, No 269; Bk 5 page 192, No 927; Bk 6 page 78, No 1450 Old System Deed, No 532 Bk C <i>Sydney Gazette</i>, 20 Aug 1831 p 2 Real Property Application 17249</p>
STATEMENT OF SIGNIFICANCE	
<p>The barns at No. 231 Pitt Town Bottoms Road, Pitt Town Bottoms are of historical significance as surviving mid and late 19th century timber framed barns that are possibly associated with later landowners Henry Hudson Snr. and Jnr. They are surviving evidence of the long-term agricultural use of the land, first granted in 1794 to ex-convict William Snailham and known as Snailham's Farm.</p> <p>The two barns at No. 231 Pitt Town Bottoms Road, Pitt Town Bottoms are of aesthetic significance as large, imposing structures, visible in broad scale views of the Hawkesbury River from the opposite bank along Wilberforce Road that make a strong contribution to the historical character of the locality.</p> <p>Although extensively renovated and adapted (Barn A) and in poor condition (Barn B), both two storey barns retain evidence of their original construction dates and have the potential to provide further information into 19th century farming methods and construction techniques for</p>	

<p>agricultural buildings. In their overall forms and configurations, they are representative examples of the historic timber framed barn types found throughout the Hawkesbury City local government area.</p>	
ASSESSED SIGNIFICANCE TYPE	Local
CRITERIA A) HISTORICAL	<p>The barns at No. 231 Pitt Town Bottoms Road, Pitt Town Bottoms are of historical significance as evidence of the long-term agricultural use of the land, first granted to ex-convict William Snailham in 1794, although he quickly disposed of the land. The barns are of historical significance as surviving from the mid and late 19th century, although now altered, and appear to be associated with Henry Hudson Snr and Jnr, who owned the property in the 1840s through to 1870.</p> <p><i>Meets the criterion on a Local level.</i></p>
CRITERIA B) HISTORICAL ASSOCIATION	<p>The barns at No. 231 Pitt Town Bottoms Road, Pitt Town Bottoms are not associated with any persons of historical importance.</p> <p><i>Does not meet the criterion.</i></p>
CRITERIA C) AESTHETIC/TECHNICAL	<p>The two barns at No. 231 Pitt Town Bottoms Road, Pitt Town Bottoms are large, imposing structures, visible in broad scale views of the Hawkesbury River from the opposite bank along Wilberforce Road that make a strong contribution to the historical character of the locality.</p> <p>Both two storey barns retain evidence of their original construction dates, although both are now clad in corrugated galvanised steel and Barn A has been extensively renovated and adapted.</p> <p><i>Meets the criterion on a Local level.</i></p>
CRITERIA D) SOCIAL/CULTURAL	<p>The historic barns of the Hawkesbury district are appreciated by the local community and others, being symbolic of the history of the agricultural development of the region, as evidenced by the numerous exhibitions, artworks, historical tours, heritage studies and heritage listings associated with these building types.</p> <p><i>Meets the criterion on a Local level.</i></p>
CRITERIA E) RESEARCH POTENTIAL	<p>The forms of the barn, with skillions and lofts and retaining evidence of their mid and late 19th century construction dates have the potential to provide further information into 19th century farming methods and construction techniques for agricultural buildings.</p> <p><i>Meets the criterion on a Local level.</i></p>
CRITERIA F) RARITY	<p>The barns at No. 231 Pitt Town Bottoms Road, Pitt Town Bottoms is not considered to be rare within the context of the Hawkesbury City local government area.</p> <p><i>Does not meet the criterion.</i></p>
CRITERIA G) REPRESENTATIVE	<p>The barns at No. 231 Pitt Town Bottoms Road, Pitt Town Bottoms are representative of the long history of agricultural development within the floodplains of the Hawkesbury River, which commenced in the late 18th century and continues today.</p> <p>The basic forms of the barns with gabled roofs, skillions and lofts are representative of the typical form of barn found throughout the district.</p> <p><i>Meets the criterion on a Local level.</i></p>
INTEGRITY/INTACTNESS	<p>Barn A- extensively renovated and adapted- Moderate to Little Barn B- Moderate</p>

IMAGES



Caption: Barn A at No. 231 Pitt Town Bottoms Road, Pitt Town Bottoms (exterior)
Photographer: S. Johnson
Copyright Owner: Lucas Stapleton Johnson & Partners Pty Ltd
Date: May 2023



Caption: Barn A at No. 231 Pitt Town Bottoms Road, Pitt Town Bottoms (exterior)
Photographer: S. Johnson
Copyright Owner: Lucas Stapleton Johnson & Partners Pty Ltd
Date: May 2023



Caption: Barn A at No. 231 Pitt Town Bottoms Road, Pitt Town Bottoms (interior)
Photographer: S. Johnson
Copyright Owner: Lucas Stapleton Johnson & Partners Pty Ltd
Date: May 2023



Caption: Barn B at No. 231 Pitt Town Bottoms Road, Pitt Town Bottoms (exterior)
Photographer: S. Johnson
Copyright Owner: Lucas Stapleton Johnson & Partners Pty Ltd
Date: May 2023



Caption: Barn B at No. 231 Pitt Town Bottoms Road, Pitt Town Bottoms (interior)
Photographer: S. Johnson
Copyright Owner: Lucas Stapleton Johnson & Partners Pty Ltd
Date: May 2023

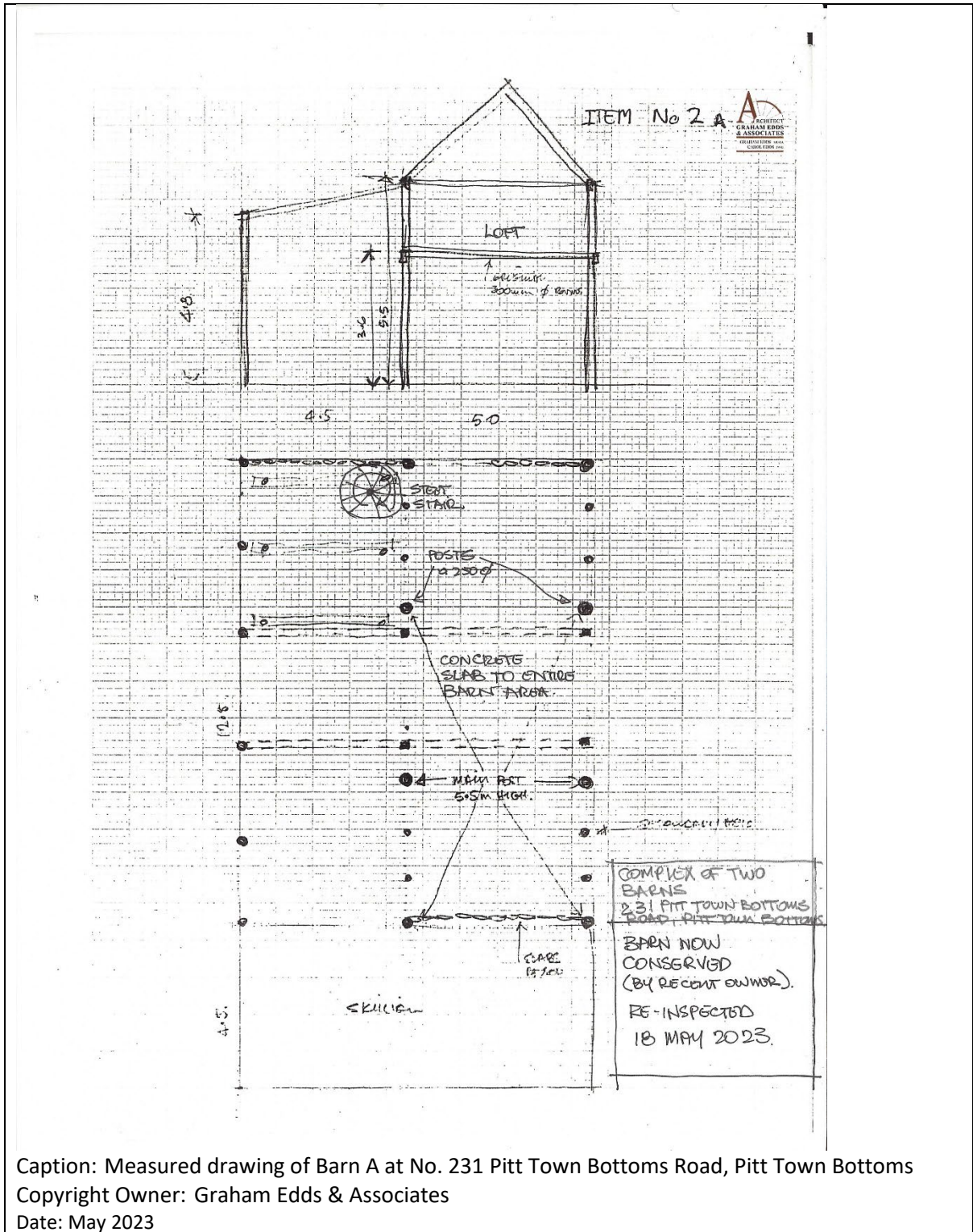

Caption: Measured drawing of Barn A at No. 231 Pitt Town Bottoms Road, Pitt Town Bottoms
Copyright Owner: Graham Eddis & Associates
Date: May 2023

ITEM DETAILS	
NAME	Single Storey Slab Barn with Loft
OTHER/FORMER NAMES	Acres Farm
ADDRESS	251 Pitt Town Bottoms Road, Pitt Town Bottoms
LOCAL GOVT AREA	Hawkesbury
PARISH	Pitt Town
LOT/DP	Lot 16 DP 776017
SHI No.	1743092/ 1740033
EXISTING HERITAGE ITEM	Yes- Item I462
RECOMMENDED MANAGEMENT	
MANAGEMENT SUMMARY	Not recommended for State heritage listing
	Retain as local heritage item
ITEM CLASSIFICATION	
ITEM TYPE	Built
ITEM GROUP	Farming and Grazing
ITEM CATEGORY	Barn
DESCRIPTION	
CIRCA	Y
PERIOD	Mid 19 th century
CURRENT USE	Storage
FORMER USE	Barn
LOCATION ON SITE	The barn is located to the south of the house and alongside the Hawkesbury River. The barn has a skillion to the east and the river on the west. Access was not granted to inspect the barn internally.
MAIN STRUCTURE	Single storey barn with loft. Single storey later skillion. Cross gable inserted facing north to light loft space.
NO. OF BAYS	Not accessed
ROOF STRUCTURE	Not accessed
LOFT	Not accessed
SKILLION 1	Not accessed
SKILLION 2	N/A
ROOF CLADDING:	Corrugated iron
WALL CLADDING	Corrugated iron. Weatherboards to gable ends.
OPENINGS	Windows to loft.
FLOORING (GROUND)	Concrete slab
FLOORING (FIRST)	N/A
FLOORING (LOFT)	Not accessed
FLOORING (SKILLION)	Not accessed
INTERNAL STRUCTURE	Not accessed
OTHER (Fixings?)	Not accessed

HISTORY

John Acres was granted 30 acres (Portion 29, Parish Pitt Town) in the district of Mulgrave Place bounded on the west by the River Hawkesbury on 3 November 1794. He also appears to have been known as Thomas Acres/Akers.

John Acres/Thomas Acres was transported for 7 years as part of the First Fleet and was emancipated in 1792.

The conveyance of a 30 acre farm from Thomas 'Akers' to Thomas Lewer for £180 was recorded on 27 May 1805. By 1810, the farm was held by Henry Kable. In 1810, 'William Henry' Kable leased Acres Farm to Miles Fieldgate, for 15 bushels of wheat per acre for 30 acres for four years. Henry Kable had previously registered the transfer of numerous farms on the Hawkesbury to him on 14 August 1809. Acres Farm was not listed under that name, but it may have been transferred by another person. In 1815, Henry Kable senior leased Acres Farm on two separate occasions to Henry Kable junior.

By a deed of feoffment of 30 April 1830, Henry Kable senior transferred 15 acres to John Teale bounded on the west by Snailham Farm now owned by John Teale, on the east by the remaining part of the 30 acres held by Henry Kable, on the north by the River Hawkesbury and on the south by a government Road for £150. The metes and bounds description is the same as appeared on the deed.

On 2 January 1832, by a deed of feoffment, John Teale transferred the 15 acres, part of Acres' Farm, to James Rochester for £220 along with 15 acres part of Snailham Farm. James Rochester conveyed those parcels to Lawrence May senior on 22 & 23 May 1832 for £265. Christopher May of Pitt Town conveyed the two parcels to Henry Hudson of Windsor on 30 & 31 January 1839 for £350.

Henry Hudson died in July 1848. On 23 August 1870, his son Robert Hudson, of Sydney, yeoman conveyed all 30 acres of Snailham Farm and two separate parcels of 15 acres parts of Acres' Farm to John Johnston, Portland Head, Hawkesbury River, farmer for £1,550. On 29 February 1896, John Johnston of Pitt Town, farmer gifted those parcels of land to his son Andrew George Johnston, Pitt Town, farmer.

It is assumed the barn was constructed by members of the May or Hudson families.

REFERENCES

- Grants Vol 1 p 109 (1)
- Old Register, Book 1 page 105 No 588
- Old Register, Bk 3 page 17, No 119
- Old Register, Bk 4 page 3a, No 269
- Old Register, Bk 6 page 78, No 1450
- Old Register, Bk 6 page 79, No 1451
- Old System Deed, No 530 Bk C
- Old System Deed, No 974 Bk D
- Old System Deed, No 723 Bk E
- Old System Deed, No 336 Bk P
- Old System Deed, No 545 Bk 121
- Old System Deed, No 768 Bk 573
- <https://convictrecords.com.au/convicts/akers/thomas>

STATEMENT OF SIGNIFICANCE

The barn at No. 251 Pitt Town Bottoms Road, Pitt Town Bottoms is of historical significance as a surviving mid 19th century timber framed barn that is associated with John Acres who first obtained the land in 1794 and Lawrence May Snr and Henry Hudson, later owners who ran the property as a horse stud.

The large single storey barn (now clad in corrugated metal) with two lofts and rear skillion, makes a strong contribution to the historical character of the agricultural lands along Pitt Town Bottoms

<p>Road and the Hawkesbury River floodplains. In its overall form and configuration, it is a representative example of an historic timber framed barn type found throughout the Hawkesbury City local government area.</p> <p>The barn is potentially of technical significance for demonstrating mid 19th century construction methods for agricultural buildings and has the potential to provide further information into 19th century farming methods.</p>	
ASSESSED SIGNIFICANCE TYPE	Local
CRITERIA A) HISTORICAL	<p>The barn at No. 251 Pitt Town Bottoms Road, Pitt Town Bottoms is of historical significance as evidence of the long-term agricultural use of the land, first granted to ex-convict John Acres (Thomas Acres) in 1794. Dating from the mid 19th century, the barn appears to be associated with either Lawrence May senior or Henry Hudson, who separately owned the property in the 1830s to 1850s and who both used the land as a horse stud.</p> <p><i>Meets the criterion on a Local level.</i></p>
CRITERIA B) HISTORICAL ASSOCIATION	<p>The barn at No. 251 Pitt Town Bottoms Road, Pitt Town Bottoms is not associated with any persons of historical importance.</p> <p><i>Does not meet the criterion.</i></p>
CRITERIA C) AESTHETIC/TECHNICAL	<p>The large single storey corrugated metal clad timber framed barn with skillions, makes a strong contribution to the historical character of the agricultural lands along Pitt Town Bottoms Road and the Hawkesbury River floodplains.</p> <p><i>Meets the criterion on a Local level.</i></p>
CRITERIA D) SOCIAL/CULTURAL	<p>The historic barns of the Hawkesbury district are appreciated by the local community and others, being symbolic of the history of the agricultural development of the region, as evidenced by the numerous exhibitions, artworks, historical tours, heritage studies and heritage listings associated with these building types.</p> <p><i>Meets the criterion on a Local level.</i></p>
CRITERIA E) RESEARCH POTENTIAL	<p>The form of the barn, with skillion and loft has the potential to provide further information into 19th century farming methods and mid 19th century construction techniques for agricultural buildings.</p> <p><i>Meets the criterion on a Local level.</i></p>
CRITERIA F) RARITY	<p>The barn at No. 251 Pitt Town Bottoms Road, Pitt Town Bottoms is not considered to be rare within the context of the Hawkesbury City local government area.</p> <p><i>Meets the criterion on a Local level.</i></p>
CRITERIA G) REPRESENTATIVE	<p>The barn at No. 251 Pitt Town Bottoms Road, Pitt Town Bottoms is representative of the long history of agricultural development within the floodplains of the Hawkesbury River, which commenced in the early 19th century and continues today.</p> <p>The basic form of the barn with gabled roof, skillion and loft is representative of the typical form of barn found throughout the district.</p> <p><i>Meets the criterion on a Local level.</i></p>
INTEGRITY/INTACTNESS	External- moderate integrity

IMAGES



Caption: Barn at No. 251 Pitt Town Bottoms Road, Pitt Town Bottoms (exterior)
Photographer: S. Johnson
Copyright Owner: Lucas Stapleton Johnson & Partners Pty Ltd
Date: May 2023



Caption: Barn at No. 251 Pitt Town Bottoms Road, Pitt Town Bottoms (exterior)
Photographer: S. Johnson
Copyright Owner: Lucas Stapleton Johnson & Partners Pty Ltd
Date: May 2023

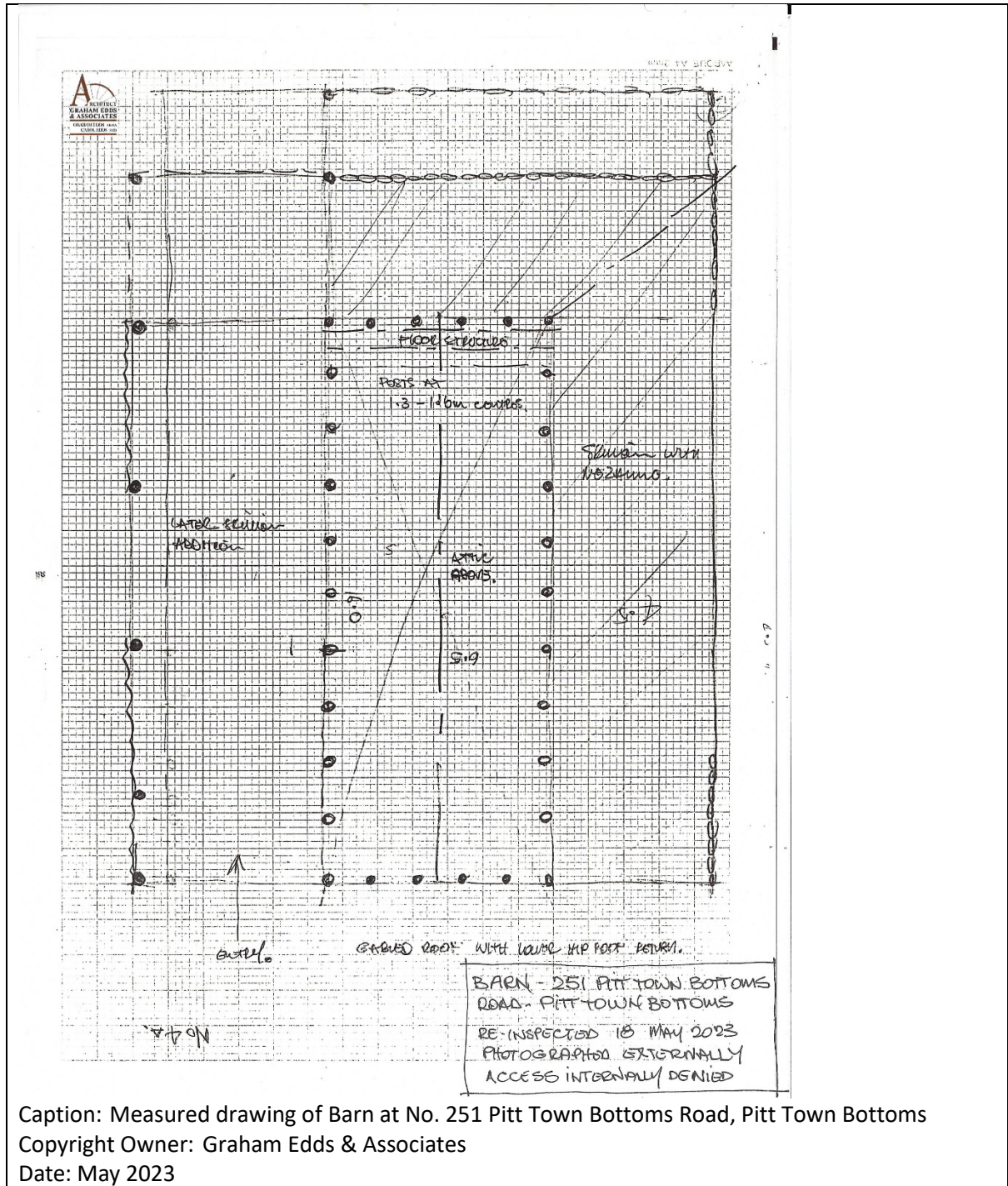

Caption: Measured drawing of Barn at No. 251 Pitt Town Bottoms Road, Pitt Town Bottoms
Copyright Owner: Graham Eddis & Associates
Date: May 2023

ITEM DETAILS	
NAME	Complex of Two Slab Barns with Lofts
OTHER/FORMER NAMES	Dad and Dave's Turf Supplies
ADDRESS	265 Pitt Town Bottoms Road, Pitt Town Bottoms
LOCAL GOVT AREA	Hawkesbury
PARISH	Pitt Town
LOT/DP	Lots 8 & 9 DP 1079633
SHI No.	1743093
EXISTING HERITAGE ITEM?	Yes- Item No. I464 (SHI No. 1743093)
RECOMMENDED MANAGEMENT	
MANAGEMENT SUMMARY	Recommend for State heritage listing- internal inspection required to clarify condition and integrity. Retain as local heritage items.
ITEM CLASSIFICATION	
ITEM TYPE	Built
ITEM GROUP	Farming and Grazing
ITEM CATEGORY	Barn
DESCRIPTION	
CIRCA	Y
PERIOD	Early 19 th century
MODIFICATION/DATES	Barns 1 & 2 were linked in 2009.
CURRENT USE	Unknown- potentially part residential
FORMER USE	Barns
LOCATION ON SITE:	Complex of two barns orientated in line north-south facing the eastern bank of the Hawkesbury River. In 2010 and 2023 access was denied to the site. The following description is based on the inspection of 1991 by Graham Edds & Associates and by viewing the site from the road and riverside.
DESCRIPTION BARN 1	
MAIN BARN STRUCTURE	Large single storey barn 16 x 6.5m on plan. Closely spaced round posts (1.3 – 1.6m centres) supporting rectangular beams to loft floor and square beams to roof eaves. Condition: not known Date: Early 19 th century
NO. OF BAYS	Ten
ROOF STRUCTURE	Gabled roof with 45° pitch and shingles under corrugated iron. Condition: not known Date: Early 19 th century
LOFT	Converted to residential use for times of flood. Condition: not known Date: Early 19 th century structure, adaptation date not known.
SKILLION 1	Western roof slope continues to form a steep skillion enclosing a mezzanine floor at the lower eaves level. Condition: not known Date: Early 19 th century
SKILLION 2	Recent shallow pitched addition Condition: not known. Date: Not known.

ROOF CLADDING:	Corrugated iron over timber shingles Condition: not known Date: Shingles early 19 th century
WALL CLADDING	Vertical timber slabs with weatherboard above and in gables. Condition: not known Date: Early 19 th century
OPENINGS	Dormer window inserted into western slope of loft roof plus windows in gable ends.
FLOORING (GROUND)	Timber floor structure indicated on 1991 plan drawing
FLOORING (LOFT)	Not known
FLOORING (SKILLION)	Not known
INTERNAL STRUCTURE	Not known
DESCRIPTION BARN 2	
MAIN BARN STRUCTURE	Single storey barn with loft 6 x 11m on plan with 3m end skillion. Closely spaced round posts (at 850mm centres) supporting rectangular beams to loft floor and roof eaves. Condition: not known Date: Early 19 th century
NO. OF BAYS	Eleven
ROOF STRUCTURE	Gabled roof with 45° pitch . Condition: not known Date: Early 19 th century
LOFT	Condition: not known Date: Early 19 th century structure, adaptation date not known.
SKILLION 1	Northern end skillion had slab walls with posts expressed on outside and slabs fixed to inside face of beam. Timber shingles remained in 2009. Condition: not known Date: Early 19 th century?
ROOF CLADDING:	Corrugated iron Condition: not known Date: not known
WALL CLADDING	Vertical slabs between posts, weatherboard above and in gables. Condition: not known Date: Early 19 th century
OPENINGS	Wide central openings in main barn for cart or carriage access. Dormer windows inserted into loft roof.
FLOORING (GROUND)	Timber floor indicated in 2009 report.
FLOORING (LOFT)	Not known
FLOORING (SKILLION)	Not known
INTERNAL STRUCTURE	Splayed boarding up to 1.8m internally.
HISTORY	
William Douglas (var. Douglass) was granted 30 acres (Portion 28, Parish Pitt Town) to be known as Douglas Farm lying on the east side of the Hawkesbury River in the District of Mulgrave Place on 3 November 1794. Today, No. 265 Pitt Town Bottoms Road is located on the whole of Portion 28 and the southern half of the adjacent land grant made to Joseph Wright, ex-convict, in 1794 (Portion 27, Parish Pitt Town).	

William Douglas was an ex-convict, having been transported for 7 years and arrived in the colony as part of the First Fleet. Douglas died in 1838.

Christopher Watkin May held this grant, which he described as being 45 acres in his will of 31 January 1899, though it was found by a later survey to be 42 acres 2 roods 3½ perches.

It is not clear when Christopher Watkin May acquired this land. He was the son of Lawrence (alt. Laurence) May who was a significant landholder in the Hawkesbury district. In June 1845, Christopher Watkin May claimed in a court case to hold five farms across the district. Lawrence May had also purchased a number of farms in the Pitt Town district. It is possible that the current property was in the hands of Lawrence May and passed to his son Christopher Watkin May after his death or that Christopher Watkin May acquired in his own right. The large scale of the barns indicates the success and prosperity of the May family.

It is known that Christopher Watkin May was the owner of a town allotment (No. 26A Buckingham Street, Pitt Town) which also contains a large barn constructed in the late 19th century, possibly during May's period of ownership (1862-1879). Town barns were often relied on during times of flood when produce, livestock and equipment could be relocated from farm-lands and safeguarded on higher ground in the towns. This approach to the management of property was formalised via colonial era policy regarding land tenure when Governor Macquarie established inseparable links between the town allotments and farming lands. Christopher Watkin May left the land to trustees in his will to divide into two equal parts, leaving the southern part to his nephew, James Alfred May.

Christopher Watkin May died on 16 July 1900 and James Alfred May died on 1 September 1949, leaving instructions as to how to divide the land amongst his relatives.

At the November 1923 assessment by the Valuer General, improvements on 15 acres, part of Portions 27 and 28, held by Mrs Florence Gertrude May were described as cottages with attics, a detached kitchen plus 'slab sheds'. This probably relates to what is now Number 265 Pitt Town Bottoms Road. The adjoining 15 acres was described as part of Portion 28 held by Joshua May were described as including clearing and fencing as well as a 'bark hut'. This appears to be what is now known as Number 259 Pitt Town Bottoms Road.

REFERENCES

Grants, Vol 1 No 108 (3)
 Australian, 7 June 1845, p 1376
 Windsor and Richmond Gazette, 7 Aug 1900, p 7
 Valuer General, Valuation cards, State Archives of New South Wales, NRS 14466, 13/7923, No 2005 & 2006

STATEMENT OF SIGNIFICANCE

The barns at No. 265 Pitt Town Bottoms Road, Pitt Town Bottoms are of historical significance as surviving early 19th century barns still located on the original land grant made to ex-convict William Douglas in 1794 and for their associations with the May family, prosperous landowners in the Pitt Town district who obtained the land in the mid 19th century and continued to reside and work the land until at least the early 20th century. Charles Watkins May, who owned the land from c1845 to 1900, also held a town allotment in Pitt Town, which also contains a large late 19th century slab barn (26A Bathurst Street, Pitt Town).

Sited in the floodplains of the Hawkesbury River, the barns are located in a small complex with weatherboard cottage and mature trees that together make a strong contribution to the historical character of the agricultural lands along Pitt Town Bottoms Road. The overall form and configuration of both barns, with corrugated metal cladding and surviving timber slabs are good, large, representative examples of the historic barn type found throughout the Hawkesbury City local government area.

Although altered and potentially adapted for residential use, both of the barns are potentially rare as surviving early 19th century slab barns that remain in use, and potentially of technical

<p>significance for retaining surviving evidence of early 19th century construction techniques including round timber posts closely spaced and shingled roofing. They also contain lofts that have been converted to residential and refuge areas during times of flood. Further research is required to determine their current condition and level of integrity, although both barns have been recorded as having high levels of integrity in 1991 and 2010</p>	
ASSESSED SIGNIFICANCE TYPE	State
CRITERIA A) HISTORICAL	<p>The barns at No. 265 Pitt Town Bottoms Road, Pitt Town Bottoms are of historical significance as evidence of the long-term agricultural use of the land, first established in 1794 by ex-convict William Douglas (var. Douglass), and as surviving, early 19th century barns still located on their original land grant.</p> <p><i>Meets the criterion on a State level.</i></p>
CRITERIA B) HISTORICAL ASSOCIATION	<p>The barns have historical associations with William Douglas, a First Fleet convict and original land grantee and with Charles Watkins May a prosperous land owner in the Pitt Town district and who owned the property from the mid 19th century until at least the early 20th century, together with an allotment above the flood plains in Pitt Town proper that still contains a mid 19th century drying barn of large scale.</p> <p><i>Meets the criterion on a Local level.</i></p>
CRITERIA C) AESTHETIC/TECHNICAL	<p>Located within a complex together with a weatherboard cottage and mature trees sited above the floodplains of the Hawkesbury River, the two corrugated metal and timber slab clad barns make a strong contribution to the historical character of the agricultural landscape along Pitt Town Bottoms Road.</p> <p>Based on previous inspections, and although altered, both barns are potentially of technical significance, retaining evidence of early construction techniques associated with agricultural buildings and timber slab construction, including closely spaced round posts and shingled roofs. One barn is considered very large, an indication of the prosperity of the owners.</p> <p><i>Meets the criterion on a Local level.</i></p>
CRITERIA D) SOCIAL/CULTURAL	<p>The historic barns of the Hawkesbury district are appreciated by the local community and others, being symbolic of the history of the agricultural development of the region, as evidenced by the numerous exhibitions, artworks, historical tours, heritage studies and heritage listings associated with these building types.</p> <p><i>Meets the criterion on a Local level.</i></p>
CRITERIA E) RESEARCH POTENTIAL	<p>The forms of the barns, with skillions and lofts and retaining evidence of 19th century construction techniques, have the potential to provide further information into 19th century farming methods.</p> <p><i>Meets the criterion on a Local level.</i></p>
CRITERIA F) RARITY	<p>The barns at No. 265 Pitt Town Bottoms Road, Pitt Town Bottoms are potentially rare within the context of the Hawkesbury City local government area, for the extent of the surviving evidence of early construction techniques and as surviving early 19th century timber slab barns that remain in use on their original 1794 land grant. One of the two being an exceptionally large barn. The historical links between 265 Pitt Town Bottoms Road and the town allotment in Pitt Town proper, which still retains its mid 19th century large scale drying</p>

	<p>barn, both being owned by Charles Watkins May, enhances the rarity of this property and the barns. <i>Meets the criterion on a State level.</i></p>
<p>CRITERIA G) REPRESENTATIVE</p>	<p>The barns at No. 265 Pitt Town Bottoms Road, Pitt Town Bottoms are representative of the long history of agricultural development within the floodplains of the Hawkesbury River, which commenced in the early 19th century and continues today. The basic forms of the barns with gabled roofs, skillions and lofts are representative of the typical form of barn found throughout the district. <i>Meets the criterion on a Local level.</i></p>
<p>INTEGRITY/INTACTNESS</p>	<p>Unknown- assumed moderate to high</p>

IMAGES

	<p>Caption: Barns at No. 265 Pitt Town Bottoms Road, Pitt Town Bottoms Photographer: C. Edds Copyright Owner: Grahams Edds & Associates Date: 2009</p>
	<p>Caption: Barn B at No. 265 Pitt Town Bottoms Road, Pitt Town Bottoms Photographer: C. Edds Copyright Owner: Grahams Edds & Associates Date: 2009</p>



Caption: Barn A at No. 265
Pitt Town Bottoms Road,
Pitt Town Bottoms
Photographer: C. Edds
Copyright Owner: Grahams Edds
& Associates
Date: 2009

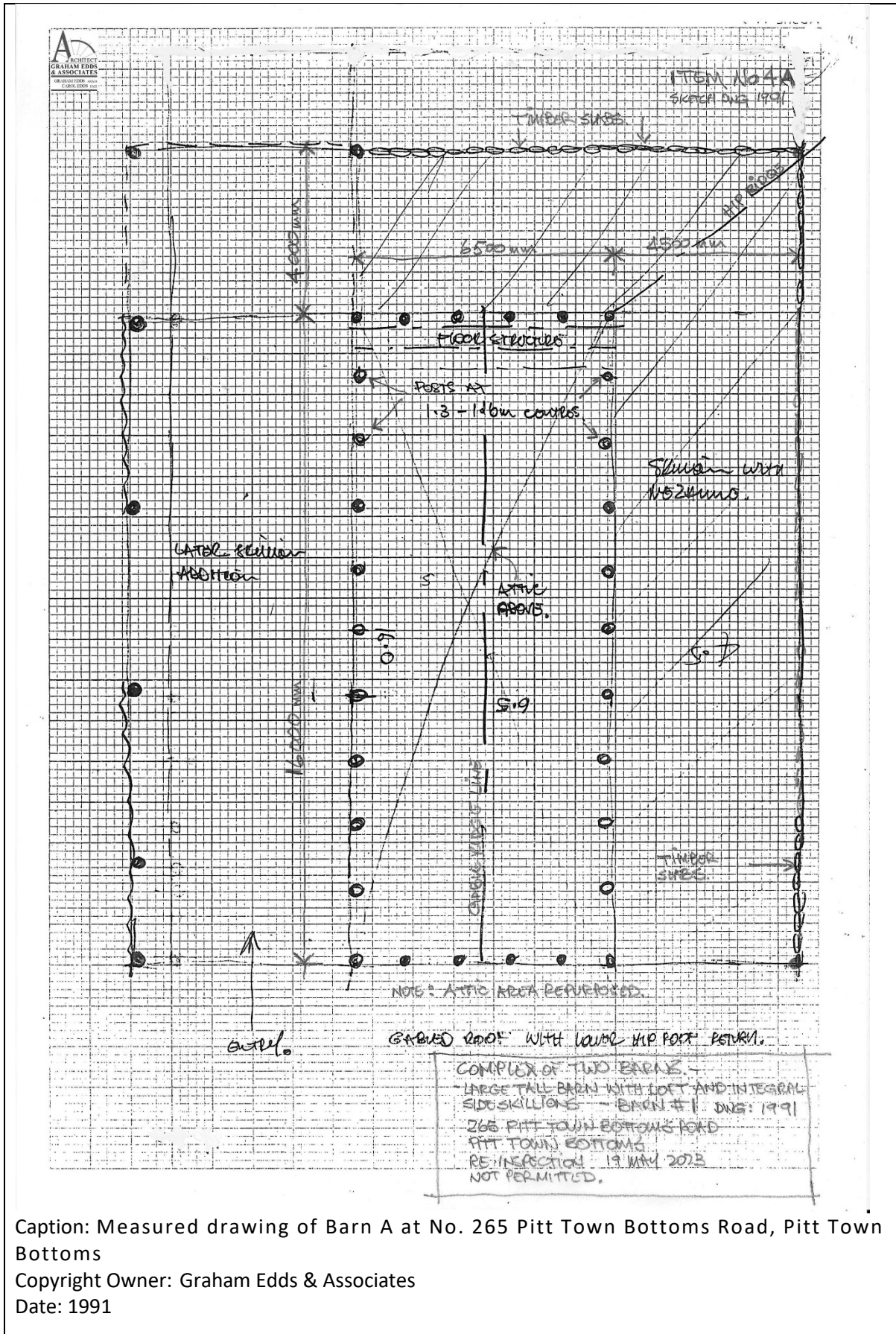

Caption: Measured drawing of Barn A at No. 265 Pitt Town Bottoms Road, Pitt Town Bottoms

Copyright Owner: Graham Edds & Associates

Date: 1991

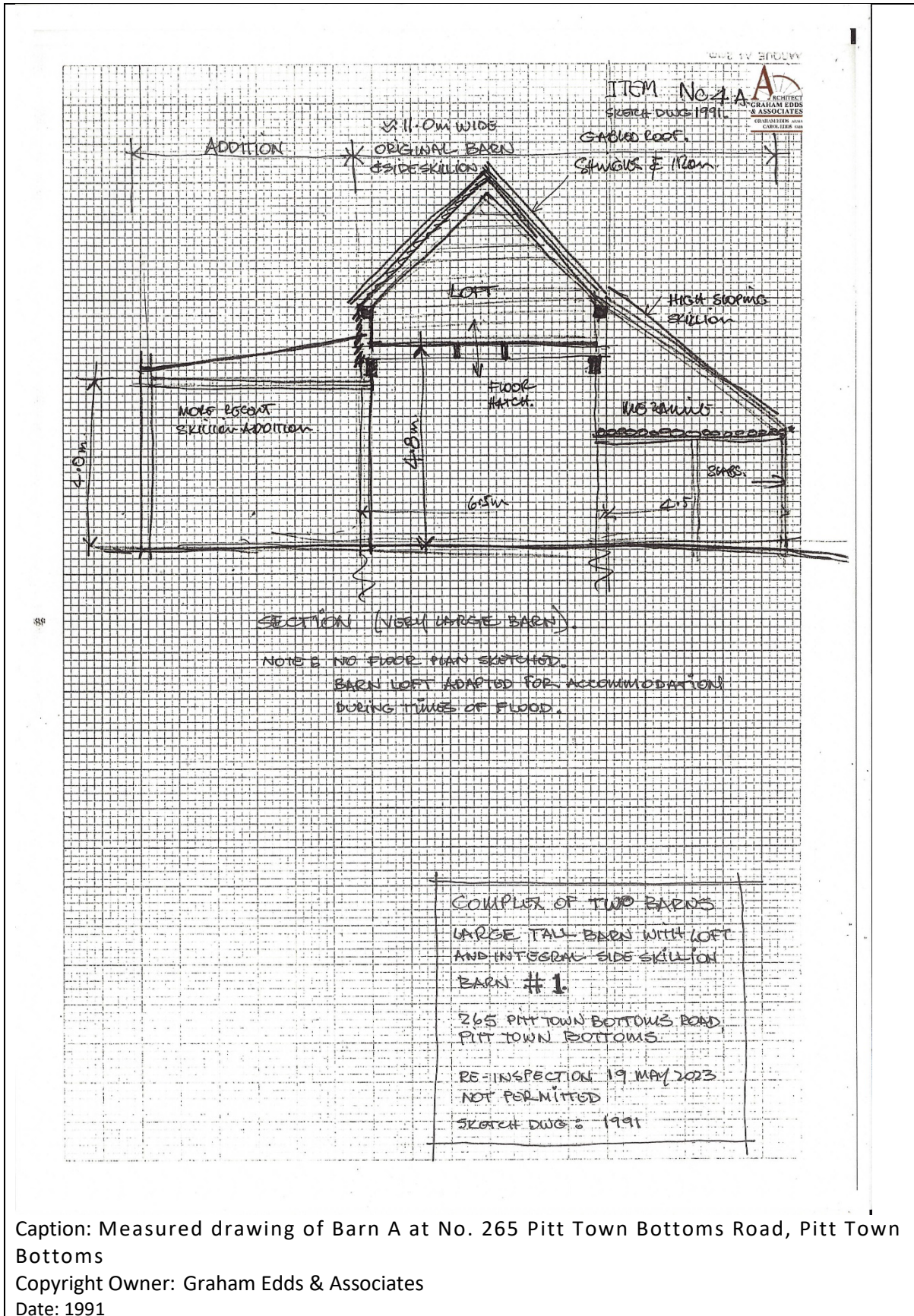

Caption: Measured drawing of Barn A at No. 265 Pitt Town Bottoms Road, Pitt Town Bottoms

Copyright Owner: Graham Eddis & Associates

Date: 1991

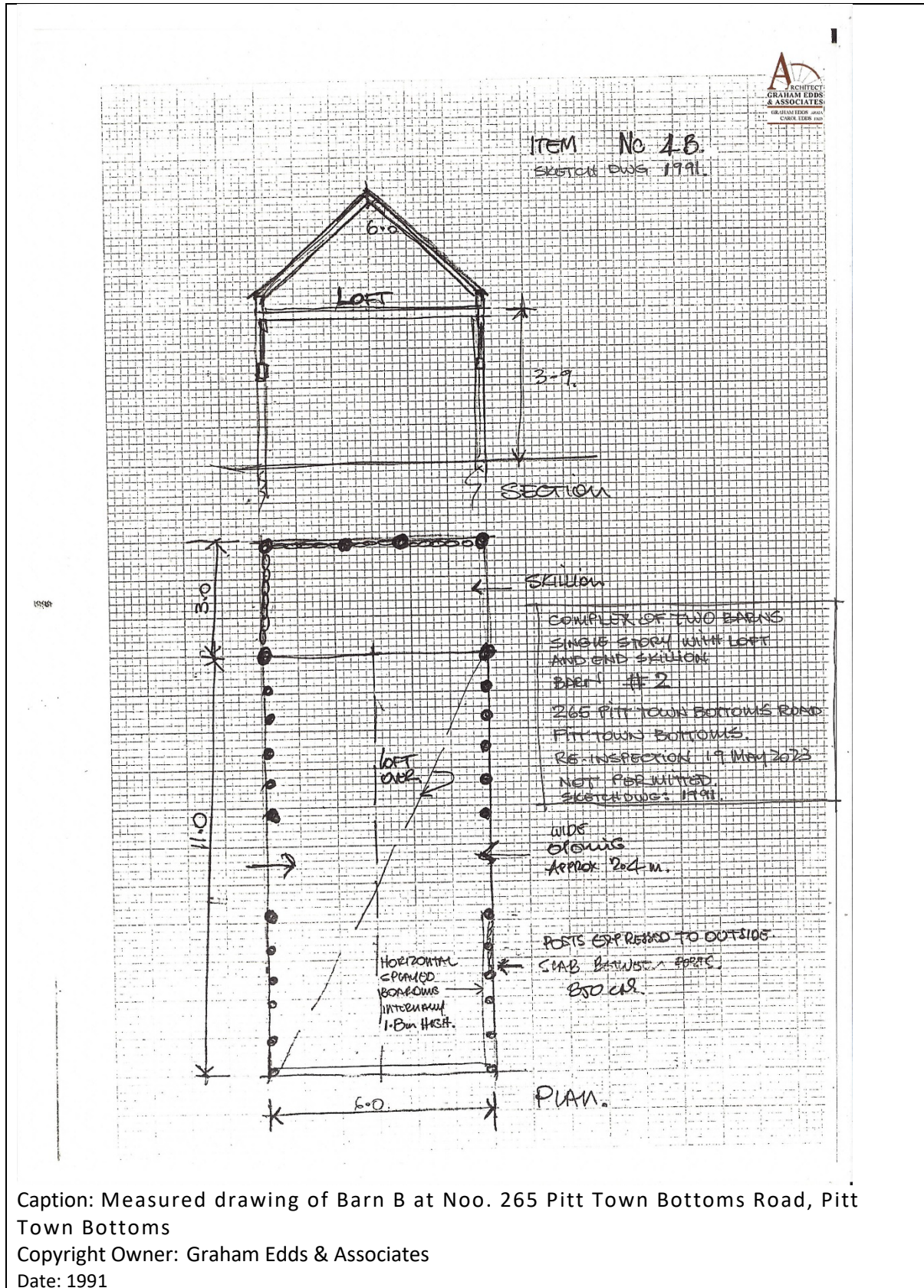

Caption: Measured drawing of Barn B at Noo. 265 Pitt Town Bottoms Road, Pitt Town Bottoms
 Copyright Owner: Graham Edds & Associates
 Date: 1991

ITEM DETAILS	
NAME	Single Storey Slab Barn with Loft and Skillion
OTHER/FORMER NAMES	-
ADDRESS	283 Pitt Town Bottoms Road, Pitt Town Bottoms
LOCAL GOVT AREA	Hawkesbury
PARISH	Pitt Town
LOT/DP	Lot 102 DP 1154658
SHI No.	1743094
EXISTING HERITAGE ITEM?	N
RECOMMENDED MANAGEMENT	
MANAGEMENT SUMMARY	Not recommended for State or local listing
ITEM CLASSIFICATION	
ITEM TYPE	Built
ITEM GROUP	Farming and Grazing
ITEM CATEGORY	Barn
DESCRIPTION	
CIRCA	Y
PERIOD	Late 18 th to mid 19 th century
FORMER USE	Barn
<p>2023: This barn has substantially collapsed. Unsalvageable and unsafe.</p> <p>The physical description below is an extract from the 'Pitt Town Slab Barn Study', 1991, by Graham Edds and Associates.</p> <p>High single storey slab barn with loft and lower level skillion on one longitudinal side. Some timber slabs remain on the lower skillion wall area and remnants of spaced slats on the opposite longitudinal wall. Horizontal boarding in dilapidated condition line the loft wall areas. Roof areas are gabled and lined with corrugated iron. External access door - no stairs remain. Independent floor structure remains at ground floor level. (Stumps and bearers). Central area of barn 12.9m x 5.5m. Probably used for drying of rural produce. Located on land below the 1 in 100 year flood level.</p> <p>Structure:</p> <p>Post in ground at 1.7m centres extending into loft for roof structure. Remains of floor at ground level. Timber rounds used exclusively for posts, floor joists and roof framework. Timber stud framing used for loft wall frame between posts and at gable end.</p>	
STATEMENT OF SIGNIFICANCE	
<p>The remains of the slab barn at 283 Pitt Town Bottoms Road is located on Portion 27 Parish Pitt Town, associated with ex-convict Joseph Wright's land grants promised in 1794. Joseph Wright was one of the signatories of the first Hawkesbury petition of December 1799 January 1800 over grain prices.</p> <p>A tall early slab barn used primarily for drying produce and associated with early farming of the Hawkesbury district. An indicator of an early barn structure previously containing a raised floor</p>	
INTEGRITY/INTACTNESS	Substantially collapsed. Unsalvageable and unsafe.

IMAGES



Caption: Barn at 283 Pitt Town Bottoms Road, Pitt Town Bottoms (exterior)
Photographer: LSJ
Copyright Owner: Lucas Stapleton Johnson & Partners Pty Ltd
Date: May 2023:



Caption: Barn at 283 Pitt Town Bottoms Road, Pitt Town Bottoms (exterior)
Photographer: LSJ
Copyright Owner: Lucas Stapleton Johnson & Partners Pty Ltd
Date: May 2023:

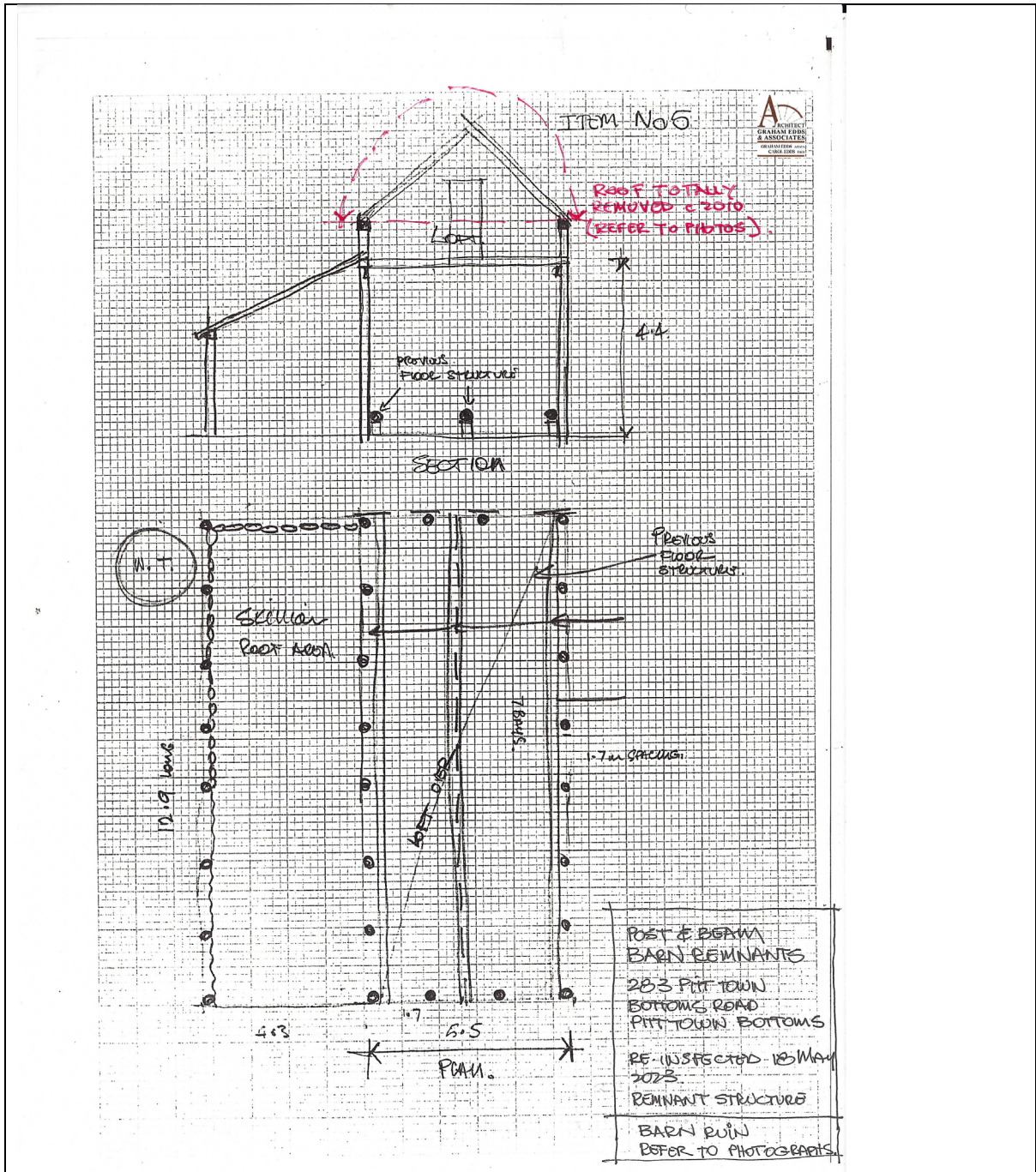

Caption: Measured drawing of Barn at 283 Pitt Town Bottoms Road, Pitt Town Bottoms

Copyright Owner: Graham Eddis & Associates

Date: May 2023

ITEM DETAILS	
NAME	Single Storey Slab Barn with Loft and End Skillion
ADDRESS	303 Pitt Town Bottoms Road, Pitt Town Bottoms
LOCAL GOVT AREA	Hawkesbury
PARISH	Pitt Town
LOT/DP	Lot 26 DP 1125833
SHI No.	1743095
EXISTING HERITAGE ITEM?	N
RECOMMENDED MANAGEMENT	
MANAGEMENT SUMMARY	Not recommended for State or local listing
ITEM CLASSIFICATION	
ITEM TYPE	Built
ITEM GROUP	Farming and Grazing
ITEM CATEGORY	Barn
DESCRIPTION	
CIRCA	Y
PERIOD	Late 18 th to mid 19 th century
CURRENT USE	?
FORMER USE	Barn
LOCATION ON SITE	The barn is further hidden behind the overgrowth recorded in 1991. This barn has not been inspected internally or fully recorded.
INTEGRITY/INTACTNESS	Unknown
<p>2023: No access provided. Unable to be viewed from public road.</p> <p>The physical description below is an extract from the 'Pitt Town Slab Barn Study', 1991, by Graham Edds and Associates.</p> <p>Description 1991: Single storey with loft. Skill ion on short side. Located on land below the 1 in 100 year flood level. Structure: Unable to obtain access to or photograph barn.</p>	
HISTORY	
<p>John Fenlow was granted 30 acres (Portion 26, Parish Pitt Town) on the River Hawkesbury in the District of Mulgrave Place on 3 November 1794. Fenlow shot dead his assigned servant David Lane on 4 July 1796, on suspicion that he had been consorting with his wife, Eleanor Byrnes. Local Aborigines assisted in locating Fenlow who was hiding on his grant. Fenlow was executed, apparently the only landholder to be executed before 1796.</p> <p>On 21 September 1798, Jane Wheeler conveyed the grant to Thomas Gilberthorp. Thomas Gilberthorpe was recorded in 1802 as holding 30 acres in the district of Mulgrave Place acquired by purchase, with 14 acres cleared, and 11 acres in wheat with 1 acre in maize. Thomas Gilberthorpe advertised for two Sawyers to 'cut Timber for Building contiguous to Pitt Town on 11 May 1811. Inquiries were to be directed to Gilberthorpe, 'Cottage Farm, Hawkesbury'. Thomas Gilberthorpe of Pitt Town was commended on 5 February 1814 for offering grain to the government when others are withholding in the hope of higher prices.</p> <p>Gilberthorpe appears to have sold the grant in smaller parcels. On 19 February 1817, Thomas Gilberthorp conveyed an unspecified area of land to Mary Nelson. In the 1830s and 1840s, different parts of Fenlow's grant were sold to Thomas Chaseling. On 14 November 1838, Mary Nelson sold an unspecified area to Thomas Chaseling. Later documentation suggests that this comprised 15 acres. Subsequently, on 14 October 1844, Constantine Molloy and Sarah Molloy sold</p>	

8 acres to Thomas Chaseling. Charles and Maria Kipper sold another part of 10 acres to Thomas Chaseling on 12 December 1857. The 15 acres sold by Mary Nelson to Chaseling is the site of 303 Pitt Town Bottoms Road.

A press report of 15 November 1859 of a master and servant case involving Thomas Chaseling, Pitt Town referred to taking a horse out of the stable.

REFERENCES

Grants Vol 1 p 109 (3)
Jan Barkley-Jack, *Hawkesbury Settlement Revealed*, pp 329-330
C J Baxter, *Musters and Lists New South Wales: and Norfolk Island 1800-1802*, ABGR, Sydney, 1988, entry AG382
Deposited Deeds Receipt 18997, Land Registry Services, New South Wales
Sydney Gazette, 11 May 1811, p 1
Sydney Gazette, 5 Feb 1814, p 1
SMH, 15 Nov 1859 p 3
Old System Deed, No. 413 Bk 75

ITEM DETAILS	
NAME	Single Storey Slab Barn with Loft and Skillions
ADDRESS	313 Pitt Town Bottoms Road, Pitt Town Bottoms
LOCAL GOVT AREA	Hawkesbury
PARISH	Pitt Town
LOT/DP	Lot 1 DP 778704
SHI No.	1743096
EXISTING HERITAGE ITEM?	Yes- Item No. I466 (Heritage Item No. 1740036)
RECOMMENDED MANAGEMENT	
MANAGEMENT SUMMARY	Not recommended for State listing. Site inspection required into condition and integrity. Retain as local heritage item.
ITEM CLASSIFICATION	
ITEM TYPE	Built
ITEM GROUP	Farming and Grazing
ITEM CATEGORY	Barn
DESCRIPTION	
CIRCA	Y
PERIOD	Late 19 th or early 20 th century (based on roof pitch, use of slabs and corrugated iron, although would benefit from further investigation)
MODIFICATION/DATES	Unsympathetic additions to eastern side. Changes from 2010-Unknown
CURRENT USE	Dwelling
FORMER USE	Barn
LOCATION ON SITE:	The barn runs north-south alongside weatherboard house and is close to northern site boundary approximately 230m from eastern bank of Hawkesbury River In 2010 and 2023: Access was denied to the site. This description is based on previous inspection in 1991 by Graham Edds & Associates and viewing the site from the road.
MAIN BARN STRUCTURE	Single storey barn 10.6 x 6m on plan with round posts supporting loft and gabled roof. The northern roof slope continues to enclose a skillion which is hipped and wraps around the western end. Condition: Good Date: Late 19 th or early 20 th century
NO. OF BAYS	Six
ROOF STRUCTURE	Roof pitch approximately 30°. Condition: Not known Date: Late 19 th or early 20 th century
LOFT	Loft has a door and window at the northern end and a window in the southern end. It contains a loft floor at eaves level. Condition: Not known Date: Late 19 th or early 20 th century
SKILLION 1	Skillion is 3m wide and is supported on round posts and clad with vertical timber slabs. Condition: Not known Date: Late 19 th or early 20 th century
ROOF CLADDING:	Corrugated iron in short sheets Condition: Moderate. Date: Late 19 th or early 20 th century

WALL CLADDING	Vertical timber slabs with weatherboards to loft level and gables. Condition: Moderate Date:
OPENINGS	Main ground floor opening is positioned centrally on western side
FLOORING (GROUND)	Not known
FLOORING (LOFT)	Not known
FLOORING (SKILLION)	Not known
INTERNAL STRUCTURE	Not known
HISTORY	
<p>John Fenlow was granted 30 acres (Portion 26, Parish Pitt Town) on the River Hawkesbury in the District of Mulgrave Place on 3 November 1794. Fenlow (vars. Fendlow) was sentenced to transportation for 7 years and arrived in the colony in 1788 as part of the First Fleet.</p> <p>Fenlow shot dead his assigned servant David Lane on 4 July 1796, on suspicion that he had been consorting with his wife, Eleanor Byrnes. Local Aborigines assisted in locating Fenlow who was hiding on his grant. Fenlow was executed, apparently the only landholder to be executed before 1796.</p> <p>The subsequent history of the grant is unclear until the 1840s. On 21 September 1798, Jane Wheeler conveyed the grant to Thomas Gilberthorpe, an ex-convict who arrived in 1791. Thomas Gilberthorpe was recorded in 1802 as holding 30 acres in the district of Mulgrave Place acquired by purchase, with 14 acres cleared, and 11 acres in wheat with 1 acre in maize. Gilberthorpe advertised for two Sawyers to 'cut Timber for Building contiguous to Pitt Town on 11 May 1811. Inquiries were to be directed to Gilberthorpe, 'Cottage Farm, Hawkesbury'. Thomas Gilberthorpe of Pitt Town was commended on 5 February 1814 for offering grain to the government when others are withholding in the hope of higher prices.</p> <p>Gilberthorpe appears to have sold the grant in smaller parcels. There is no information currently available about the history of this part of the grant for the following three decades.</p> <p>On 7 April 1857, by a deed of Release, Thomas Miles of Pitt Town, farmer and Abraham Easterbrook of Pitt Town, farmer conveyed 10 acres to John Davis of Pitt Town, farmer. Davis had commenced legal action to obtain possession of this land, which he claimed was illegally held by Miles and Easterbrook. They agreed to convey the land for £100. The 10 acres was described as part of John Fenlow's grant, bounded on the north by the River Hawkesbury in the rear by the land originally held by William Hall, but then by James Dunstan, on the north east by Charles Kipper's other part of Fenlow's portion, on the south east by Thomas Chaseling's land then occupied by James Dunstan. This description was subsequently linked to more recent deeds regarding this parcel of land.</p> <p>The <i>Hawkesbury Pioneer Register</i>, 1994 edition, noted that Abraham Easterbrook was the son-in-law of Thomas Miles. Thomas Miles died on 26 April 1857, aged 84, after choking on a piece of meat.</p> <p>On 12 January 1872, John Davis, senior, of Pitt Town, farmer conveyed this land to John Davis, junior of Pitt Town, farmer. It appears that the property remained in the hands of the Davis family until the mid 20th century.</p> <p>Based on the known physical evidence, the barn appears to have been constructed by the Davis family.</p>	
REFERENCES	Grants Vol 1 p 109 (3) Jan Barkley-Jack, <i>Hawkesbury Settlement Revealed</i> , pp 329-330

	<p>C J Baxter, <i>Musters and Lists New South Wales: and Norfolk Island 1800-1802</i>, ABGR, Sydney, 1988, entry AG382 <i>Sydney Gazette</i>, 11 May 1811, p 1 <i>Sydney Gazette</i>, 5 Feb 1814, p 1 <i>Sydney Morning Herald</i>, 29 April 1857, p 3 Old System Deed, No 646 Bk 48 Old System Deed, No 254 Bk 129 Old System Deed, No 347 Bk 2654 Old System Deed, No 109 Bk 3137 Hawkesbury Pioneer Register, 1994, p 126</p>
STATEMENT OF SIGNIFICANCE	
<p>The barn at No. 313 Pitt Town Bottoms Road, Pitt Town Bottoms is of historical significance as a surviving late 19th to early 20th century barn and is representative of the long term agricultural use of the land, first granted in 1794 to ex-convict John Fenlow in 1794.</p> <p>Sited above the floodplains of the Hawkesbury River, the barn is located in a small complex with weatherboard cottage and mature trees that together make a strong contribution to the historical character of the agricultural lands along Pitt Town Bottoms Road. The overall form and configuration of the barn, with corrugated metal cladding and surviving timber slabs is good representative example of the historic barn type found throughout the Hawkesbury City local government area.</p> <p>The barn is potentially of technical significance for retaining surviving evidence of late 19th to early 20th century construction techniques , however, further research is required to determine its current condition and level of integrity.</p>	
ASSESSED SIGNIFICANCE TYPE	Local
CRITERIA A) HISTORICAL	<p>The barn at No. 313 Pitt Town Bottoms Road, Pitt Town Bottoms is of historical significance as evidence of the long-term agricultural use of the land, first established in 1794 by ex-convict John Fenlow and as a surviving, late 19th to early 20th century barn.</p> <p><i>Meets the criterion on a Local level.</i></p>
CRITERIA B) HISTORICAL ASSOCIATION	<p>The barn has historical associations with John Davis and his descendants. The Davis family obtained the property in the mid 19th century and appear to have retained ownership until the mid 20th century.</p> <p><i>Meets the criterion on a Local level.</i></p>
CRITERIA C) AESTHETIC/TECHNICAL	<p>Located within a complex together with a weatherboard cottage and mature trees sited above the floodplains of the Hawkesbury River, the timber slab clad barn make a strong contribution to the historical character of the agricultural landscape along Pitt Town Bottoms Road.</p> <p><i>Meets the criterion on a Local level.</i></p>
CRITERIA D) SOCIAL/CULTURAL	<p>The historic barns of the Hawkesbury district are appreciated by the local community and others, being symbolic of the history of the agricultural development of the region, as evidenced by the numerous exhibitions, artworks, historical tours, heritage studies and heritage listings associated with these building types.</p> <p><i>Meets the criterion on a Local level.</i></p>

CRITERIA E) RESEARCH POTENTIAL	The form of the barns, with skillions and lofts has the potential to provide further information into late 19 th century farming methods. <i>Meets the criterion on a Local level.</i>
CRITERIA F) RARITY	The barn at No. 313 Pitt Town Bottoms Road, Pitt Town Bottoms is potentially rare within the context of the Hawkesbury City local government area, as a surviving late 19 th to early 20 th century timber slab barns that remains in use. <i>Meets the criterion on a Local level.</i>
CRITERIA G) REPRESENTATIVE	The barn at No. 313 Pitt Town Bottoms Road, Pitt Town Bottoms is representative of the long history of agricultural development within the floodplains of the Hawkesbury River, which commenced in the early 19 th century and continues today. The basic form of the barn with gabled roof, skillions and lofts is representative of the typical form of barn found throughout the district. <i>Meets the criterion on a Local level.</i>
INTEGRITY/INTACTNESS	Unknown

IMAGES



Caption: Barn at No. 313 Pitt Town Bottoms Road, Pitt Town Bottoms
Photographer: S. Johnson
Copyright Owner: Lucas Stapleton Johnson & Partners
Date: May 2023



Caption: Barn at No. 313 Pitt Town Bottoms Road, Pitt Town Bottoms
Photographer: S. Johnson
Copyright Owner: Lucas Stapleton Johnson & Partners
Date: May 2023



Caption: Barn at No. 313 Pitt Town Bottoms Road, Pitt Town Bottoms
Photographer: S. Johnson
Copyright Owner: Lucas Stapleton
Johnson & Partners
Date: May 2023

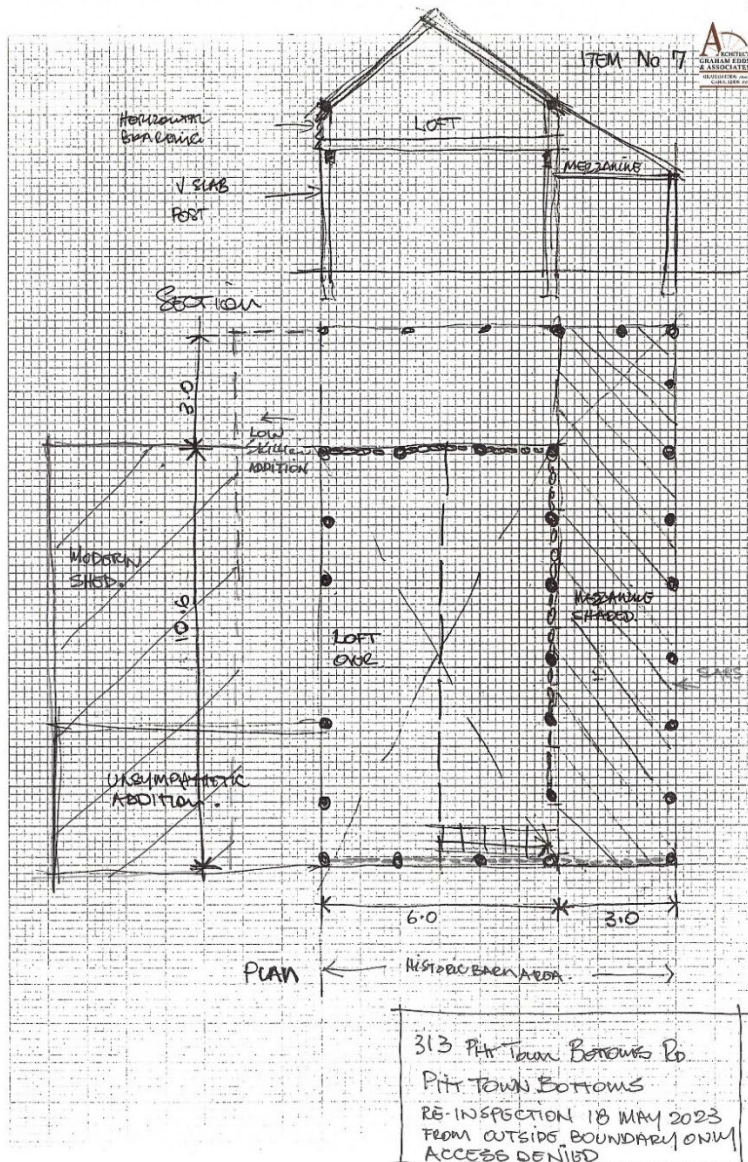

Caption: Measured drawing of barn at No. 313 Pitt Town Bottoms Road, Pitt Town Bottoms
Copyright Owner: Graham Edds & Associates
Date: 1991

ITEM DETAILS	
NAME	Single Storey Slab Barn with Loft and Chimney- Demolished
ADDRESS	333 Pitt Town Bottoms Road, Pitt Town Bottoms
LOCAL GOVT AREA	Hawkesbury
PARISH	Pitt Town
LOT/DP	Lot 1 DP 774609
SHI No.	1743097
EXISTING HERITAGE ITEM?	N
RECOMMENDED MANAGEMENT	
MANAGEMENT SUMMARY	Not recommended for State or local listing
ITEM CLASSIFICATION	
ITEM TYPE	Built
ITEM GROUP	Farming and Grazing
ITEM CATEGORY	Barn
DESCRIPTION	
CIRCA	Y
PERIOD	Late 18 th to early 19 th century
MODIFICATION/DATES	[2010 inventory sheet] 1991 to 2009 The barn has developed a considerable lean due to the loss of structural integrity. Shortly after the site inspection a severe wind storm removed the remaining roof cladding.
CURRENT USE	Unknown
FORMER USE	Residence?
INTEGRITY/INTACTNESS	Unknown. Original barn appears to have been demolished.
<p>2023: Access not permitted. Not inspected. The former barn/residence included in the 1991 study appears to have been demolished and replaced with a large, corrugated metal clad shed.</p> <p>[2010 inventory sheet] The physical description below is an extract from the 'Pitt Town Slab Barn Study', 1991, by Graham Edds and Associates. This 2009 study has recorded changes/deterioration within the modification date field. Description 1991 : Single storey barn with loft and chimney. Slab walls and corrugated iron roof. Sandstone brick end wall and chimney collapsed. Previous battening for shingles evident. Characteristic lean. Covered in grape vine and wisteria. Central area of barn 9m x 4m. Located on land below the 1 in 100 year flood level. Structure: Post and beam structure. Posts extend into loft. Posts at close centres. Vertical slabs between posts to loft floor level. Horizontal splayed boarding to gable and sides above slabs.</p>	
HISTORY	
<p>Peter Bond was granted 30 acres on the east side of the River Hawkesbury in the district of Mulgrave Place to be known as Parker Farm on 3 November 1794. By the late 1790s, Peter Bond's farm along with those of Edward Cunningham and John Owen had been acquired by Deputy Commissary James Williamson, which were managed for him by John Brenan. On 15 February 1803, James Williamson signed an agreement that John Brenan would supervise Williamson's Hawkesbury farms for £100. James Williamson leased three unnamed farms of cleared land to Laurence May on 1 August 1806. These were possibly the three farms of Bond, Cunningham and Owen.</p> <p>On 26 & 27 January 1829, by a deed of Lease and release, Jane Williamson of Parramatta, widow, administrator of the estate of James Williamson deceased sold Parker farm of 30 acres granted to</p>	

Peter Bond to Patrick Mahony and Maurice Mahony of Pitt Town, farmers for £320. Patrick Mahoney signed his will on 28 December 1865 and died on 4 January 1866. On 26 May 1866, the trustees of the deceased estate of Patrick Mahoney, Windsor, yeoman, divided Peter Bond's grant amongst his devisees into 4 lots.

REFERENCES

Grants, Vol 1 No 107
Jan Barkley-Jack, Hawkesbury Settlement Revealed, pp 149, 333-4
Old Register Volume 1 page 76 no 361
Old Register Volume 1 page 139 No 1071
Old System Deed, No 590 Bk B
Old System Deed, No 696 Bk 98

ITEM DETAILS	
NAME	Single Storey Slab Barn with Loft and Ramp
OTHER/FORMER NAMES	Pittsmoor/ Owens Farm
ADDRESS	353 Pitt Town Bottoms Road, Pitt Town Bottoms
LOCAL GOVT AREA	Hawkesbury
PARISH	Pitt Town
LOT/DP	Lot 1 DP 569711
SHI No.	1743098
EXISTING HERITAGE ITEM?	Y- I467 (Heritage Item No. 1740037)
RECOMMENDED MANAGEMENT	
MANAGEMENT SUMMARY	Recommend for State heritage listing
	Retain as Local item
ITEM CLASSIFICATION	
ITEM TYPE	Built
ITEM GROUP	Farming and Grazing
ITEM CATEGORY	Barn
DESCRIPTION	
CIRCA	Y
PERIOD	Early 19 th century
MODIFICATION/DATES	Mid 19 th (skillion) to Mid 20 th century (roof cladding)
CURRENT USE	Machinery store.
LOCATION ON SITE:	The barn is orientated north-south and is located halfway between road and east bank of Hawkesbury River (approximately 140m east of river).
MAIN BARN STRUCTURE	A large and impressive single-storey barn 13.7m x 6.5m on plan with a loft supported on square adzed posts with unusual projecting eaves detail and longitudinal beams with trenched undersides to take post tenons and shaped ends of vertical slabs. Condition: Moderate Date: Early 19 th century
NO. OF BAYS	Eight
ROOF STRUCTURE	Roughly squared rafters at close centres, pegged to eaves beam and loft floor joists. Most of the original shingle battens survive. Condition: Moderate Date: Early 19 th century
LOFT	Tightly laid timber floor boards on round joists with top and bottom surfaces adzed flat. Condition: Moderate Date: Early 19 th century
SKILLION 1	Skillion to southern end built of small section round timber rafters on sawn square beam bolted to round posts. There is no sign of shingle battens. Gables are clad in weatherboard. Condition: Moderate Date: Mid- late 19 th
ROOF CLADDING:	Corrugated galvanized iron. Condition: Moderate Date: Mid-20 th century?
WALL CLADDING	Vertical timber slabs, weatherboards to gable ends. Condition: Moderate. Date: Early 19 th century

OPENINGS	Central doorway opening to east side. Loft accessed via external
FLOORING (GROUND)	Earthen
FLOORING (LOFT)	Timber boarding
FLOORING (SKILLION)	Earthen
OTHER (Fixings?)	Unusual cantilevered eaves with pegged joints. Unusual trenched longitudinal edge beam to suit mortises on top of posts and to accept shaped ends of vertical timber slabs.
CHANGES FROM 2010?	Raked round posts have been added outside both long sides and bolted to longitudinal beams to buttress the barn. Ramp rebuilt.
FORMER USE	Barn
HISTORY	
<p>The barn at No. 353 Pitt Town Bottoms Road, Pitt Town Bottoms is located on part of a grant of 30 acres (Portion 24, Parish Pitt Town) made on 3 November 1794 to John Owen situate on the east side of the River Hawkesbury in the district of Mulgrave Place to be known as Owen Farm. Ex-convict John Owen had arrived in the colony as part of the First Fleet.</p> <p>By 1800, John Owen's 30 acres at Mulgrave Place, was held by James Williamson, Commissary with 20 acres cultivated. By this time, Williamson owned 359 acres of land and 419 head of stock including 320 sheep, one of the largest flocks in the settlement. It appears that No. 353 Pitt Town Bottoms Road, Pitt Town Bottoms was one of a number of properties owned by Williamson and it is assumed the property was farmed by tenants or employees.</p> <p>James Williamson died in 1826. On 1 June 1830, his widow, Jane Williamson, of Parramatta, conveyed John Owen's 30 acre grant to Patrick Mahony, Pitt Town, farmer for £300. The deed recited that John Owen's grant, was previously owned by John Owen. It was then held by Robert Ledaway, and then by James Williamson. It had lately been occupied by Patrick Mahony as tenant, who was now purchasing the land.</p> <p>By a conveyance of 13 June 1865, Patrick Mahoney, Windsor, farmer conveyed various parcels of land to Roger Ryan, North Richmond, farmer. The land was 100 acres in several parcels being 50 acres, 37 acres 30 perches and 12 acres 3 roods 10 perches. The last parcel of 12 acres 3 roods 10 perches is the one relevant to this site, being part of a grant to John Owen, commencing at the Hawkesbury River at the south west corner of Cunningham's 30 acres bounded on the north by that grant 37 chains 50 links and then on the east by a line 3 chains 47 Links, on the south by a line to the Hawkesbury River, 38 chains, and on the west by that river.</p> <p>After the death of Roger Ryan, the property passed to Edward Ryan, Glebe, carrier. It was then known as Myall Farm, occupied by Mrs John Ryan.</p> <p>Based on the physical evidence of the construction it is assumed the barn was built by James Williamson between 1800-26 or Patrick Maloney who owned the property from 1826 to 1865.</p>	
REFERENCES	<p>Grants Vol 1 No 107</p> <p>C J Baxter, <i>Musters and Lists New South Wales: and Norfolk Island 1800-1802</i>, ABGR, Sydney, 1988, entry AE522; entry AB059, List of land held by government officials</p> <p>B H Fletcher, 'J Williamson (1758-1826)', <i>Australian Dictionary of Biography</i>, volume 2, 197, p 602</p> <p>C J Baxter, <i>Musters of New South Wales and Norfolk Island 1805-1806</i>, ABGR, Sydney, 1989, entry A3338</p> <p>Old System Deed, No 446 Bk C; No 798 Bk 98; No 756 Bk 959</p>

STATEMENT OF SIGNIFICANCE	
<p>The barn at No. 353 Pitt Town Bottoms Road, Pitt Town Bottoms is of historical, aesthetic, technical significance and rarity on a State level as a surviving early 19th century barn of high integrity.</p> <p>The large (8 bay) barn with ramp access to loft level is a distinctive element in the rural landscape of Pitt Town Bottoms Road and makes a strong contribution to the historical character of the locality. The ramp in particular is a distinctive feature related to its position adjacent to the Hawkesbury River, allowing easy transportation of stock, equipment and machinery into the loft in times of flood, an important advantage for properties located in the floodplains.</p> <p>The barn is of technical significance for retaining evidence of its early 19th century construction and unusual detailing including adzed posts, projecting eaves with pegged joints, longitudinal beams with trenched undersides to take post tenons and shaped ends of vertical slabs, roughly squared rafters at close centres pegged to eaves beam and loft floor joists, surviving shingle battens and tightly laid timber floor boards on round joists with top and bottom surfaces adzed flat.</p> <p>The barn at No. 353 Pitt Town Bottoms Road, Pitt Town Bottoms is considered to be rare within the context of the Hawkesbury City local government area for its unusual detailing, large scale, and extent of surviving early 19th century fabric. Of particular note is the overhanging triangulated roof together with timber pegged joints and close spacing of posts suggesting a very early construction date (potentially in the first two decades of the 19th century).</p>	
ASSESSED SIGNIFICANCE TYPE	State
CRITERIA A) HISTORICAL	<p>The large barn at No. 353 Pitt Town Bottoms Road, Pitt Town Bottoms, is of historical significance as a surviving early 19th century barn that remains substantially intact, and as evidence of the long-term agricultural use of the land since the late 18th century.</p> <p><i>Meets the criterion on a State level.</i></p>
CRITERIA B) HISTORICAL ASSOCIATION	<p>The property is associated with ex-convict John Owen who was granted the land, known as Owens Farm, in 1794; and with James Williamson, Commissary who owned the land between 1800 and 1826 as one of a number of land holdings and with Patrick Maloney, local farmer who owned the property from 1826 to 1865. It is not known which owner or tenant of the land in the early 19th century was responsible for the construction of the barn.</p> <p><i>Meets the criterion on a Local level.</i></p>
CRITERIA C) AESTHETIC/TECHNICAL	<p>The large (8 bay) barn with ramp access to loft level is of aesthetic significance as a distinctive element in the rural landscape of Pitt Town Bottoms Road and makes a strong contribution to the historical character of the locality.</p> <p>The ramp is a distinctive feature related to its position adjacent to the Hawkesbury River, allowing easy transportation of stock, equipment and machinery into the loft in times of flood, an important advantage for properties located in the floodplains.</p> <p>The barn is of technical significance for retaining evidence of its early 19th century construction and unusual detailing including</p>

	<p>adzed posts, projecting eaves with pegged joints, longitudinal beams with trenched undersides to take post tenons and shaped ends of vertical slabs, roughly squared rafters at close centres pegged to eaves beam and loft floor joists, surviving shingle battens and tightly laid timber floor boards on round joists with top and bottom surfaces adzed flat. Of particular note is the overhanging triangulated roof together with timber pegged joints and close spacing of posts suggesting a very early construction date (potentially in the first two decades of the 19th century).</p> <p><i>Meets the criterion on a State level.</i></p>
CRITERIA D) SOCIAL/CULTURAL	<p>The historic slab barns and outbuildings of the Hawkesbury district are appreciated by the local community and others, being symbolic of the history of the agricultural development of the region, as evidenced by the numerous exhibitions, artworks, historical tours, heritage studies and heritage listings associated with these building types.</p> <p><i>Meets the criterion on a Local level.</i></p>
CRITERIA E) RESEARCH POTENTIAL	<p>The large, highly intact barn of unusual detailing with surviving evidence of its early 19th century construction has high potential to provide further information into early 19th century farming methods and construction techniques.</p> <p><i>Meets the criterion on a State level.</i></p>
CRITERIA F) RARITY	<p>The barn at No. 353 Pitt Town Bottoms Road, Pitt Town Bottoms is considered to be rare within the context of the Hawkesbury City local government area for its unusual detailing, large scale, and extent of surviving early 19th century fabric.</p> <p><i>Meets the criterion on a State level.</i></p>
CRITERIA G) REPRESENTATIVE	<p>The barn is representative of the long history of agricultural development within the floodplains of the Hawkesbury River and South Creek, which commenced in the late 18th century and continues today.</p> <p>Its overall form with gabled roof, skillion, loft and timber slab wall cladding is representative of the typical form of barn found throughout the district.</p> <p><i>Meets the criterion on a Local level.</i></p>
INTEGRITY/INTACTNESS	High

IMAGES



Caption: Barn at No.353 Pitt Town Bottoms Road, Pitt Town Bottoms (exterior)
Photographer: S. Johnson
Copyright Owner: Lucas Stapleton Johnson & Partners Pty Ltd
Date: May 2023



Caption: Barn at No.353 Pitt Town Bottoms Road, Pitt Town Bottoms (exterior)
Photographer: S. Johnson
Copyright Owner: Lucas Stapleton Johnson & Partners Pty Ltd
Date: May 2023



Caption: Barn at No.353 Pitt Town Bottoms Road, Pitt Town Bottoms (interior of skillion)
Photographer: S. Johnson
Copyright Owner: Lucas Stapleton Johnson & Partners Pty Ltd
Date: May 2023