

## APPENDIX B

**HAWKESBURY CITY COUNCIL**

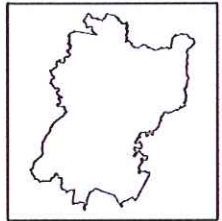
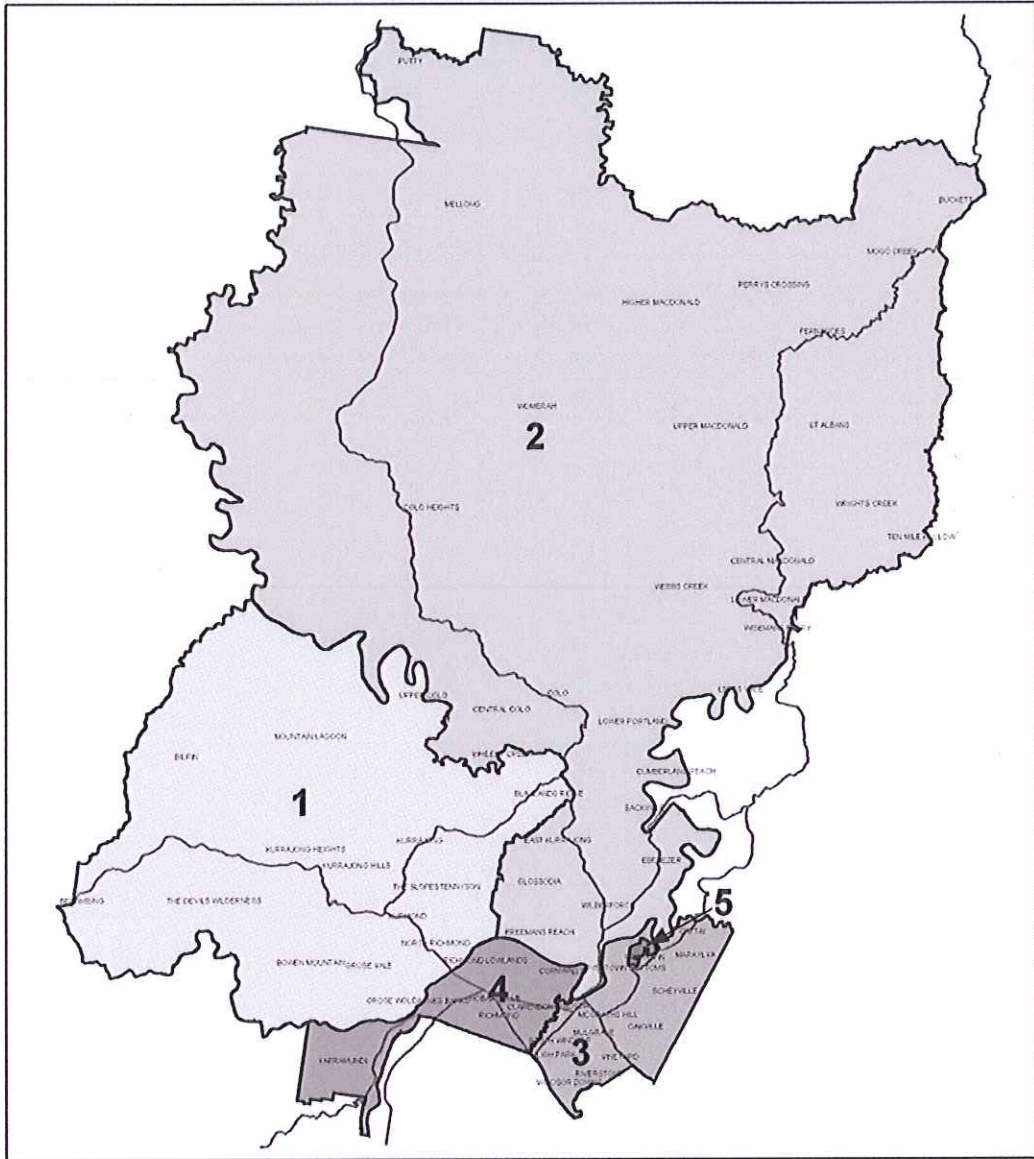

**SECTION 94 CATCHMENTS  
FOR LOCAL CONTRIBUTIONS**

Date: 01/12/05 Filename: sec94\_catch.mxd

Legend	
<span style="display: inline-block; width: 15px; height: 10px; background-color: #e0e0e0; border: 1px solid black;"></span> catchment 1	<span style="display: inline-block; width: 15px; height: 10px; background-color: #808080; border: 1px solid black;"></span> catchment 4
<span style="display: inline-block; width: 15px; height: 10px; background-color: #c0c0c0; border: 1px solid black;"></span> catchment 2	<span style="display: inline-block; width: 15px; height: 10px; background-color: #404040; border: 1px solid black;"></span> catchment 5
<span style="display: inline-block; width: 15px; height: 10px; background-color: #606060; border: 1px solid black;"></span> catchment 3	<span style="display: inline-block; width: 15px; height: 10px; border-bottom: 1px solid black;"></span> Main Roads

This map cannot be reproduced without the permission of Hawkesbury City Council  
Copyright © Land and Property Information 2005  
Hawkesbury City Council 2005

**Not To Scale**  
Map Projection: MSA GC434 Transverse Mercator Zone 56

## 1. Community facilities



# HAWKESBURY CITY COUNCIL

PO Box 149, Windsor NSW 2756  
Website: www.hawkesbury.nsw.gov.au  
Email: council@hawkesbury.nsw.gov.au  
Hours: Monday to Friday 8.30am - 5.00pm  
Phone: 02 4580 4444



## CATCHMENT 1 - COMMUNITY FACILITIES Nth RICHMOND COMMUNITY PRECINCT

Date: 13/01/2015

### Legend

- Land Parcels
- Section94 Works Program Area
- Roads

This map cannot be reproduced without the permission of Hawkesbury City Council  
Copyright © Land and Property Information 2014  
Hawkesbury City Council 2014

The scale displayed is approximate only. Hawkesbury City Council takes no responsibility for any errors or omissions. The assets shown on this map indicate the presence and general location only. Its accuracy or completeness is not guaranteed. Contours are to be used as a guide. A survey may be required for more accuracy.

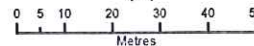

1:1,500 @ A4





# HAWKESBURY CITY COUNCIL

PO Box 146, Windsor NSW 2756  
Website: www.hawkesbury.nsw.gov.au  
Email: council@hawkesbury.nsw.gov.au  
Hours: Monday to Friday 8.30am - 5.00pm  
Phone: 02 4560 4444



## CATCHMENT 2 - COMMUNITY FACILITIES WILBERFORCE LONG DAY CARE EXTENSION

Date: 9/01/2015

### Legend

- Land Parcels
- Section94 Works Program Area
- Roads

This map cannot be reproduced without the permission of Hawkesbury City Council  
Copyright © Land and Property Information 2014  
Hawkesbury City Council 2014

The scale displayed is approximate only. Hawkesbury City Council takes no responsibility for any errors or omissions. The assets shown on this map indicate the presence and general location only. Its accuracy or completeness is not guaranteed. Contours are to be used as a guide. A survey may be required for more accuracy.

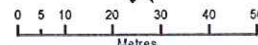

1:1,500 @ A4





# HAWKESBURY CITY COUNCIL

PO Box 146, Windsor NSW 2755  
Website: www.hawkesbury.nsw.gov.au  
Email: council@hawkesbury.nsw.gov.au  
Hours: Monday to Friday 8.30am - 5.00pm  
Phone: 02 4560 4444

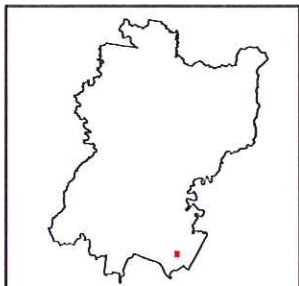
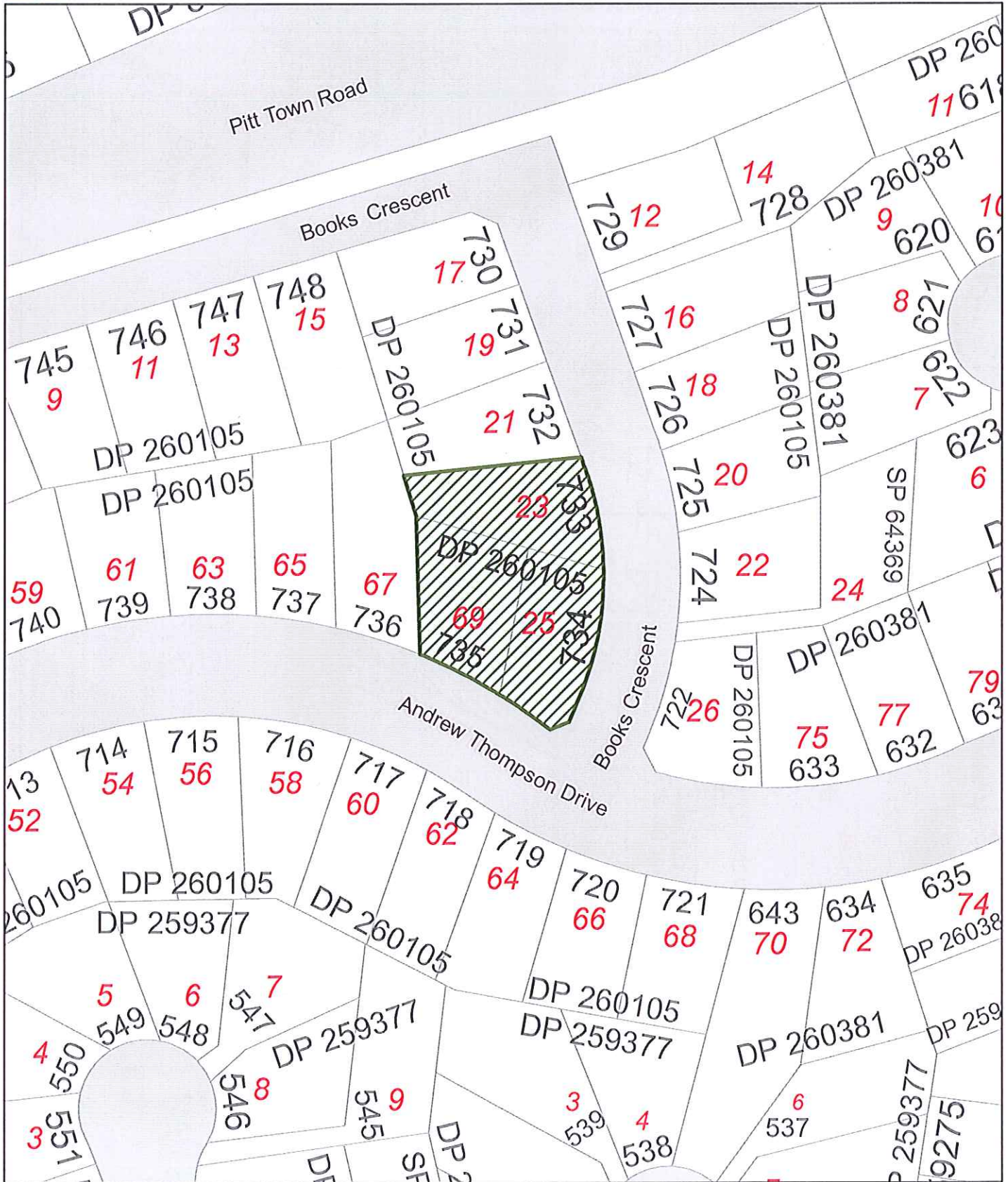

## CATCHMENT 3 - COMMUNITY FACILITIES MCGRATHS HILL CHILD CARE EXTENSION

Date: 9/01/2015

### Legend

- Land Parcels
- Section94 Works Program Area
- Roads

This map cannot be reproduced without the permission of Hawkesbury City Council  
Copyright © Land and Property Information 2014  
Hawkesbury City Council 2014  
The scale displayed is approximate only. Hawkesbury City Council takes no responsibility for any errors or omissions. The assets shown on this map indicate the presence and general location only. Its accuracy or completeness is not guaranteed. Contours are to be used as a guide. A survey may be required for more accuracy.

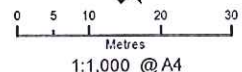









# HAWKESBURY CITY COUNCIL

PO Box 146, Windsor NSW 2756  
Website: www.hawkesbury.nsw.gov.au  
Email: council@hawkesbury.nsw.gov.au  
Hours: Monday to Friday 8.30am - 5.00pm  
Phone: 02 4560 4444

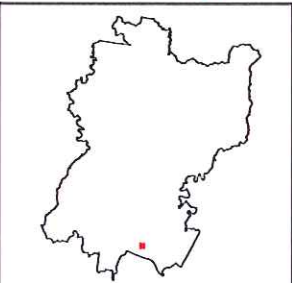

**CATCHMENT 4 - COMMUNITY FACILITIES  
RICHMOND PRESCHOOL EXTENSION**

Date: 13/01/2015

**Legend**

Land Parcels
  Section94 Works Program Area
  Roads

This map cannot be reproduced without the permission of Hawkesbury City Council  
Copyright © Land and Property Information 2014  
Hawkesbury City Council 2014  
The scale displayed is approximate only. Hawkesbury City Council takes no responsibility for any errors or omissions. The assets shown on this map indicate the presence and general location only. Its accuracy or completeness is not guaranteed. Contours are to be used as a guide. A survey may be required for more accuracy.

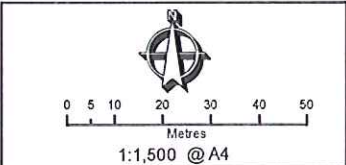









# HAWKESBURY CITY COUNCIL

PO Box 148, Windsor NSW 2756  
Website: www.hawkesbury.nsw.gov.au  
Email: council@hawkesbury.nsw.gov.au  
Hours: Monday to Friday 8.30am - 5.00pm  
Phone: 02 4580 4444



## CATCHMENT DISTRICT - COMMUNITY FACILITIES RICHMOND PRESCHOOL EXTENSION

Date: 13/01/2015

### Legend

- Land Parcels
- Section 94 Works Program Area
- Roads

This map cannot be reproduced without the permission of Hawkesbury City Council  
Copyright © Land and Property Information 2014  
Hawkesbury City Council 2014  
The scale displayed is approximate only. Hawkesbury City Council takes no responsibility for any errors or omissions. The assets shown on this map in scale the presence and general location only. Its accuracy or completeness is not guaranteed. Contours are to be used as a guide. A survey may be required for more accuracy.

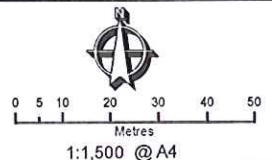





## 2. Recreational facilities





# HAWKESBURY CITY COUNCIL

PO Box 146, Windsor NSW 2756  
Website: www.hawkesbury.nsw.gov.au  
Email: council@hawkesbury.nsw.gov.au  
Hours: Monday to Friday 8:30am - 5:00pm  
Phone: 02 4560 4444

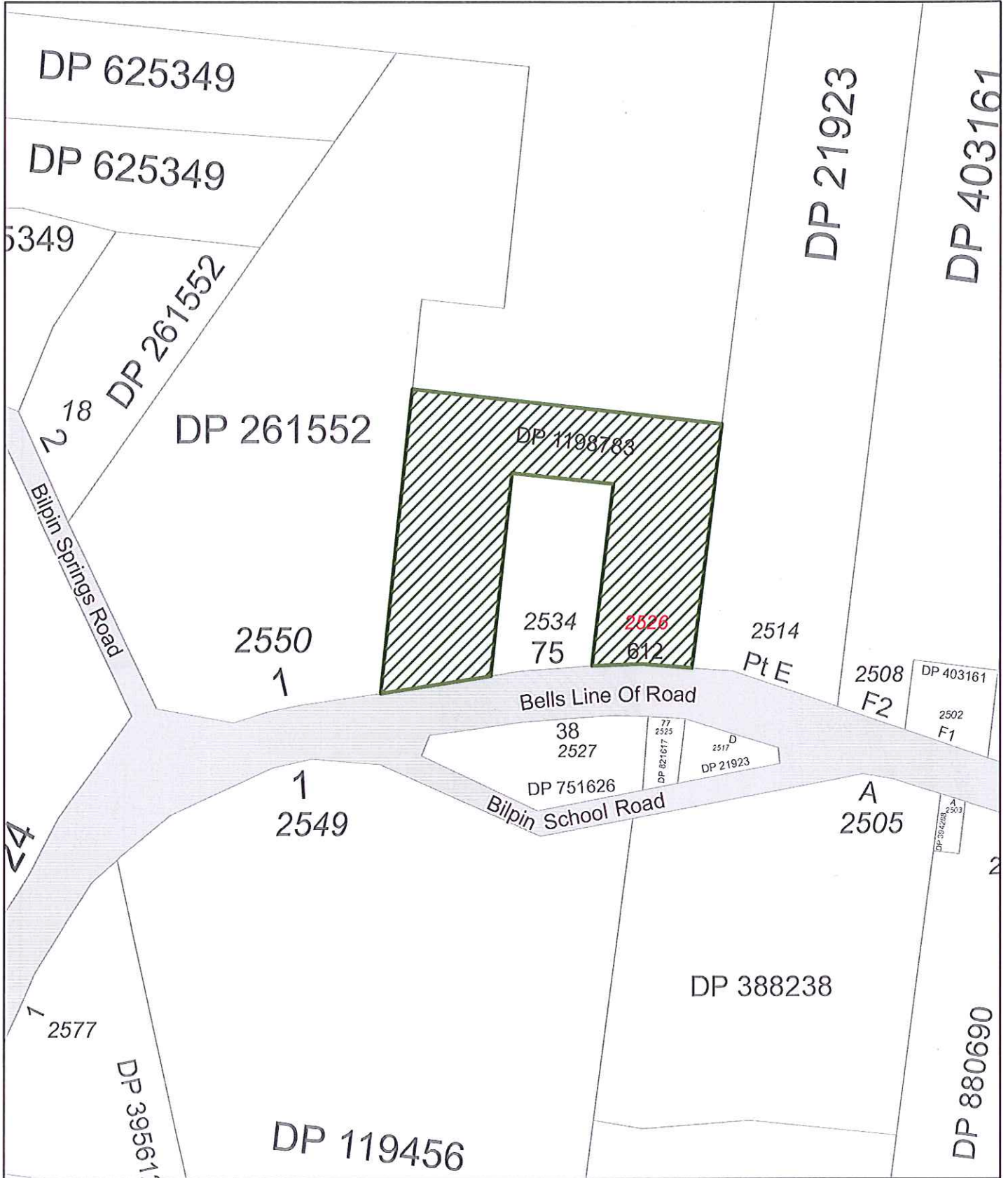

**CATCHMENT 1 - RECREATION BUILDINGS  
BILPIN PARK FACILITY IMPROVEMENTS**

Date: 13/01/2015

**Legend**

- Land Parcels
- Section94 Works Program Area
- Roads

This map cannot be reproduced without the permission of Hawkesbury City Council  
Copyright © Land and Property Information 2014  
Hawkesbury City Council 2014  
The scale displayed is approximate only. Hawkesbury City Council takes no responsibility for any errors or omissions. The assets shown on this map indicate the presence and general location only. Its accuracy or completeness is not guaranteed. Contours are to be used as a guide. A survey may be required for more accuracy.

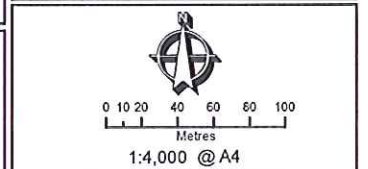







# HAWKESBURY CITY COUNCIL

PO Box 146, Windsor NSW 2756  
Website: www.hawkesbury.nsw.gov.au  
Email: council@hawkesbury.nsw.gov.au  
Hours: Monday to Friday 8.30am - 5.00pm  
Phone: 02 4560 4444

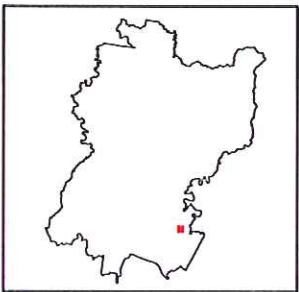
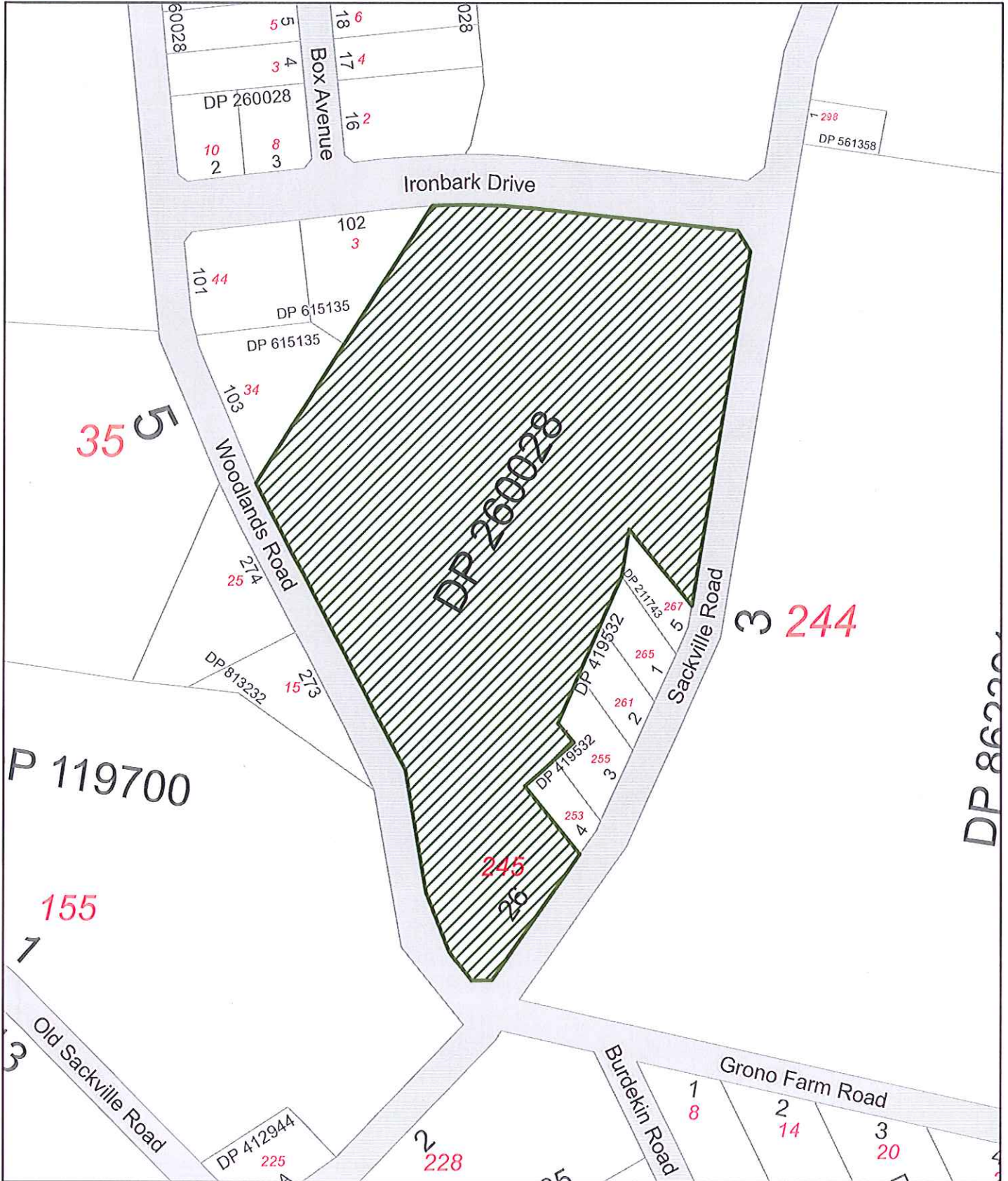

**CATCHMENT 2 - RECREATION BUILDINGS  
WOODLANDS PARK SHELTER**

Date: 13/01/2016

**Legend**

Land Parcels	Section94 Works Program Area	Roads
--------------	------------------------------	-------

This map cannot be reproduced without the permission of Hawkesbury City Council  
Copyright © Land and Property Information 2014  
Hawkesbury City Council 2014

The scale displayed is approximate only. Hawkesbury City Council takes no responsibility for any errors or omissions. The assets shown on this map indicate the presence and general location only. Its accuracy or completeness is not guaranteed. Contours are to be used as a guide. A survey may be required for more accuracy.

1:3,000 @ A4





# HAWKESBURY CITY COUNCIL

PO Box 146, Windsor NSW 2756  
Website: www.hawkesbury.nsw.gov.au  
Email: council@hawkesbury.nsw.gov.au  
Hours: Monday to Friday 8:30am - 5:00pm  
Phone: 02 4560 4444

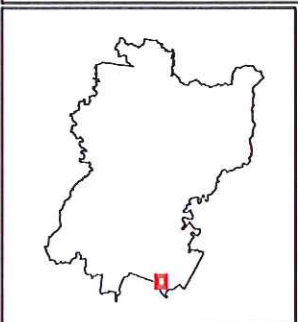

**PROJECT NO. 27**  
**CATCHMENT 3 - RECREATION BUILDINGS**  
**BLIGH PARK RESERVES INCLUDING**  
**BERGER ROAD LAKE RESERVE -**  
**FACILITIES AND IMPROVEMENTS**

Date: 7/04/2015

Legend		
	Land Parcels	
	Section94 Works Program Area	
	Roads	

This map cannot be reproduced without the permission of Hawkesbury City Council  
Copyright © Land and Property Information 2015  
Hawkesbury City Council 2015

The scale displayed is approximate only. Hawkesbury City Council takes no responsibility for any errors or omissions. The assets shown on this map indicate the presence and general location only. Its accuracy or completeness is not guaranteed. Contours are to be used as a guide. A survey may be required for more accuracy.

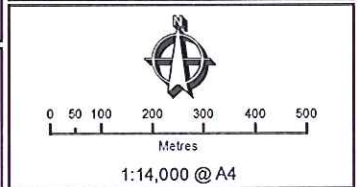





# HAWKESBURY CITY COUNCIL

PO Box 146, Windsor NSW 2756  
Website: [www.hawkesbury.nsw.gov.au](http://www.hawkesbury.nsw.gov.au)  
Email: [council@hawkesbury.nsw.gov.au](mailto:council@hawkesbury.nsw.gov.au)  
Hours: Monday to Friday 8.30am - 5.00pm  
Phone: 02 4550 4444

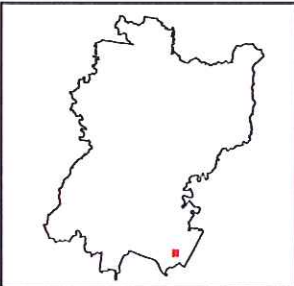
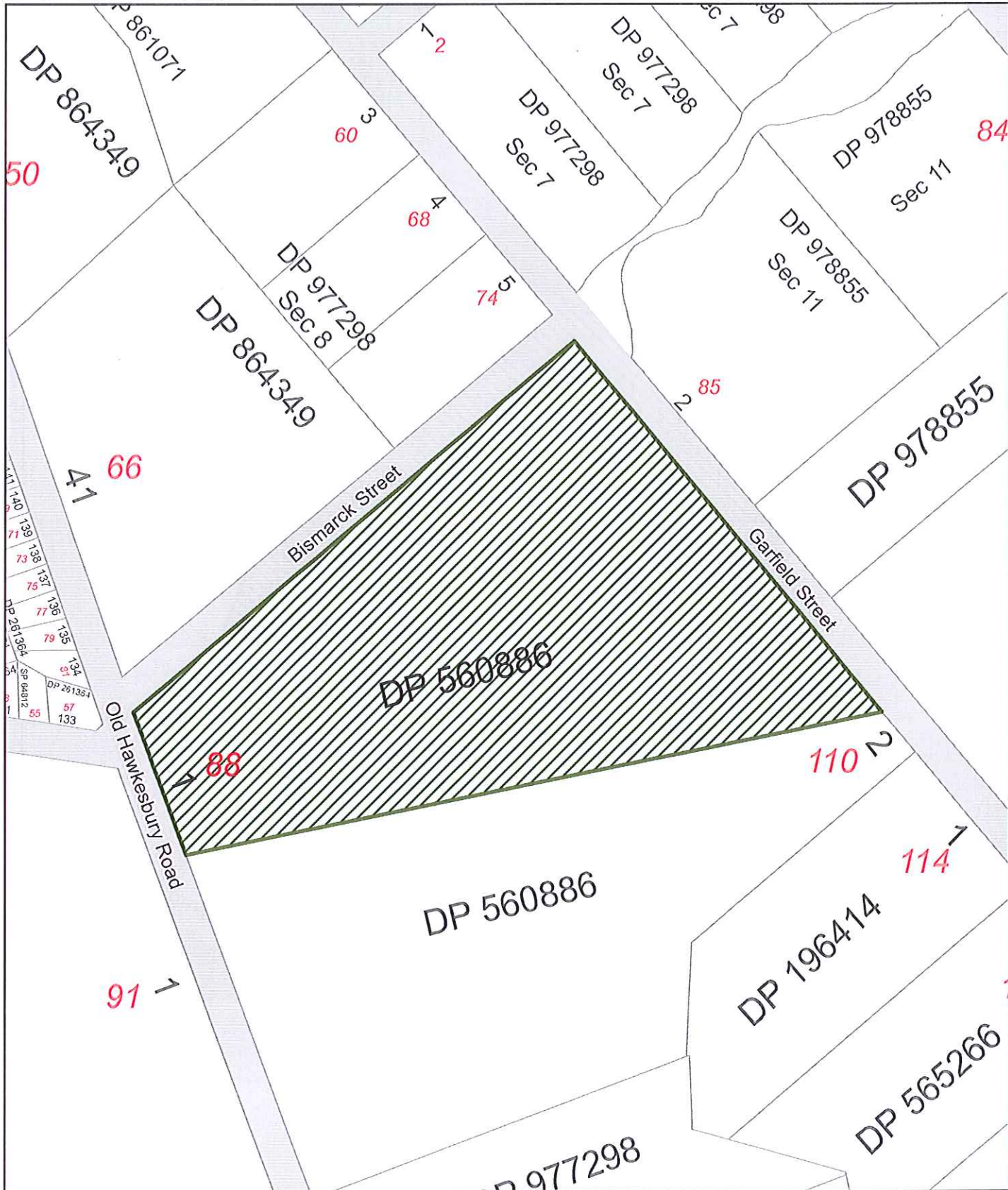

**CATCHMENT 3 - RECREATION BUILDINGS  
COLBEE PARK IMPROVEMENTS**

Date: 9/01/2015

Legend		
	Land Parcels	
	Section94 Works Program Area	
	Roads	

This map cannot be reproduced without the permission of Hawkesbury City Council  
Copyright © Land and Property Information 2014  
Hawkesbury City Council 2014  
The scale displayed is approximate only. Hawkesbury City Council takes no responsibility for any errors or omissions. The details shown on this map indicate the presence and general location only. Its accuracy or completeness is not guaranteed. Contours are to be used as a guide. A survey may be required for more accuracy.











# HAWKESBURY CITY COUNCIL

PO Box 146, Windsor NSW 2756  
Website: www.hawkesbury.nsw.gov.au  
Email: council@hawkesbury.nsw.gov.au  
Hours: Monday to Friday 8.30am - 5.00pm  
Phone: 02 4560 4444

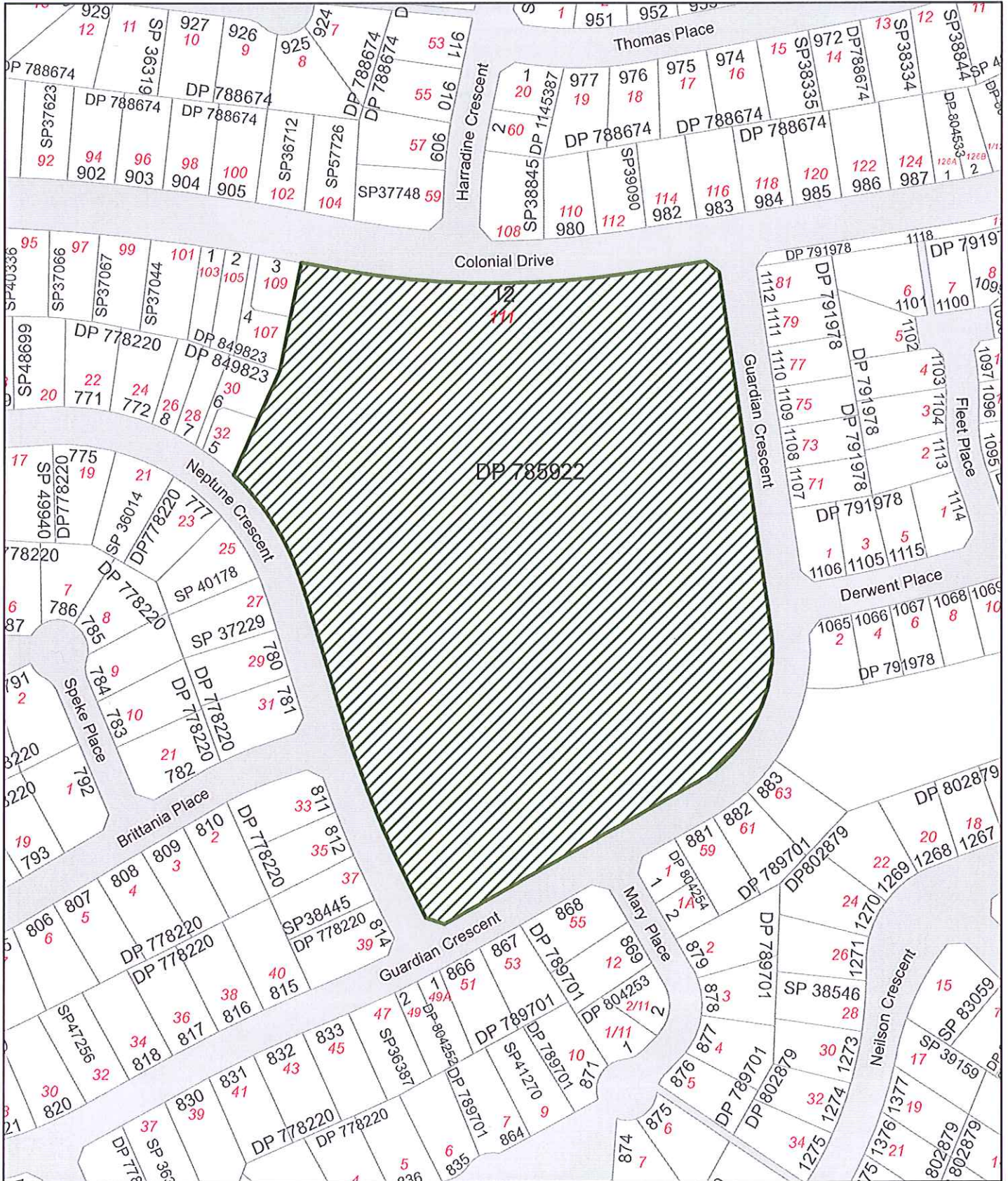

**CATCHMENT 3 - RECREATION BUILDINGS  
COLONIAL RESERVE SHELTERS**

Date: 9/01/2015

**Legend**

- Land Parcels
- Section94 Works Program Area
- Roads

This map cannot be reproduced without the permission of Hawkesbury City Council  
Copyright © Land and Property Information 2014  
Hawkesbury City Council 2014  
The scale displayed is approximate only. Hawkesbury City Council takes no responsibility for any errors or omissions. The assets shown on this map indicate the presence and general location only. Its accuracy or completeness is not guaranteed. Contours are to be used as a guide. A survey may be required for more accuracy.

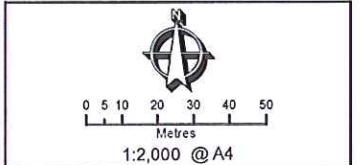





# HAWKESBURY CITY COUNCIL

PO Box 146, Windsor NSW 2758  
Website: www.hawkesbury.nsw.gov.au  
Email: council@hawkesbury.nsw.gov.au  
Hours: Monday to Friday 8.30am - 5.00pm  
Phone: 02 4560 4444

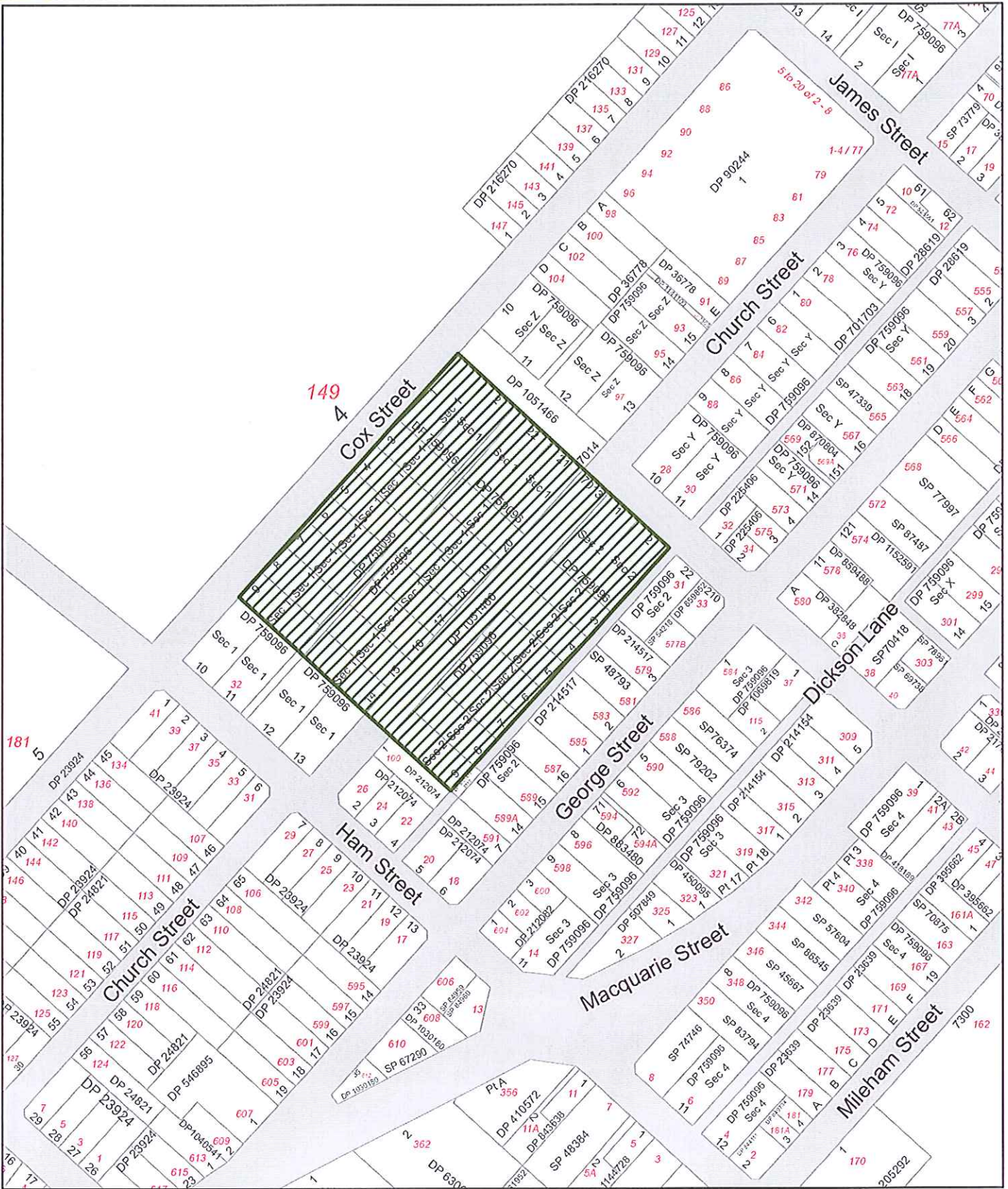

**CATCHMENT 3 - RECREATION BUILDINGS  
OASIS CENTRE - ACCESSIBLE AMENITIES**

Date: 12/01/2015

**Legend**

- Land Parcels
- Section 94 Works Program Area
- Roads

This map cannot be reproduced without the permission of Hawkesbury City Council  
Copyright © Land and Property Information 2014  
Hawkesbury City Council 2014

The scale displayed is approximate only. Hawkesbury City Council takes no responsibility for any errors or omissions. The assets shown on this map indicate the presence and general location only. Its accuracy or completeness is not guaranteed. Contours are to be used as a guide. A survey may be required for more accuracy.

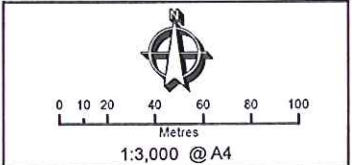





# HAWKESBURY CITY COUNCIL

PO Box 146, Windsor NSW 2756  
Website: www.hawkesbury.nsw.gov.au  
Email: council@hawkesbury.nsw.gov.au  
Hours: Monday to Friday 8.30am - 5.00pm  
Phone: 02 4560 4444

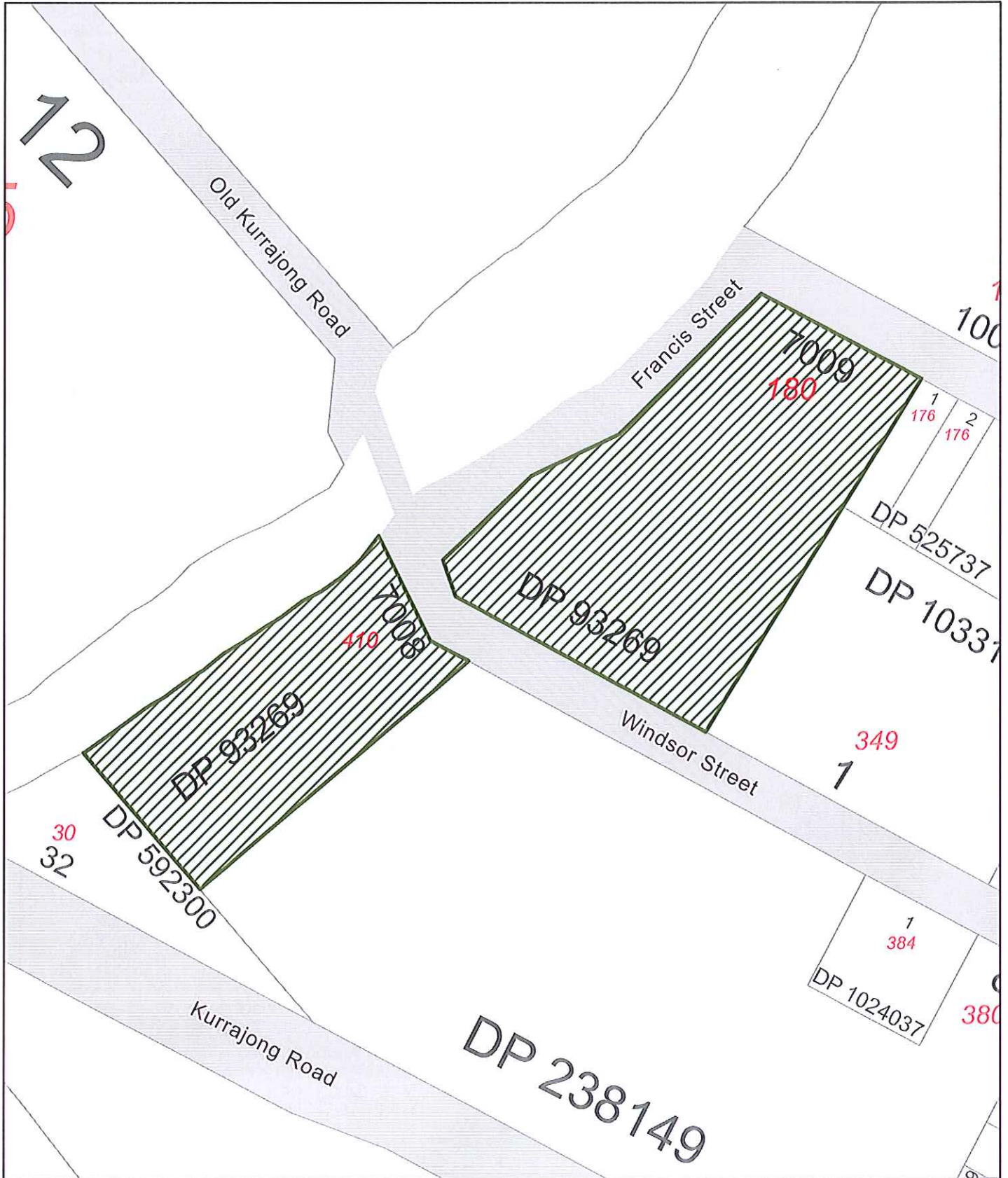

## CATCHMENT 4 - RECREATION BUILDINGS SMITH PARK FACILITIES & IMPROVEMENTS

Date: 9/01/2015

### Legend

- Land Parcels
- Section94 Works Program Area
- Roads

This map cannot be reproduced without the permission of Hawkesbury City Council  
Copyright © Land and Property Information 2014  
Hawkesbury City Council 2014

The scale displayed is approximate only. Hawkesbury City Council takes no responsibility for any errors or omissions. The assets shown on this map indicate the presence and general location only. Its accuracy or completeness is not guaranteed. Contours are to be used as a guide. A survey may be required for more accuracy.

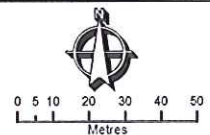

1:2,000 @ A4





# HAWKESBURY CITY COUNCIL

PO Box 146, Windsor NSW 2756  
Website: www.hawkesbury.nsw.gov.au  
Email: council@hawkesbury.nsw.gov.au  
Hours: Monday to Friday 8.30am - 5.00pm  
Phone: 02 4500 4444

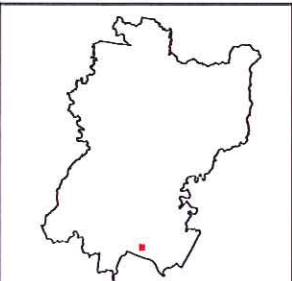
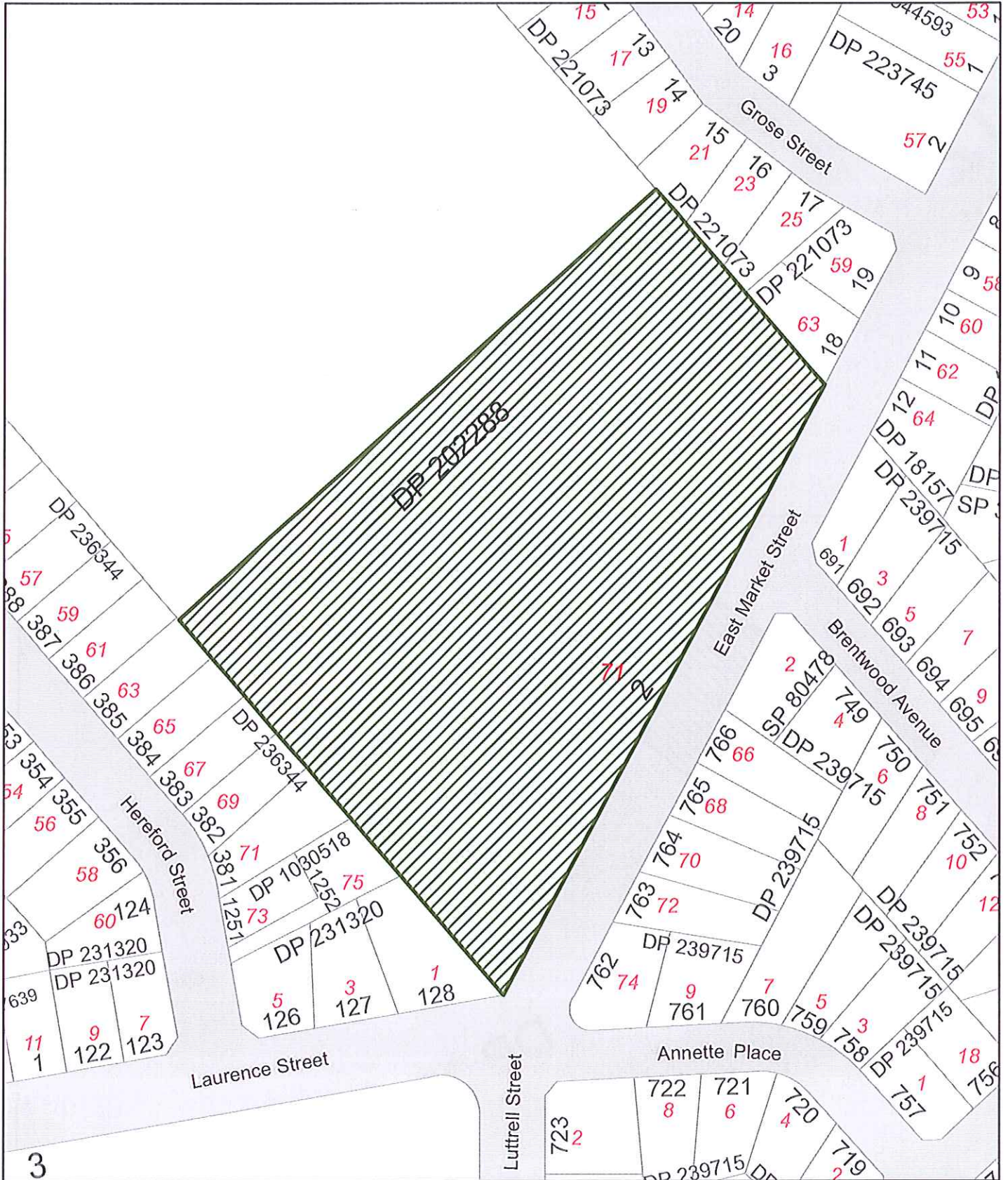

## CATCHMENT 4 - RECREATION BUILDINGS RICHMOND POOL - ACCESSIBLE AMENITIES

Date: 9/01/2015

### Legend

- Land Parcels
- Section94 Works Program Area
- Roads

This map cannot be reproduced without the permission of Hawkesbury City Council  
Copyright © Land and Property Information 2014  
Hawkesbury City Council 2014

The scale displayed is approximate only. Hawkesbury City Council takes no responsibility for any errors or omissions. The assets shown on this map indicate the presence and general location only. Its accuracy or completeness is not guaranteed. Contours are to be used as a guide. A survey may be required for more accuracy.

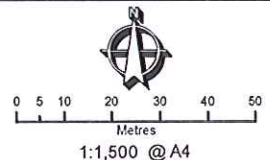





# HAWKESBURY CITY COUNCIL

PO Box 146, Windsor NSW 2756  
Website: www.hawkesbury.nsw.gov.au  
Email: council@hawkesbury.nsw.gov.au  
Hours: Monday to Friday 8.30am - 5.00pm  
Phone: 02 4560 4444

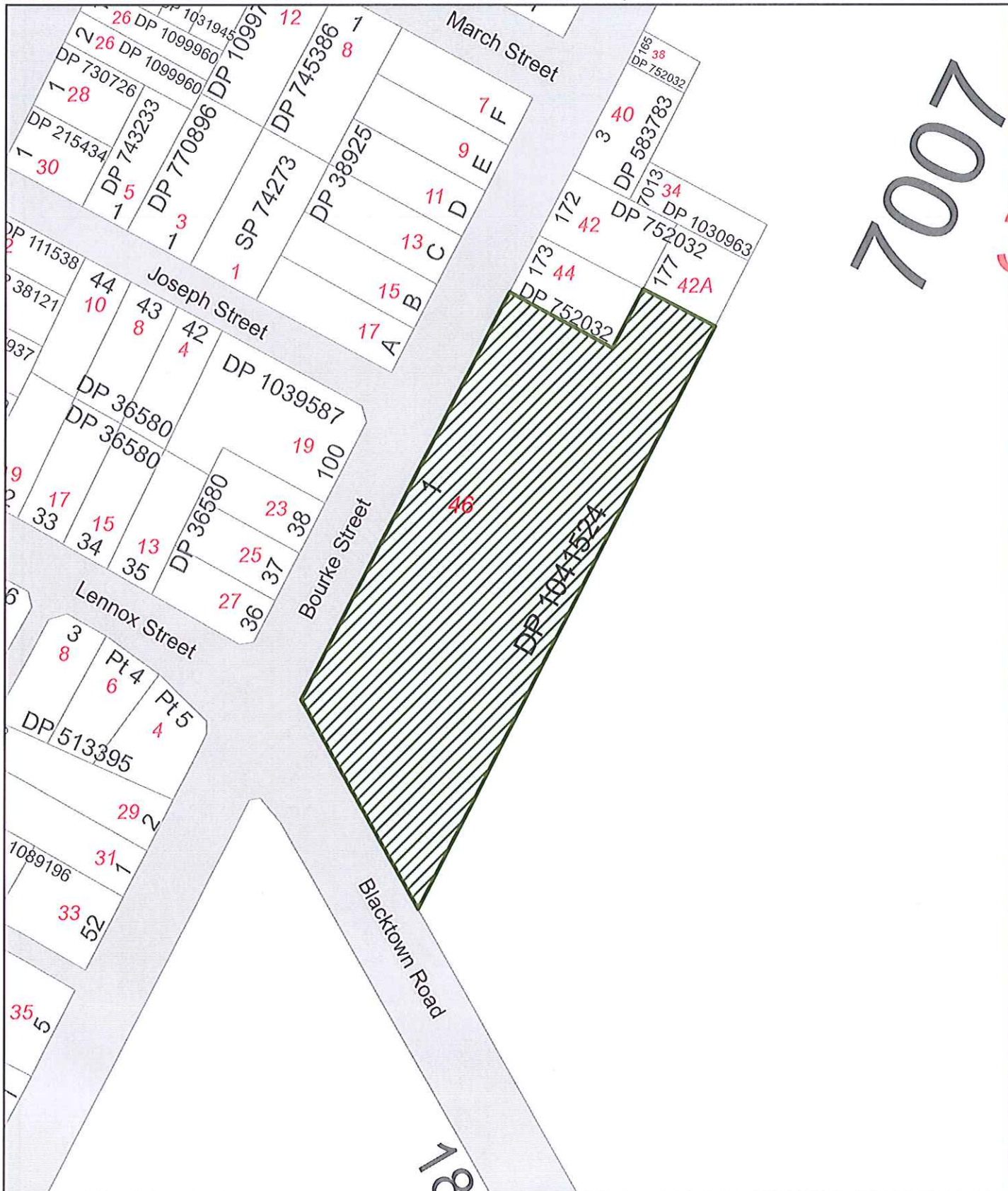

## CATCHMENT 4 - RECREATION BUILDINGS POUND PADDOCK - ACCESSIBLE AMENITIES

Date: 9/01/2015

### Legend

- Land Parcels
- Section 94 Works Program Area
- Roads

This map cannot be reproduced without the permission of Hawkesbury City Council  
Copyright © Land and Property Information 2014  
Hawkesbury City Council 2014

The scale displayed is approximate only. Hawkesbury City Council takes no responsibility for any errors or omissions. The assets shown on this map indicate the presence and general location only. Its accuracy or completeness is not guaranteed. Contours are to be used as a guide. A survey may be required for more accuracy.

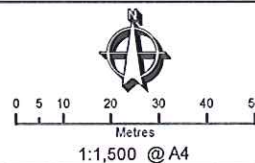





# HAWKESBURY CITY COUNCIL

PO Box 148, Windsor NSW 2756  
Website: www.hawkesbury.nsw.gov.au  
Email: council@hawkesbury.nsw.gov.au  
Hours: Monday to Friday 8.30am - 5.00pm  
Phone: 02 4560 4444

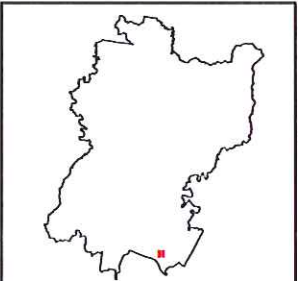
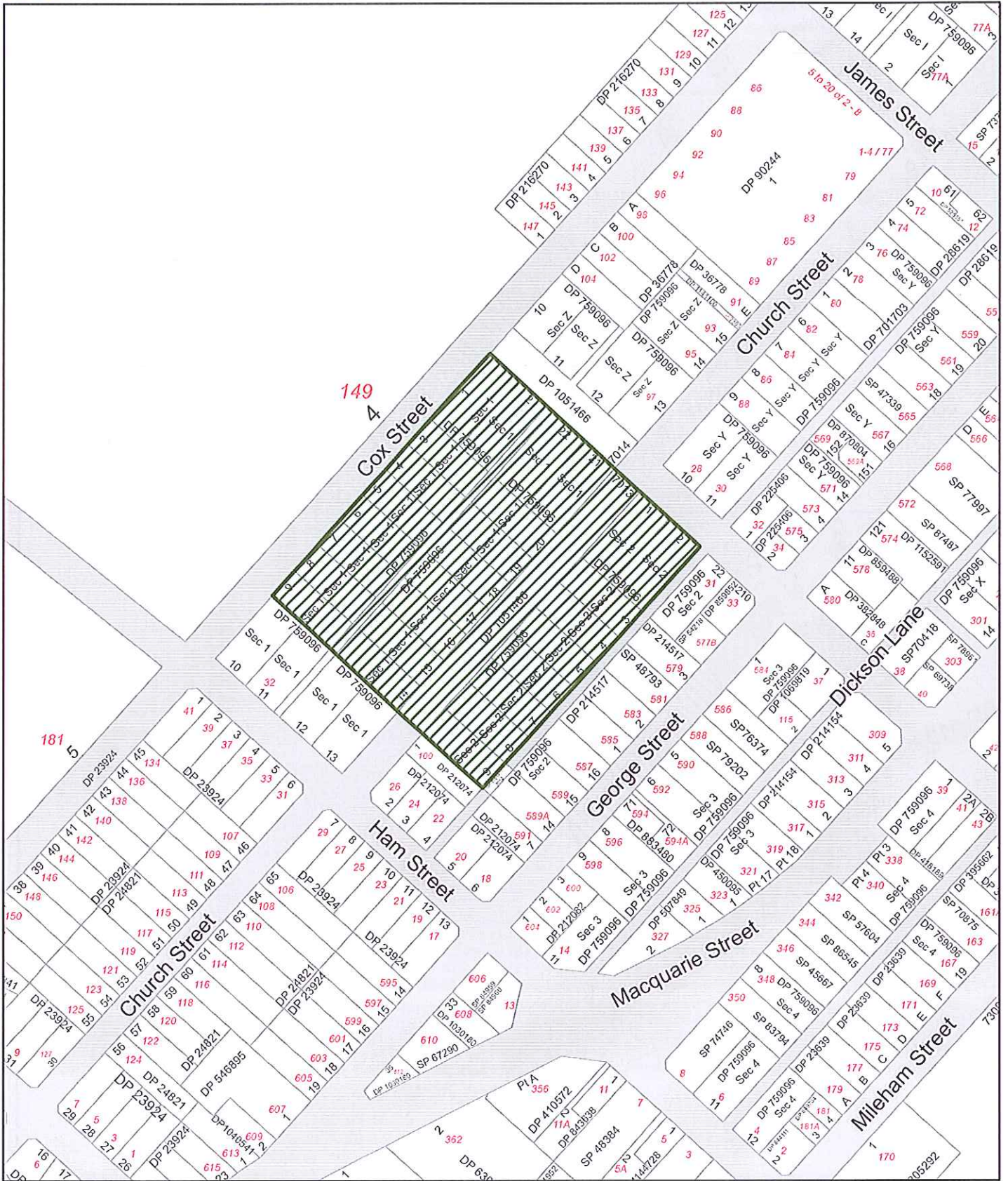

## CATCHMENT DISTRICT - RECREATION BUILDINGS OASIS CENTRE - FACILITY IMPROVEMENTS

Date: 12/01/2015

### Legend

- Land Parcels
- Section 94 Works Program Area
- Roads

This map cannot be reproduced without the permission of Hawkesbury City Council  
Copyright © Land and Property Information 2014  
Hawkesbury City Council 2014

The scale displayed is approximate only. Hawkesbury City Council takes no responsibility for any errors or omissions. The assets shown on this map indicate the presence and general location only. Its accuracy or completeness is not guaranteed. Contours are to be used as a guide. A survey may be required for more accuracy.

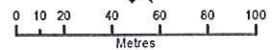

1:3,000 @ A4



### 3. Park improvements









# HAWKESBURY CITY COUNCIL

PO Box 146, Windsor NSW 2756  
Website: www.hawkesbury.nsw.gov.au  
Email: council@hawkesbury.nsw.gov.au  
Hours: Monday to Friday 8.30am - 5.00pm  
Phone: 02 4580 4444

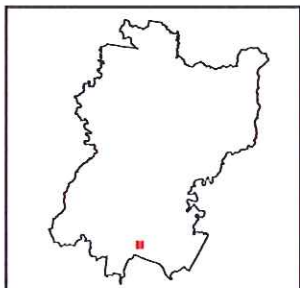
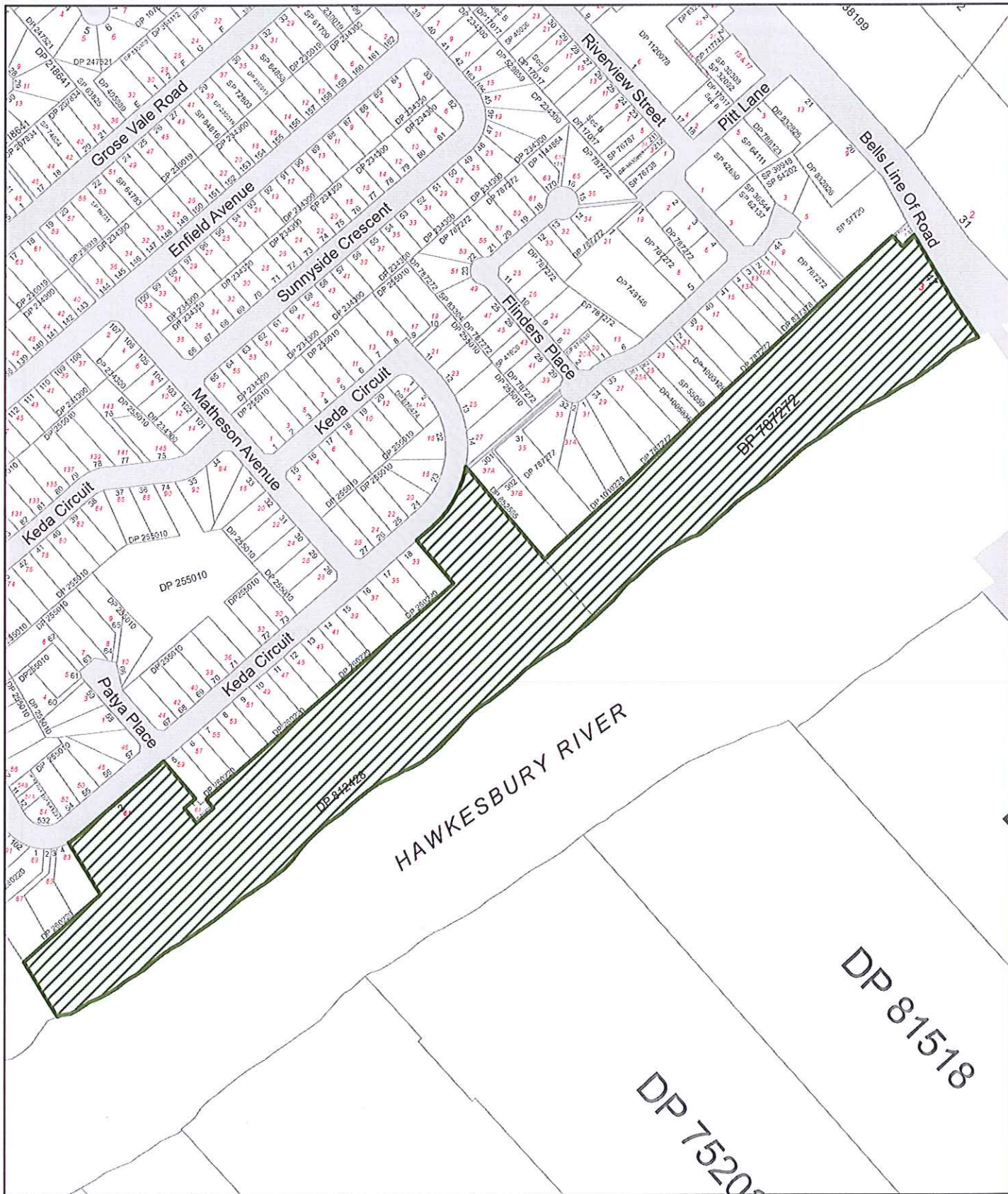

## CATCHMENT 1 - PARK IMPROVEMENTS HAWKESBURY PARK - PARK IMPROVEMENTS

Date: 9/01/2015

### Legend

- Land Parcels
- Section94 Works Program Area
- Roads

This map cannot be reproduced without the permission of Hawkesbury City Council  
Copyright © Land and Property Information 2014  
Hawkesbury City Council 2014

The scale displayed is approximate only. Hawkesbury City Council takes no responsibility for any errors or omissions. The assets shown on this map indicate the presence and general location only. Its accuracy or completeness is not guaranteed. Contours are to be used as a guide. A survey may be required for more accuracy.

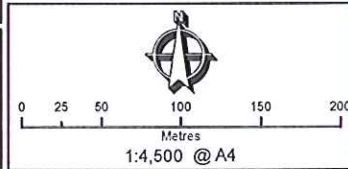





# HAWKESBURY CITY COUNCIL

PO Box 148, Windsor NSW 2756  
Website: www.hawkesbury.nsw.gov.au  
Email: council@hawkesbury.nsw.gov.au  
Hours: Monday to Friday 8.30am - 5.00pm  
Phone: 02 4560 4444

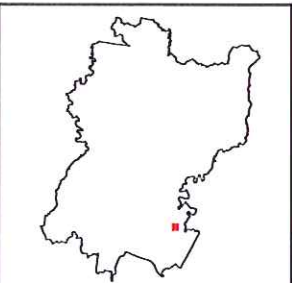
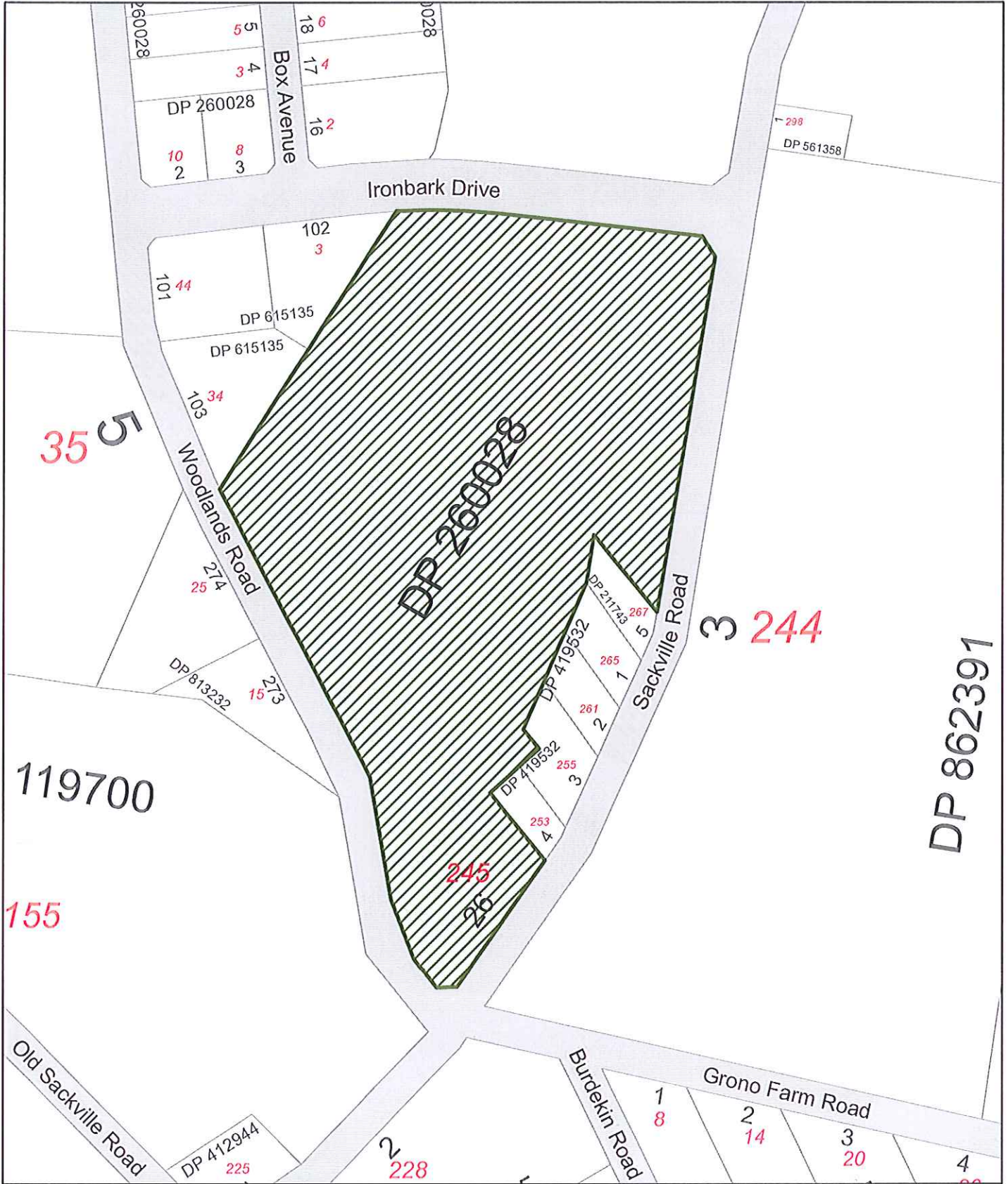

## CATCHMENT 2 - PARK IMPROVEMENTS WOODLANDS PARK - PARK IMPROVEMENTS

Date: 9/01/2015

- Legend**
- Land Parcels
  - Section94 Works Program Area
  - Roads

This map cannot be reproduced without the permission of Hawkesbury City Council  
Copyright © Land and Property Information 2014  
Hawkesbury City Council 2014  
The scale displayed is approximate only. Hawkesbury City Council takes no responsibility for any errors or omissions. The assets shown on this map indicate the presence and general location only. Its accuracy or completeness is not guaranteed. Contours are to be used as a guide. A survey may be required for more accuracy.

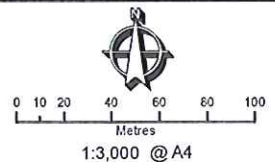









# HAWKESBURY CITY COUNCIL

PO Box 146, Windsor NSW 2756  
Website: www.hawkesbury.nsw.gov.au  
Email: council@hawkesbury.nsw.gov.au  
Hours: Monday to Friday 8.30am - 5.00pm  
Phone: 02 4560 4444

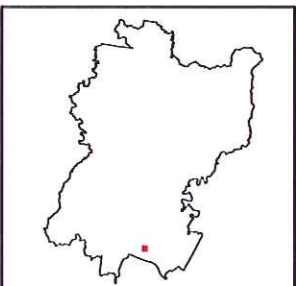
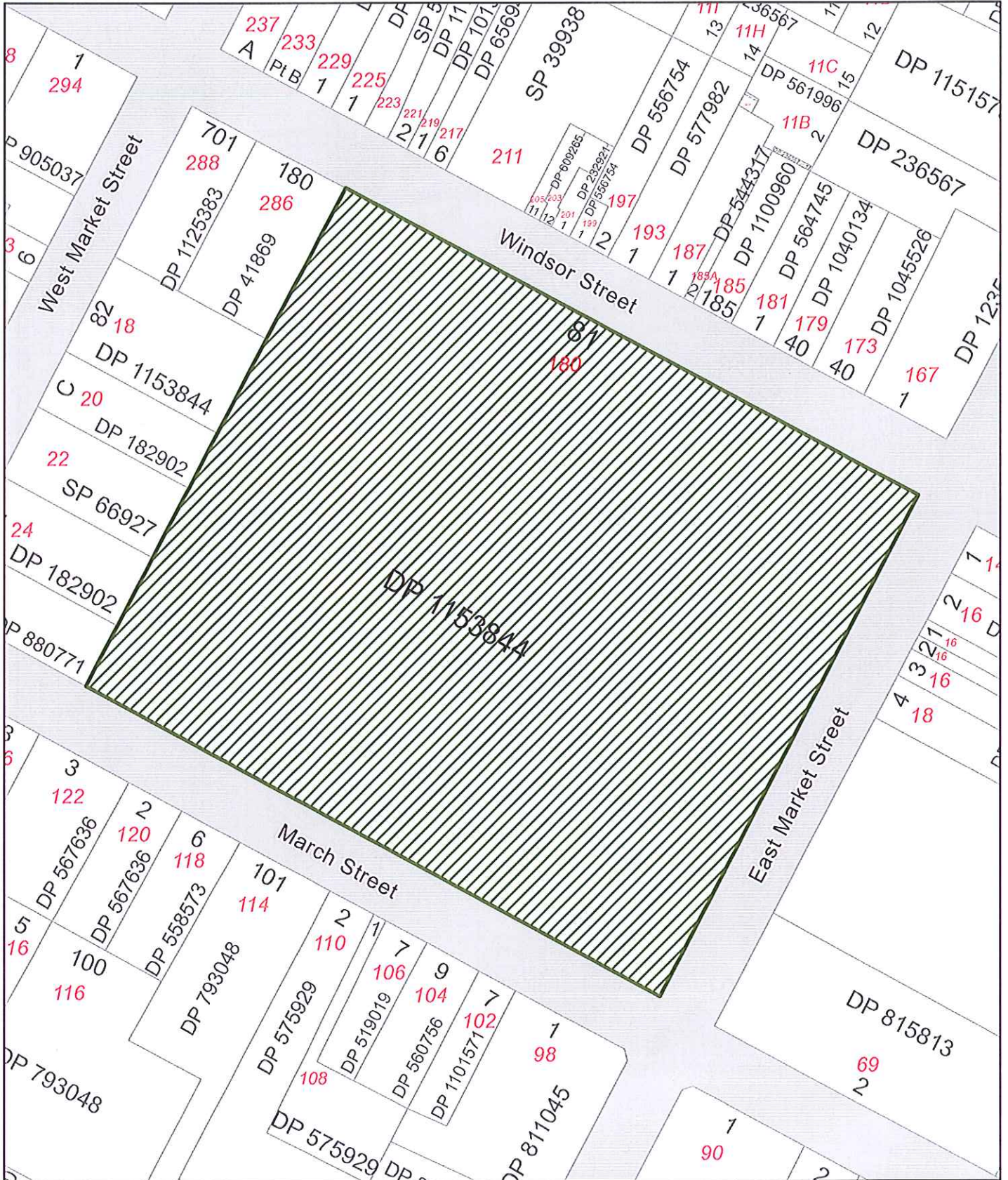

## CATCHMENT 4 - PARK IMPROVEMENTS RICHMOND PARK LANDSCAPING

Date: 9/01/2015

### Legend

- Land Parcels
- Section 94 Works Program Area
- Roads

This map cannot be reproduced without the permission of Hawkesbury City Council  
Copyright © Land and Property Information 2014  
Hawkesbury City Council 2014

The scale displayed is approximate only. Hawkesbury City Council takes no responsibility for any errors or omissions. The assets shown on this map indicate the presence and general location only. Its accuracy or completeness is not guaranteed. Contours are to be used as a guide. A survey may be required for more accuracy.

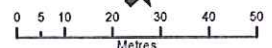

1:1,500 @ A4





# HAWKESBURY CITY COUNCIL

PO Box 146, Windsor NSW 2756  
Website: [www.hawkesbury.nsw.gov.au](http://www.hawkesbury.nsw.gov.au)  
Email: [council@hawkesbury.nsw.gov.au](mailto:council@hawkesbury.nsw.gov.au)  
Hours: Monday to Friday 8.30am - 5.00pm  
Phone: 02 4560 4444

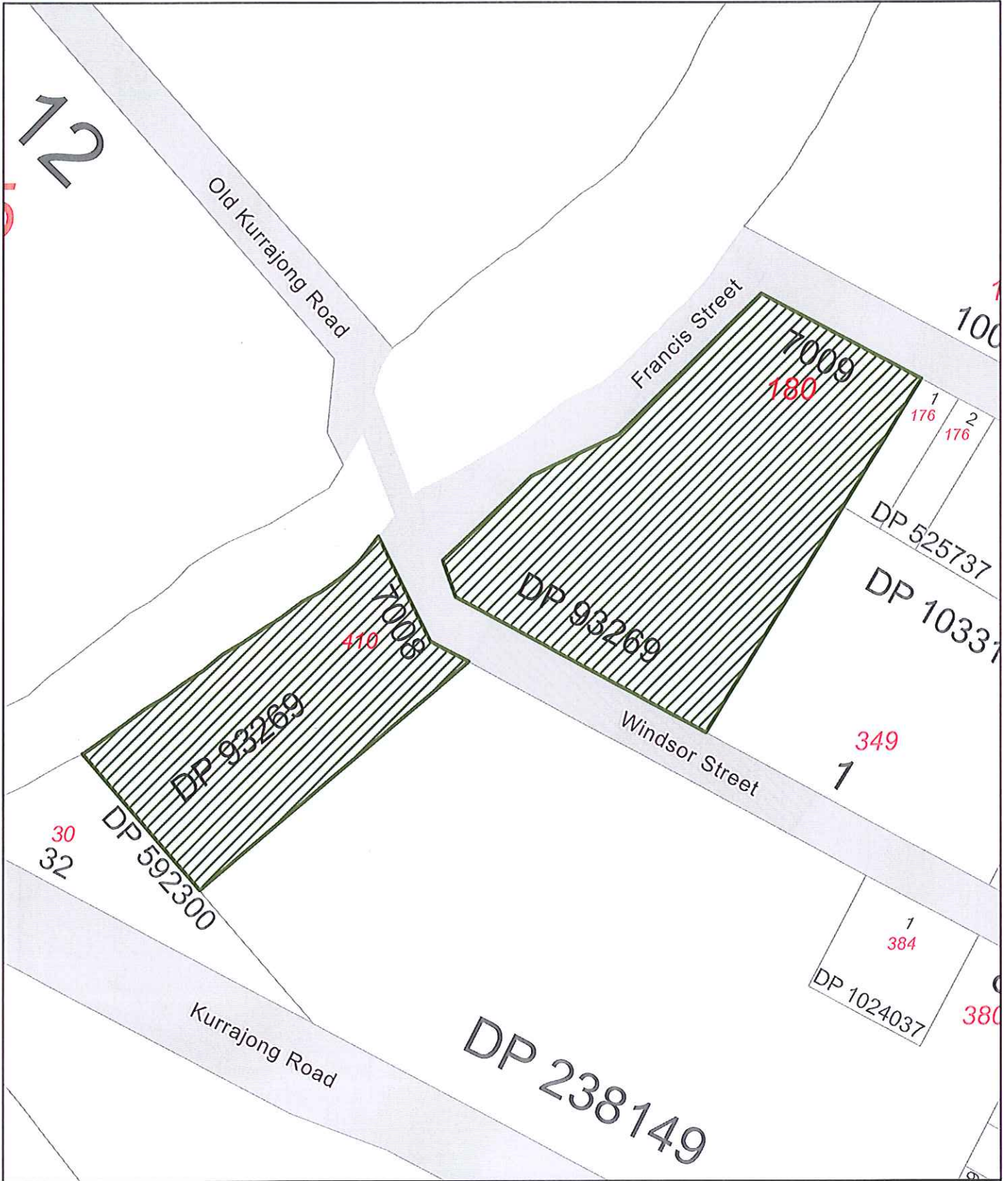

## CATCHMENT DISTRICT - RECREATION BUILDINGS SMITH PARK FACILITIES & IMPROVEMENTS

Date: 9/01/2015

### Legend

- Land Parcels
- Section 94 Works Program Area
- Roads

This map cannot be reproduced without the permission of Hawkesbury City Council  
 Copyright © Land and Property Information 2014  
 Hawkesbury City Council 2014  
 The scale displayed is approximate only. Hawkesbury City Council takes no responsibility for any errors or omissions. The assets shown on this map indicate the presence and general location only. Its accuracy or completeness is not guaranteed. Contours are to be used as a guide. A survey may be required for more accuracy.

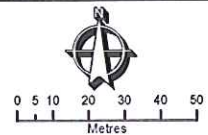

1:2,000 @ A4





# HAWKESBURY CITY COUNCIL

PO Box 146, Windsor NSW 2766  
Website: www.hawkesbury.nsw.gov.au  
Email: council@hawkesbury.nsw.gov.au  
Hours: Monday to Friday 8.30am - 5.00pm  
Phone: 02 4580 4444

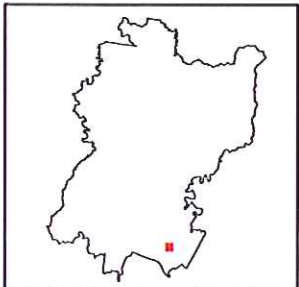
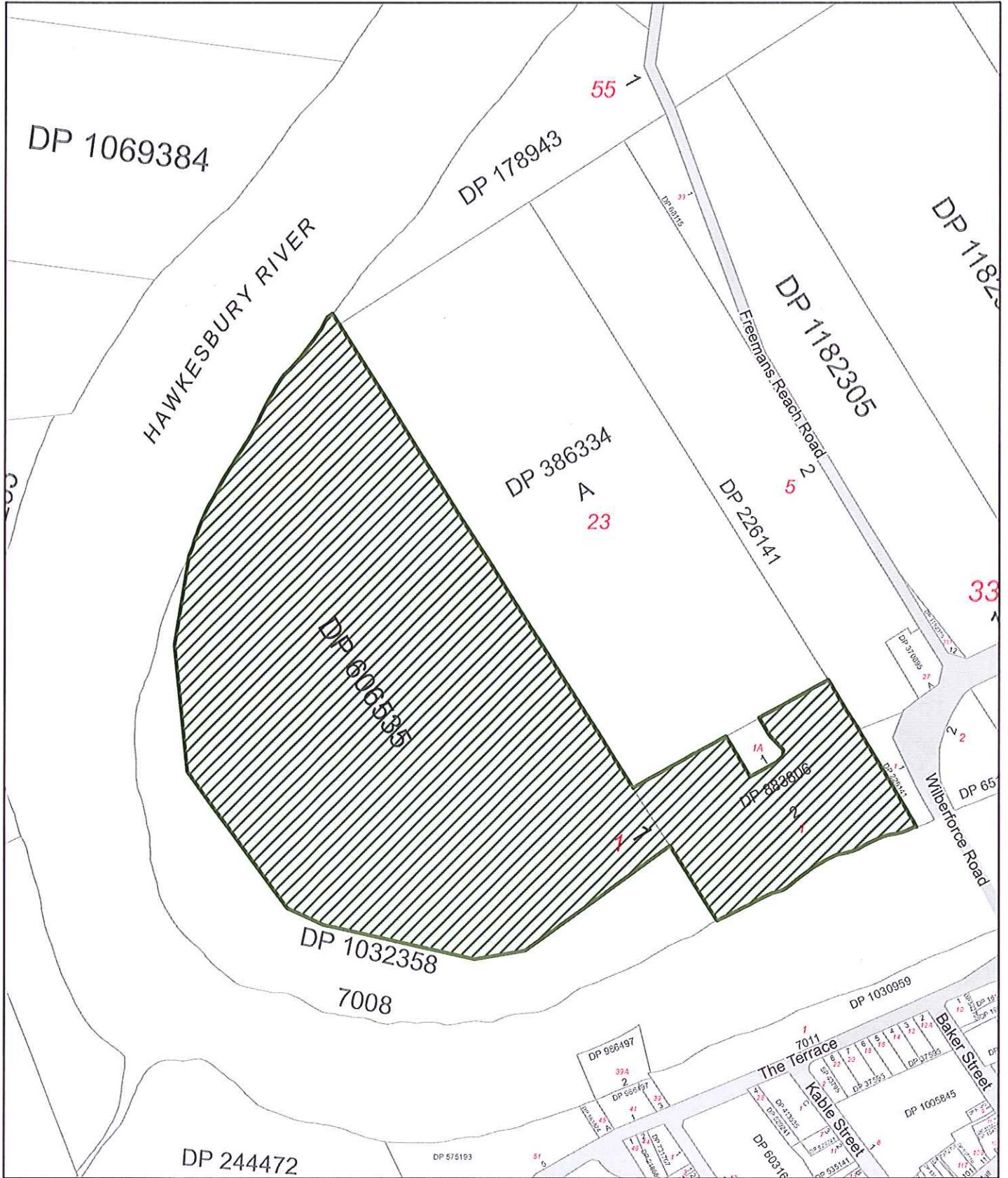

**CATCHMENT DISTRICT - PARK IMPROVEMENTS**  
**MACQUARIE PARK - PARK IMPROVEMENTS**

Date: 9/01/2015

**Legend**

- Land Parcels
- Section94 Works Program Area
- Roads

This map cannot be reproduced without the permission of Hawkesbury City Council  
 Copyright © Land and Property Information 2014  
 Hawkesbury City Council 2014

The scale displayed is approximate only. Hawkesbury City Council takes no responsibility for any errors or omissions. The assets shown on this map indicate the presence and general location only. Its accuracy or completeness is not guaranteed. Contours are to be used as a guide. A survey may be required for more accuracy.

0 25 50 100 150 200  
 Metres  
 1:4,500 @ A4





# HAWKESBURY CITY COUNCIL

PO Box 146, Windsor NSW 2756  
Website: www.hawkesbury.nsw.gov.au  
Email: council@hawkesbury.nsw.gov.au  
Hours: Monday to Friday 8:30am - 5:00pm  
Phone: 02 4580 4444

P 884408

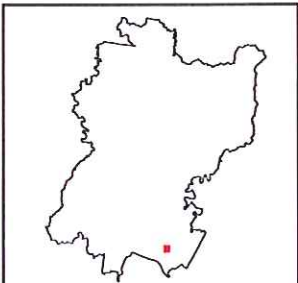
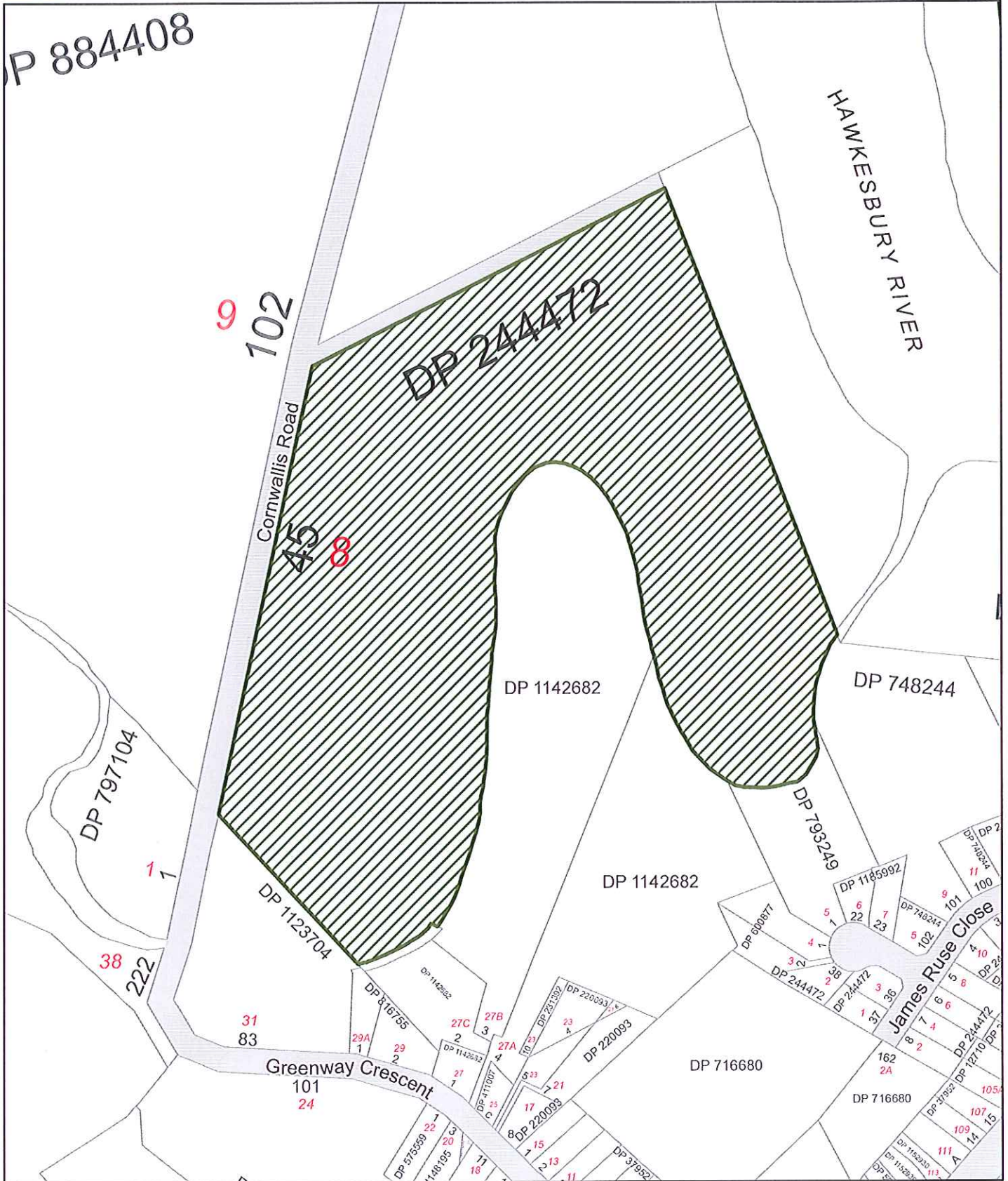

## CATCHMENT DISTRICT - PARK IMPROVEMENTS DEERUBBIN PARK - PARK IMPROVEMENTS

Date: 9/01/2015

### Legend

- Land Parcels
- Section 94 Works Program Area
- Roads

This map cannot be reproduced without the permission of Hawkesbury City Council  
Copyright © Land and Property Information 2014  
Hawkesbury City Council 2014  
The scale displayed is approximate only. Hawkesbury City Council takes no responsibility for any errors or omissions. The assets shown on this map indicate the presence and general location only. Its accuracy or completeness is not guaranteed. Contours are to be used as a guide. A survey may be required for more accuracy.

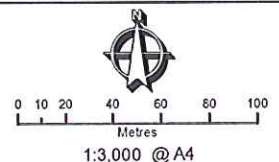



## 4. Car parks





# HAWKESBURY CITY COUNCIL

PO Box 146, Windsor NSW 2756  
 Website: www.hawkesbury.nsw.gov.au  
 Email: council@hawkesbury.nsw.gov.au  
 Hours: Monday to Friday 8.30am - 5.00pm  
 Phone: 02 4580 4444

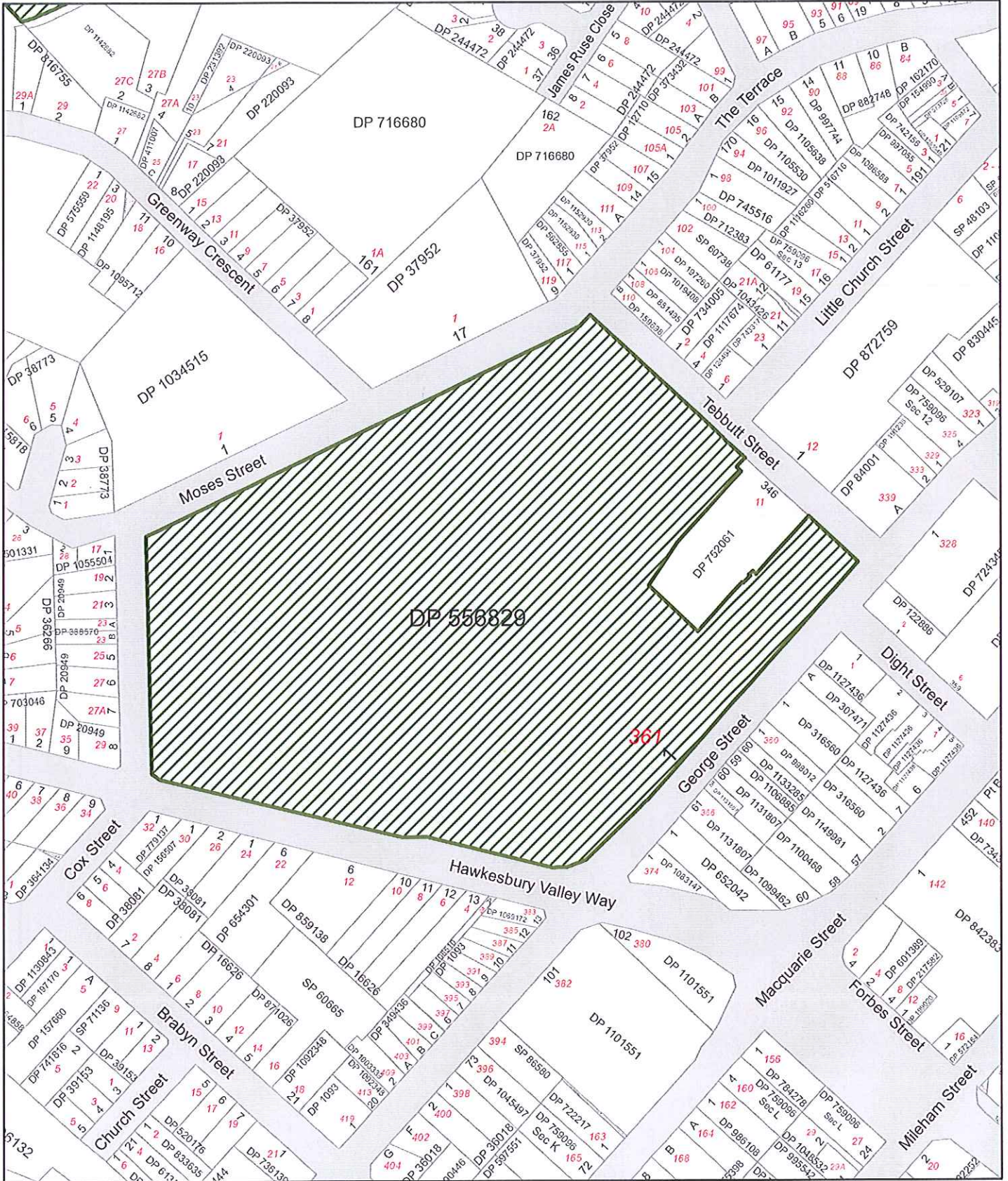

**CATCHMENT WINDSOR - CAR PARK CONSTRUCTION  
 MCQUADE PARK**

Date: 9/01/2015

**Legend**

- Land Parcels
- Section 94 Works Program Area
- Roads

This map cannot be reproduced without the permission of Hawkesbury City Council  
 Copyright © Land and Property Information 2014  
 Hawkesbury City Council 2014  
 The scale displayed is approximate only. Hawkesbury City Council takes no responsibility for any errors or omissions. The assets shown on this map indicate the presence and general location only. Its accuracy or completeness is not guaranteed. Contours are to be used as a guide. A survey may be required for more accuracy.

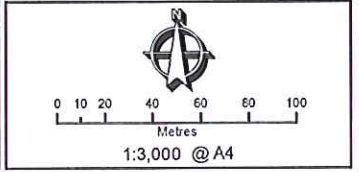





# HAWKESBURY CITY COUNCIL

PO Box 146, Windsor NSW 2766  
Website: www.hawkesbury.nsw.gov.au  
Email: council@hawkesbury.nsw.gov.au  
Hours: Monday to Friday 8.30am - 5.00pm  
Phone: 02 4580 4444

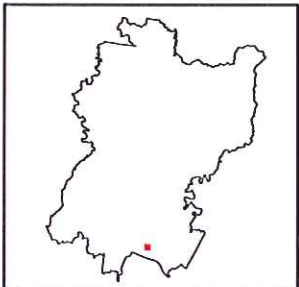
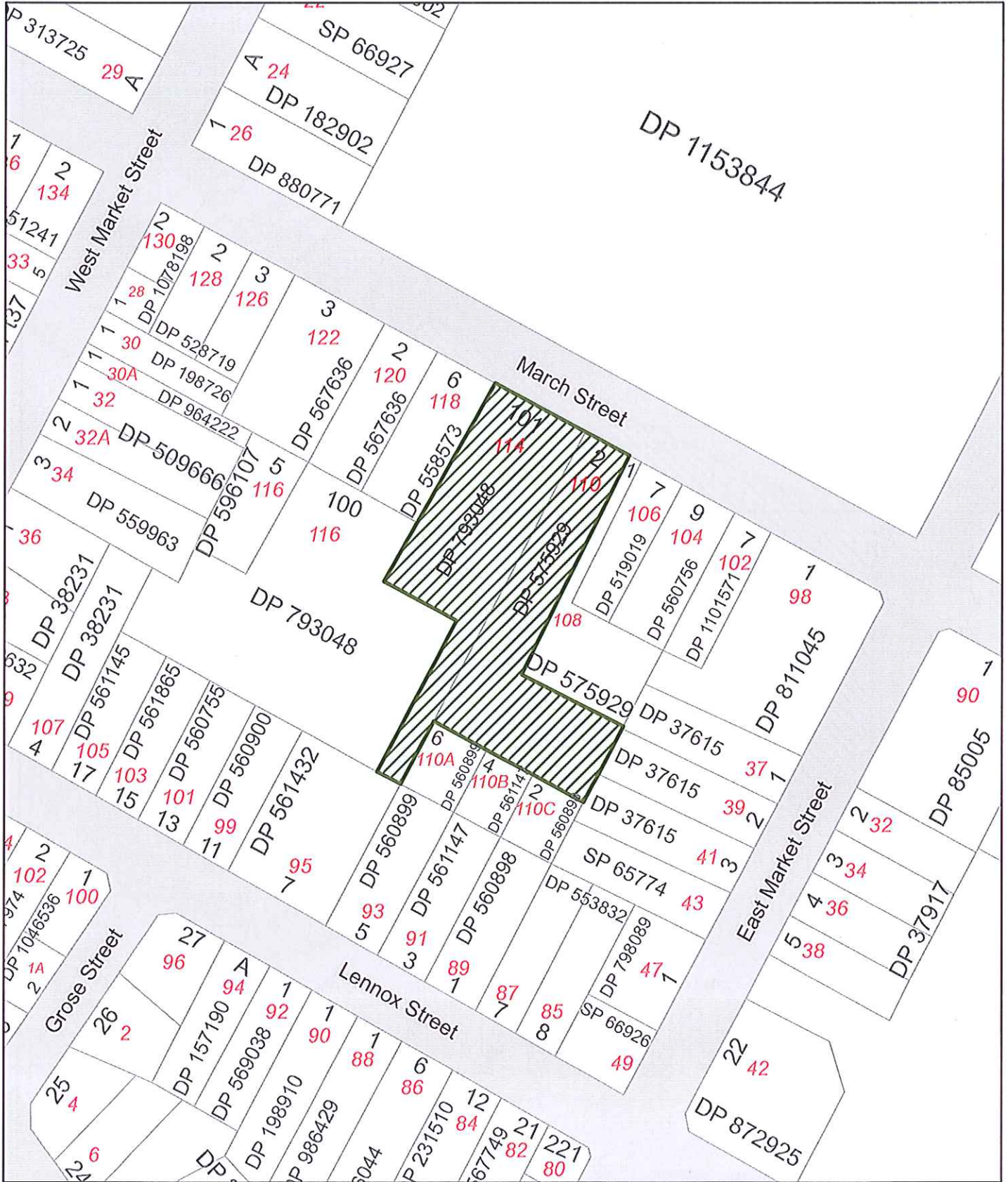

## CATCHMENT RICHMOND - CAR PARK CONSTRUCTION RICHMOND COMMUNITY PRECINCT

Date: 9/01/2015

Legend		
	Land Parcels	
	Section 94 Works Program Area	
	Roads	

This map cannot be reproduced without the permission of Hawkesbury City Council.  
Copyright © Land and Property Information 2014  
Hawkesbury City Council 2014  
The scale displayed is approximate only. Hawkesbury City Council takes no responsibility for any errors or omissions. The assets shown on this map indicate the presence and general location only. Its accuracy or completeness is not guaranteed. Contours are to be used as a guide. A survey may be required for more accuracy.

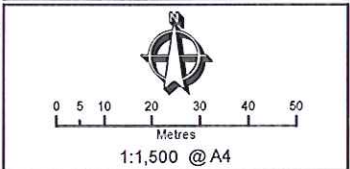









# HAWKESBURY CITY COUNCIL

PO Box 146, Windsor NSW 2756  
Website: [www.hawkesbury.nsw.gov.au](http://www.hawkesbury.nsw.gov.au)  
Email: [council@hawkesbury.nsw.gov.au](mailto:council@hawkesbury.nsw.gov.au)  
Hours: Monday to Friday 8.30am - 5.00pm  
Phone: 02 4580 4444

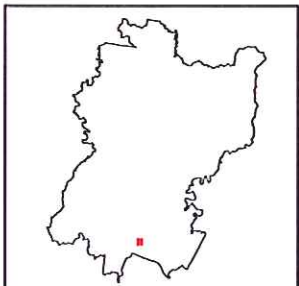
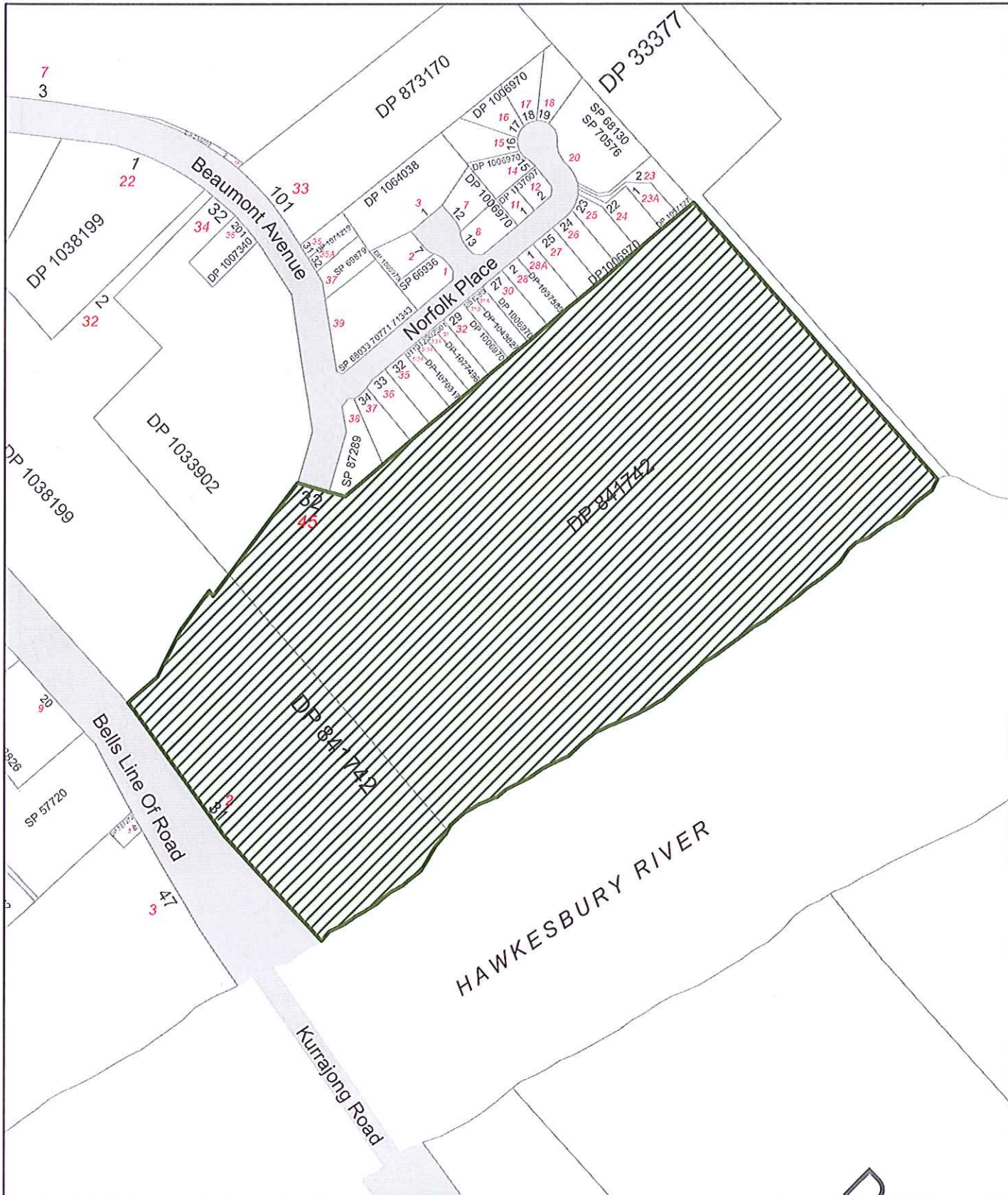

## CATCHMENT RICHMOND - CAR PARK CONSTRUCTION HANNA PARK

Date: 9/01/2015

- Legend**
- Land Parcels
  - Section94 Works Program Area
  - Roads

This map cannot be reproduced without the permission of Hawkesbury City Council  
Copyright © Land and Property Information 2014  
Hawkesbury City Council 2014  
The scale displayed is approximate only. Hawkesbury City Council takes no responsibility for any errors or omissions. The assets shown on this map indicate the presence and general location only. Its accuracy or completeness is not guaranteed. Contours are to be used as a guide. A survey may be required for more accuracy.

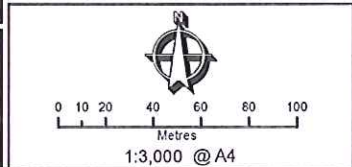



## 5. Road maintenance





# HAWKESBURY CITY COUNCIL

PO Box 146, Windsor NSW 2756  
Website: [www.hawkesbury.nsw.gov.au](http://www.hawkesbury.nsw.gov.au)  
Email: [council@hawkesbury.nsw.gov.au](mailto:council@hawkesbury.nsw.gov.au)  
Hours: Monday to Friday 8.30am - 5.00pm  
Phone: 02 4550 4444



## CATCHMENT STH WINDSOR - ROAD MAINTENANCE ROAD MAINTENANCE - VARIOUS ROADS

Date: 12/01/2015

### Legend

- Land Parcels
- Section94 Works Program Area
- Roads

This map cannot be reproduced without the permission of Hawkesbury City Council  
Copyright © Land and Property Information 2014  
Hawkesbury City Council 2014

The scale displayed is approximate only. Hawkesbury City Council takes no responsibility for any errors or omissions. The assets shown on this map indicate the presence and general location only. Its accuracy or completeness is not guaranteed. Contours are to be used as a guide. A survey may be required for more accuracy.



0 50 100 200 300  
Metres

1:18,000 @ A4





# HAWKESBURY CITY COUNCIL

PO Box 146, Windsor NSW 2756  
Website: www.hawkesbury.nsw.gov.au  
Email: council@hawkesbury.nsw.gov.au  
Hours: Monday to Friday 8.30am - 5.00pm  
Phone: 02 4560 4444

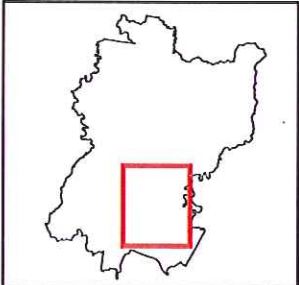
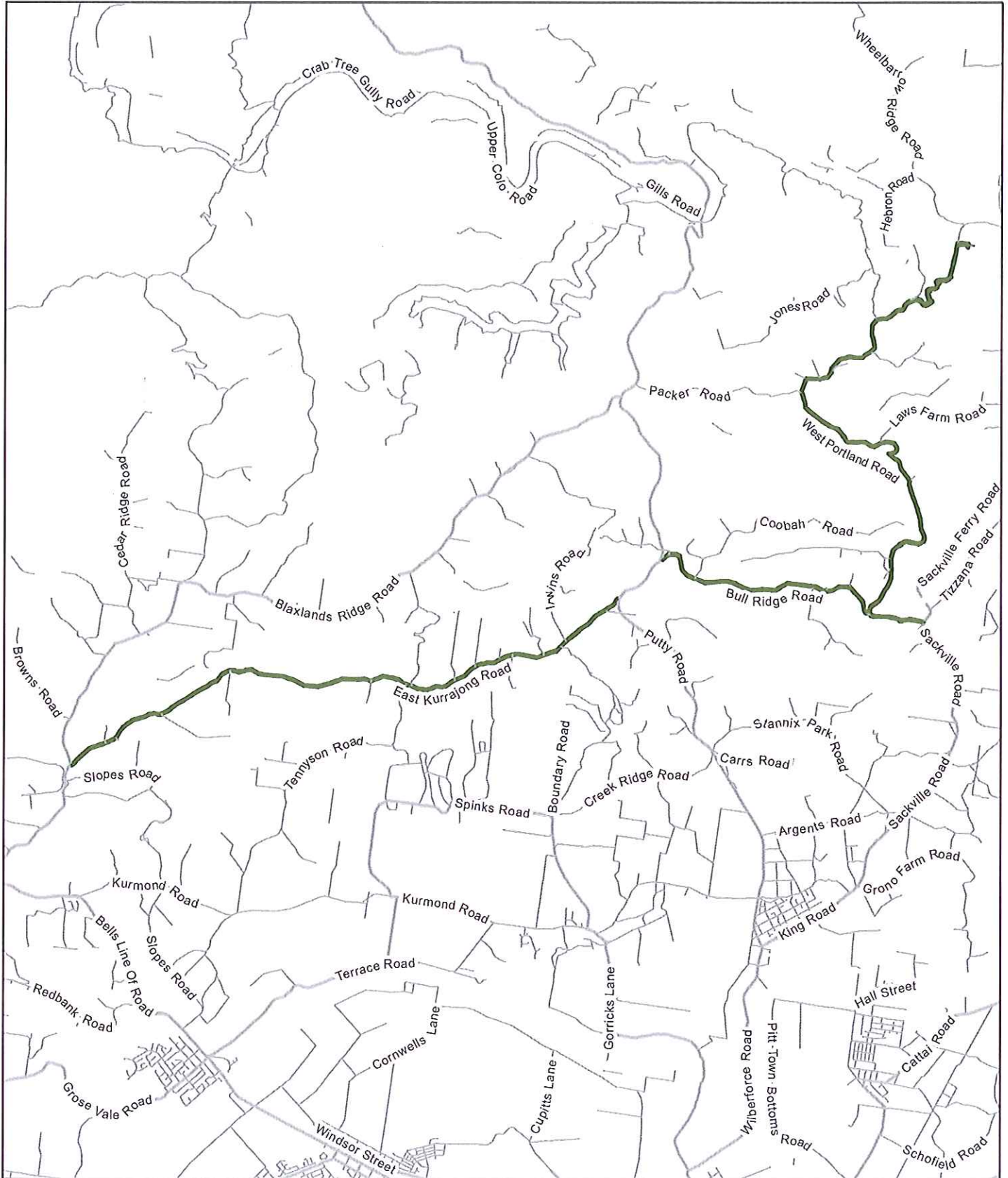

## CATCHMENT EAST KURRAJONG - ROAD MAINTENANCE ROAD MAINTENANCE - VARIOUS ROADS

Date: 12/01/2015

**Legend**

- Section 94 Works Program Area
- Roads

This map cannot be reproduced without the permission of Hawkesbury City Council  
Copyright © Land and Property Information 2014  
Hawkesbury City Council 2014  
The scale displayed is approximate only. Hawkesbury City Council takes no responsibility for any errors or omissions. The assets shown on this map indicate the presence and general location only. Its accuracy or completeness is not guaranteed. Contours are to be used as a guide. A survey may be required for more accuracy.





## APPENDIX C



## **Justification of any alternative to paying the Roads Maintenance Contribution**

### **Transport Study Requirements**

1. Identify the route over which haulage is proposed.
2. Identify the type and number of vehicles used to haul material.
3. An engineering assessment of the road condition and alignment over the entire length that haulage is proposed, including:
  - a. existing pavement condition, and seal widths
  - b. existing shoulder conditions
  - c. existing pavement composition and structural capacity
  - d. existing alignment, specifically detailing those areas which fail to meet current standards
  - e. the number of overtaking opportunities and climbing lanes and the impact that increased truck traffic will have on existing travel times and accident rates
  - f. an analysis in accordance with AUSTROADS principles of the existing road length showing current levels of service, and any assumptions made in their calculation.
4. The impact that road haulage will have on the existing road condition, including:
  - a. the expected rate of pavement deterioration over each year that haulage is proposed, assessed in conjunction with the expected number of heavy vehicle movements (expressed as Equivalent Standard Axles)
  - b. the reduction in pavement life which may be expected from the haulage
  - c. the cost to the community to repair the pavement damage resulting from the haulage, and to maintain the pavement in an acceptable condition
  - d. the cost to the community of the reduced pavement life resulting from the haulage.



